

RECEIVED

FEB 10 1986

WATER RESOURCES DEPT
SALEM, OREGON

EXHIBIT "A"
SKETCH MAP

SHOWING EXISTING RESERVOIR
AND PROPOSED NEW RESERVOIR
LYING IN THE NE 1/4, SECTION 22,
T. 41 S., R. 13 W., W.M., CURRY COUNTY,
OREGON.

Application No. R-68671 & 68672

Permit No. R10813

NOTE:

CENTER OF RESERVOIR IS 450' SOUTH &
400' WEST OF THE NE COR. OF SECTION 22,
T. 41 S., R. 13 W., W.M.
(PROPOSED RESERVOIR)

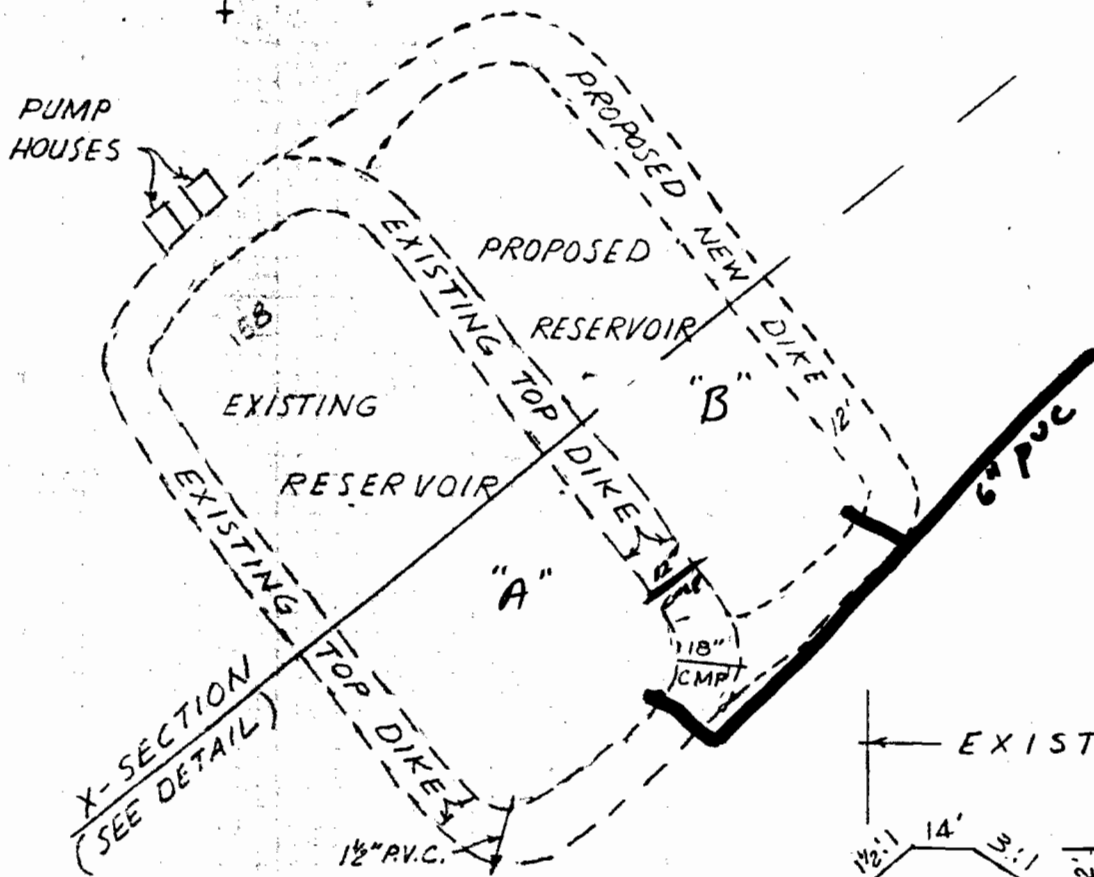
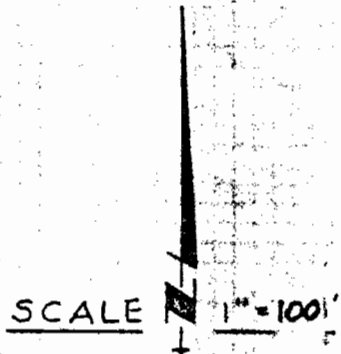

DETAIL X-SECTION

SCALE 1"=100'

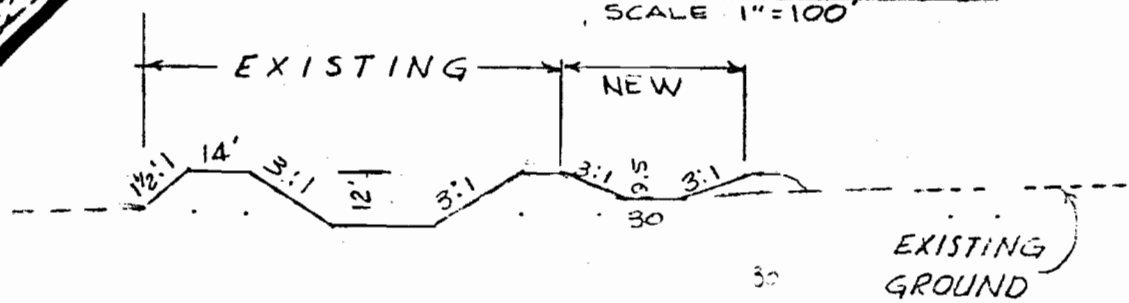

RECEIVED
 AUG 11 1986
 WATER RESOURCES DEPT
 SALEM, OREGON

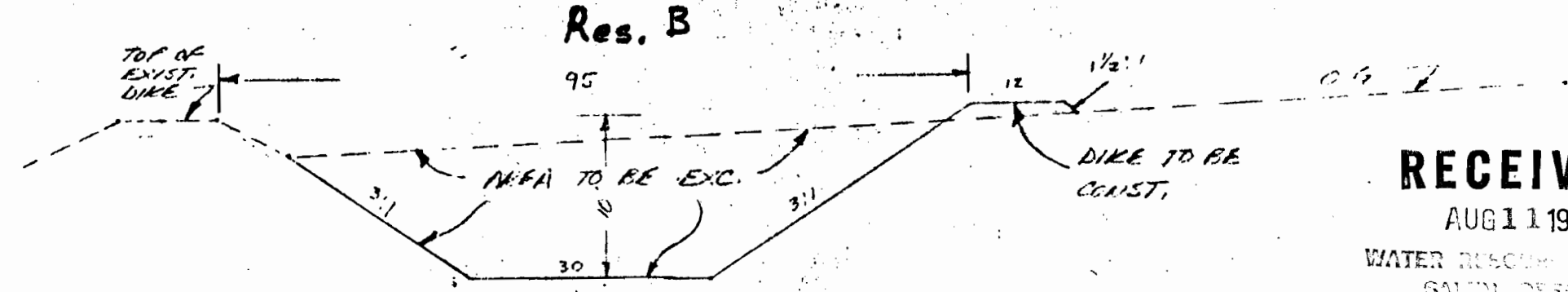
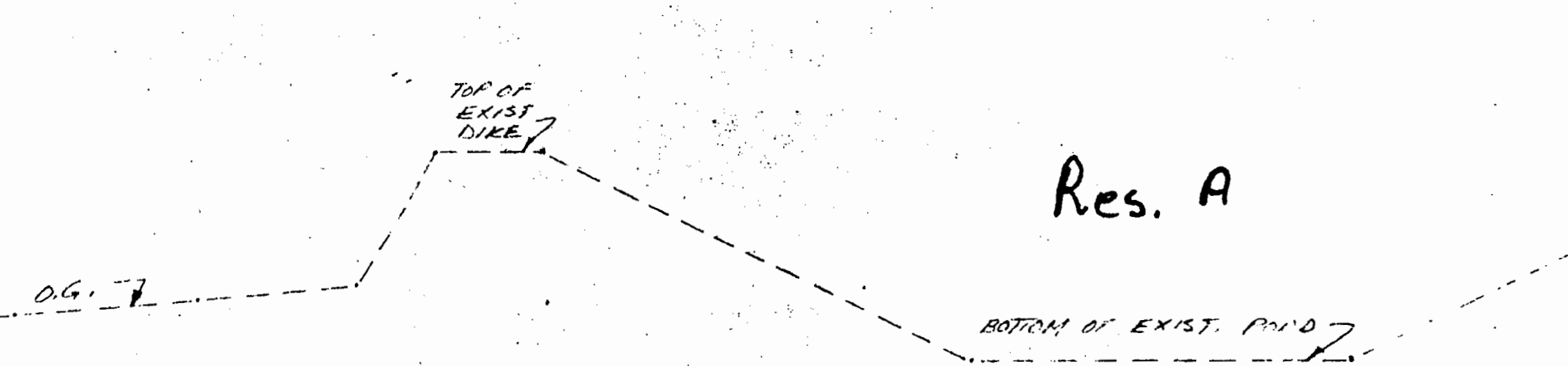

SECTION A-A
 HORIZ. 1" = 20'
 VERT. 1" = 10'

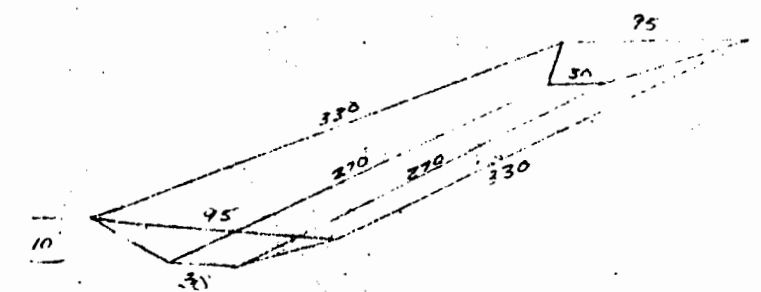

Application No. R 68621
 Permit No. R10813

EST. VOL. OF NEW POND

$$\left(\frac{95+30}{2} \times 10\right) \left(\frac{330+230}{2}\right) = 187,500 \text{ cu ft}$$

$$187,500 \times 7.48 = 1,402,500 \text{ GAL MAX.}$$

QUANTITY EST.
 REMOVE TOP SOIL FROM RES. SITE AND STOCKPILE AT SITE PROVIDED BY OWNER.
 AVG. DEPTH 2 FT.

$$\frac{115 \times 380 \times 2}{27} = 3237 \text{ C.Y.}$$

 POND EXC.

$$\frac{55 \times 200 \times 7}{27} = 2858 \text{ C.Y.}$$

 EMB. IN DIKE

$$\frac{200 \times 5 \times 20}{27} = 740 \text{ C.Y.}$$

$$\frac{340 \times 2 \times 14}{27} = 353 \text{ C.Y.}$$

$$1093 \text{ C.Y.} \times 25\% = 273 \text{ C.Y.}$$

MASS = 1500 C.Y. TO BE PLACED ON SITE UNDER DIRECTION OF OWNER.

C.Y. = CUBIC YARDS

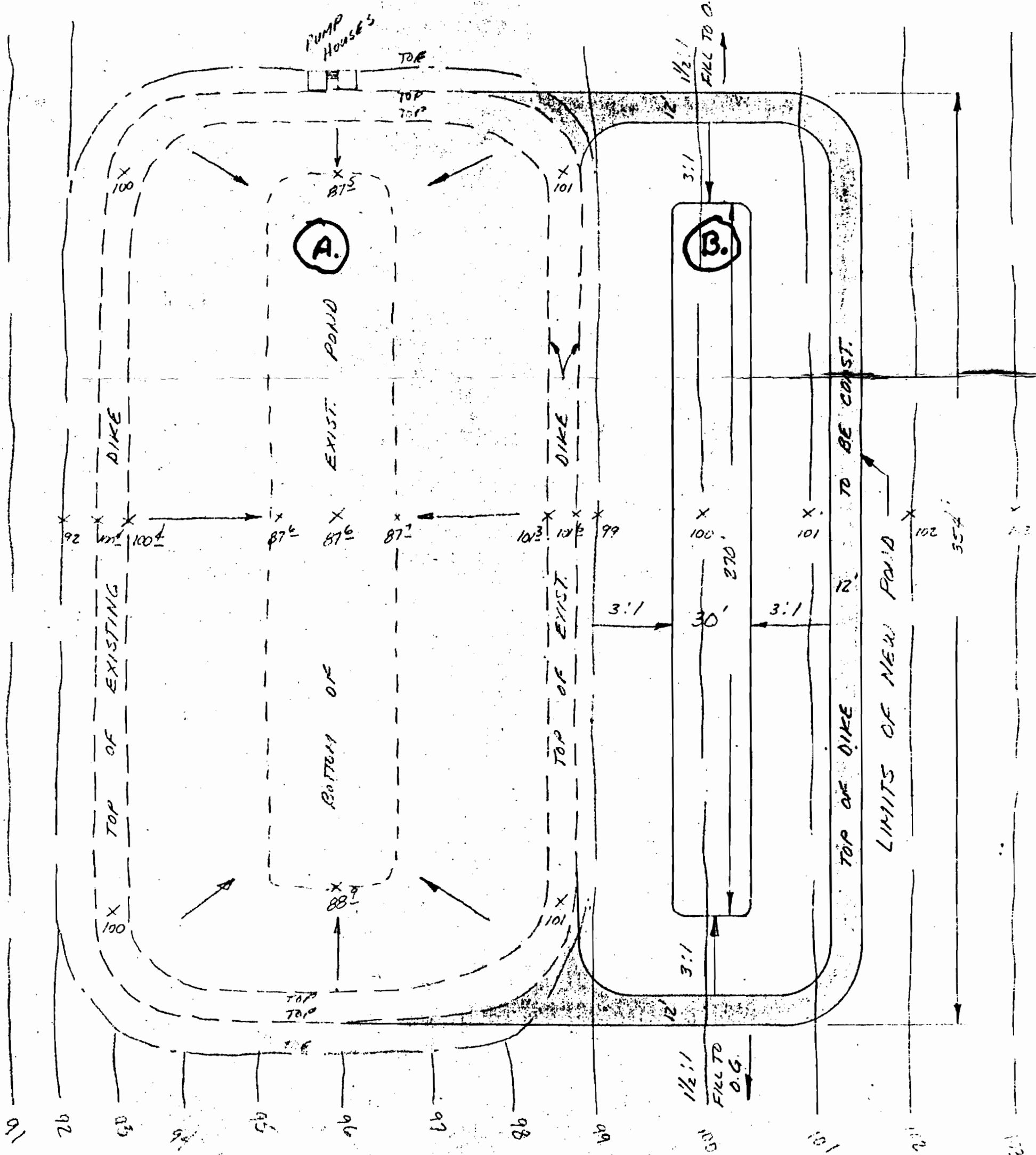

PLAN SCALE 1" = 40'

plus 1/2" (to top edge)
 W = 110'
 L = 350'
 W = 115'
 L = 275'

30 x 1.5 x 20 x 200 = 36000 gal water