

SECTION 32
SE 1/4 SE 1/4

TOWNSHIP 30 S, RANGE 32 E, W.M.

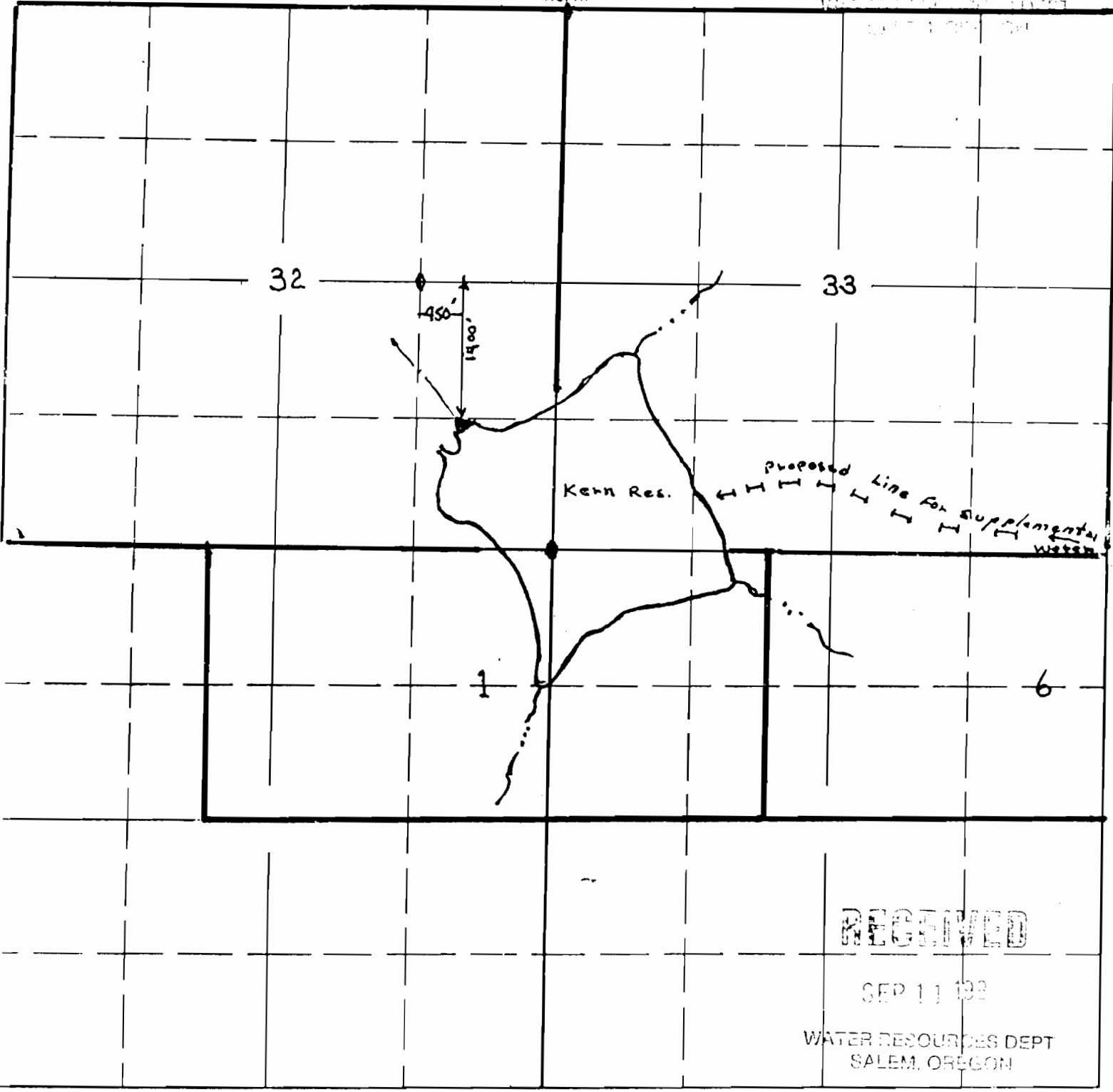

RECEIVED

SEP 11 1988

WATER RESOURCES DEPT
SALEM, OREGON

LOCATION: W.M. Oregon, Harney
County.
SW 1/4 SE 1/4 NE 1/4 450' E and
1400' South

APPLICATION NO. R-69128
PERMIT NO. R11163