

RECEIVED

SEP 22 1989

WATER RESOURCES DEPT.
SALFON, OREGON

RESERVOIR APPLICATION MAP

IN THE NAME OF: BROOKSIDE INC.

S2 T2N R10E WM
INDIAN CREEK GOLF COURSE

1" = 1/4 MILE

REC - 2 1009

WATER RESOURCES DEPT.

Application No. R-70013
Permit No.

SEE SURFACE WATER APPLICATION MAP FOR
IRRIGATION AREAS.

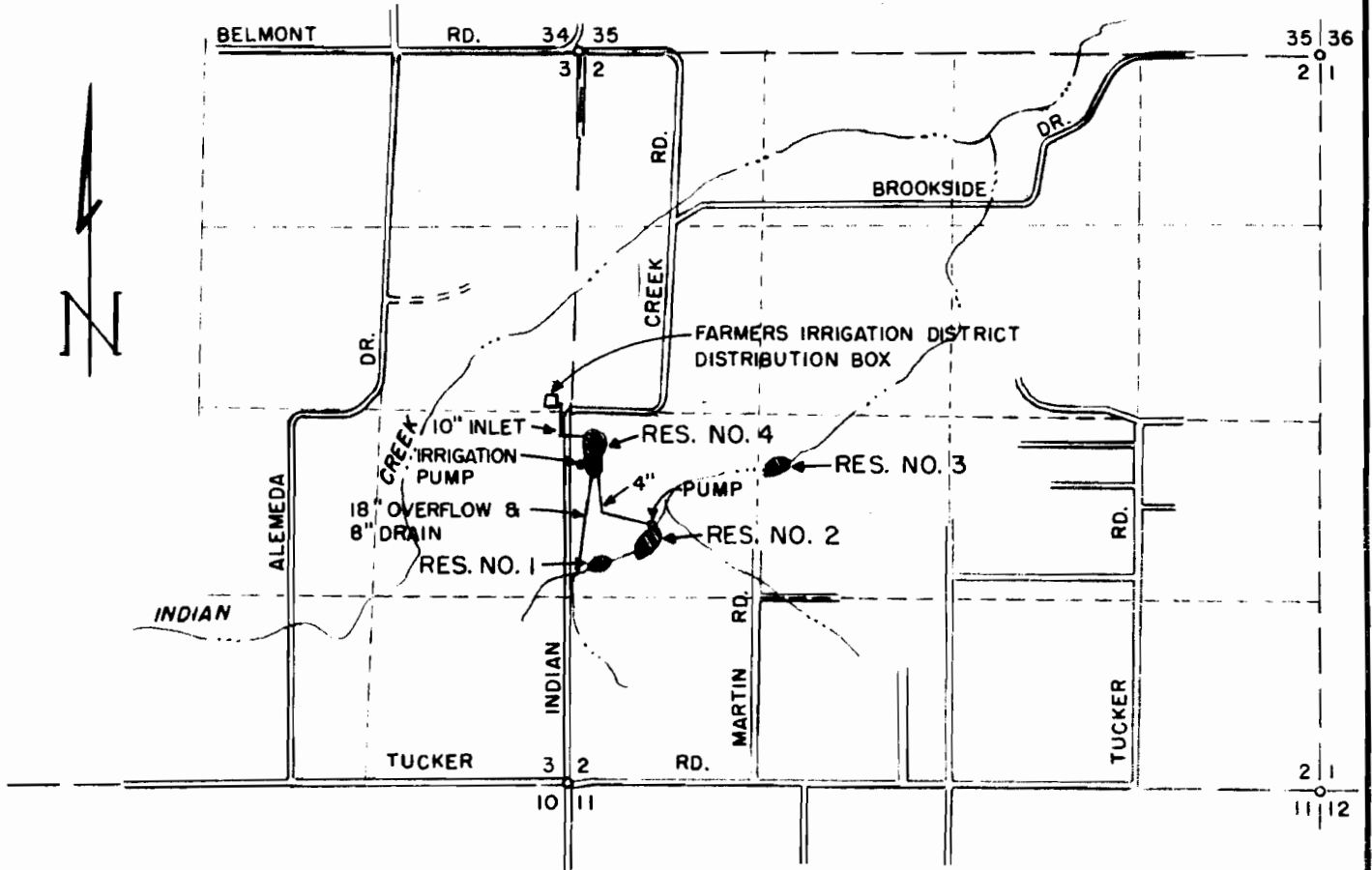

THE PURPOSE OF THIS MAP IS TO IDENTIFY THE LOCATION OF THE WATER RIGHT. IT IS NOT INTENDED TO PROVIDE INFORMATION RELATIVE TO THE LOCATION OF PROPERTY OWNERSHIP BOUNDARY LINES.

SPILLWAY LOCATIONS FROM THE SW CORNER OF SECTION 2:

- RESERVOIR NO. 1 = 1630' NORTH & 340' EAST
- RESERVOIR NO. 2 = 1820' NORTH & 650' EAST
- RESERVOIR NO. 3 = 2370' NORTH & 1520' EAST
- RESERVOIR NO. 4 = 2260' NORTH & 170' EAST

