

RECEIVED

MAR 28 1988

WATER RESOURCES DEPT.
SALEM, OREGON

APPLICATION MAP 'A'

IN THE NAME OF: KIRPAL LIGHT SATSANG / INC.
S10, T25S, R7N, WM

Application No. R-69571 & 69572
Permit No.



1" = 400 FT.

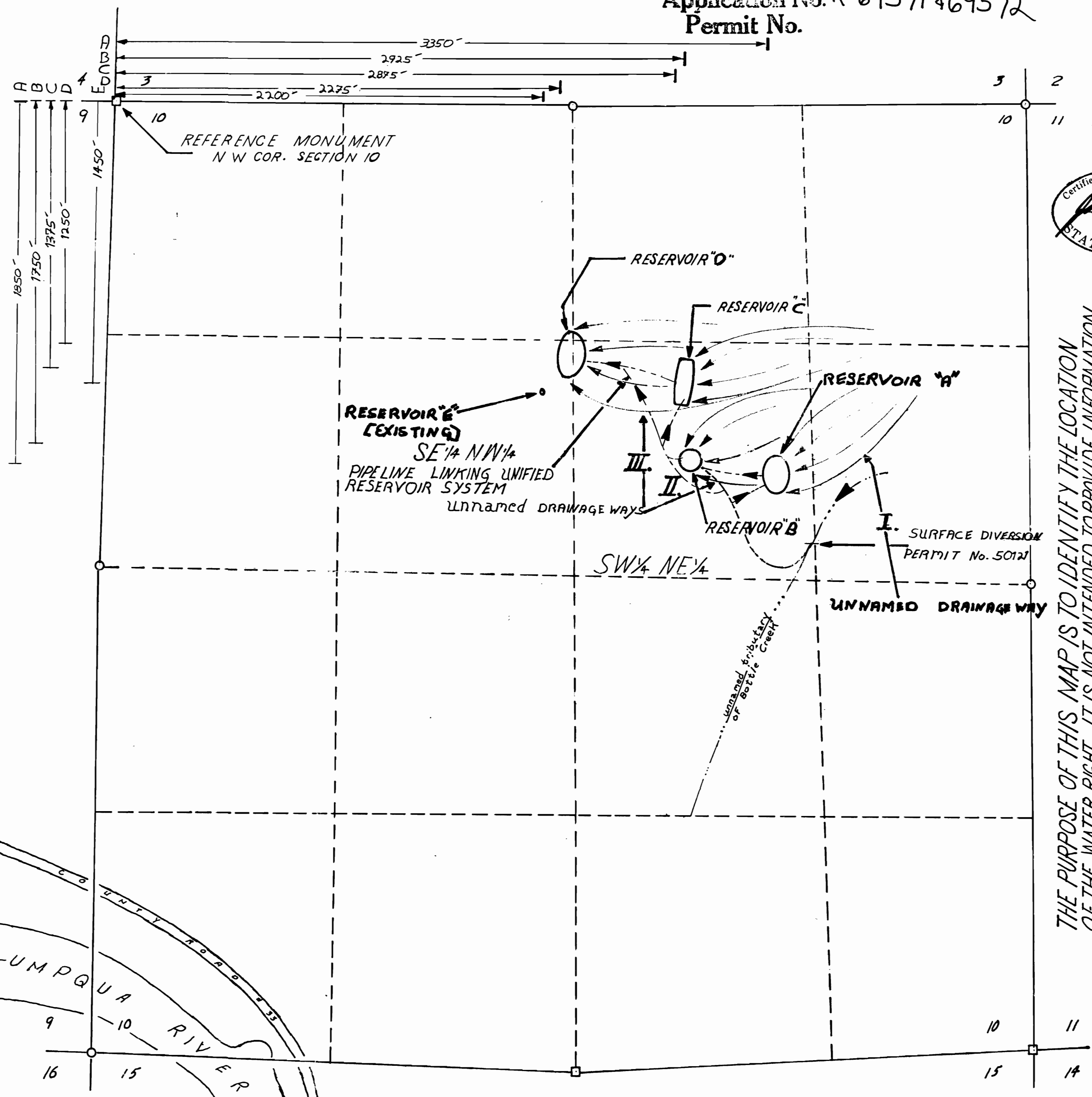
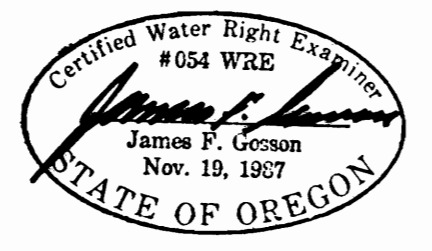

THE PURPOSE OF THIS MAP IS TO IDENTIFY THE LOCATION OF THE WATER RIGHT. IT IS NOT INTENDED TO PROVIDE INFORMATION RELATIVE TO THE LOCATION OF PROPERTY OWNERSHIP BOUNDARY LINES.