

T. 12 S. R. 14 E., W. M.

SECTION 27

"RIM ROCK RESERVOIR"

G.L.O. ~ N. 89° 28'W. 80.00 CHS.



SCALE
1" = 1320'

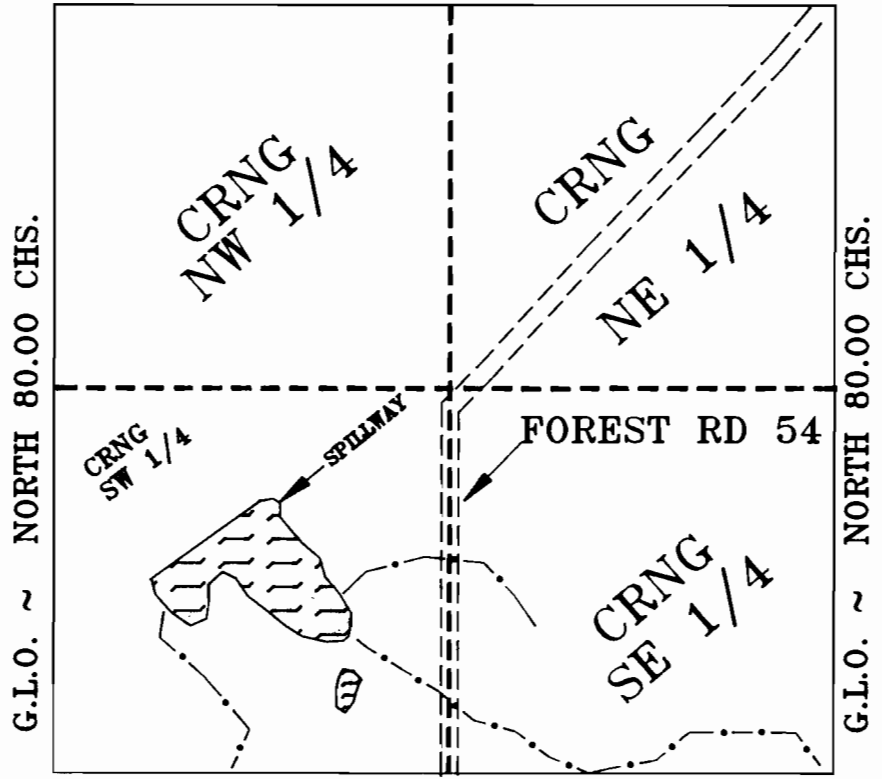

THE PREPARATION OF THIS MAP IS FOR THE PURPOSE OF IDENTIFYING THE LOCATION OF THE WATER RIGHT ONLY AND HAS NO INTENT TO PROVIDE DIMENSIONS OR LOCATIONS OF PROPERTY LINES.

G.L.O. ~ N. 89° 52'W. 79.55 CHS.

LEGEND

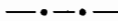
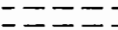
-  EXISTING RESERVOIR AND POND
-  DRAINAGE
-  FOREST ROAD 54

PREPARED FOR
U.S.D.A. FOREST SERVICE
OCHOCO NATIONAL FOREST
CROOKED RIVER NATIONAL GRASSLANDS
BYRON CHENEY, RANGER
813 SW HWY. 97
MADRAS, OR, 97741

LOCATION SOURCE
U.S.G.S. QUADRANGLES, BUCK BUTTE AND GRAY BUTTE, OREGON 7.5 MIN. 1984.

RESERVOIR LOCATION
LOCATED IN SW1/4, SEC. 27.
T.12S. R.14E., W.M.,
JEFFERSON CO., OREGON.
LOCATED 3400 FT. SOUTH
AND 3860 FT. WEST OF NE
SEC. COR., SEC. 27

OCHOCO NATIONAL FOREST
P.O.BOX 490
PRINEVILLE, OR, 97754
[541] 416-6500

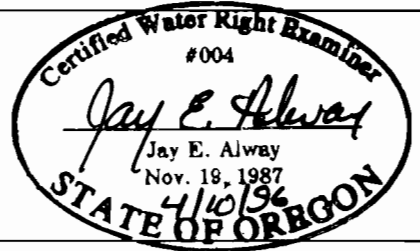

RIMROCK SPRINGS WILDLIFE RESERVOIR

SHEET 1 OF 1

T.12S. R.14E., W.M.
SECTION 27

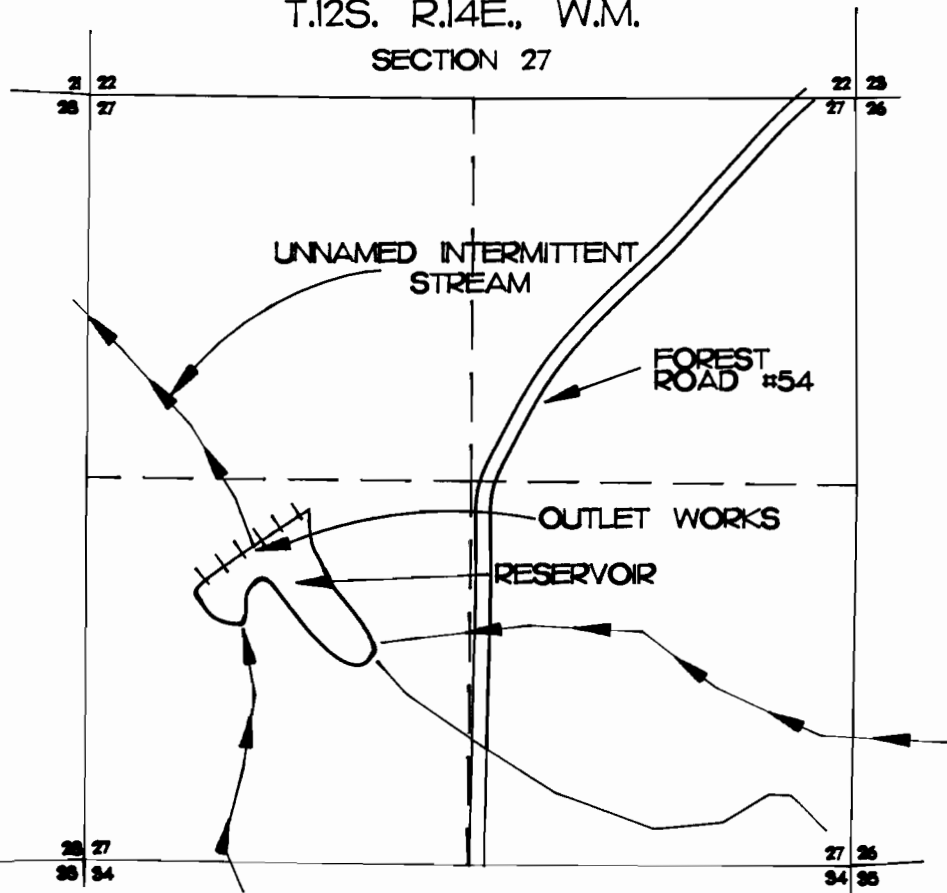

The preparation of this map is for the purpose of identifying the location of the Water Right only and has no intent to provide dimensions or locations of property ownership lines.

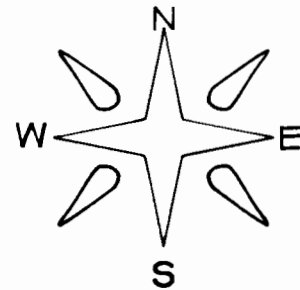

1" = 1320' SCALE



LEGEND

- ||||| Existing Levee
- ==== Existing Road
- ←→ Streams

PREPARED FOR:

U.S.D.A. Forest Service
Crooked River National Grassland
Cherl Bashor, Ranger
2321 East Third Street
Prineville, OR 97754

LOCATION SOURCE:

U.S.G.S. Quadrangles, Buck Butte, Ore.,
7.5 min., 1978 and Gray Butte, Ore.,
7.5 min., 1978.

OUTLET LOCATION:

Located in N 1/2 SW 1/4
of Section 27 T.12S. R.14E.,
W.M., Jefferson Co., Oregon.
3510 feet South and 4100
feet West of NE Sec. Cor.
Section 27.

APPLICATIONS: R-70368, 70369

PERMITS: R-11370, 51222

OCHOCO NATIONAL FOREST
P.O. Box 490
Prineville, OR 97754
(503) 447-6247

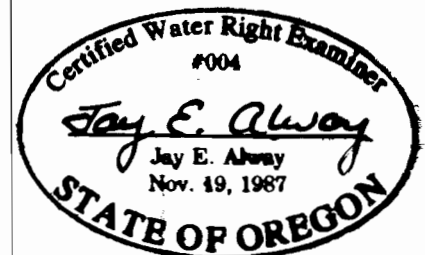

SCALE: 1" = 1320'

DATE: MAY 17, 1990

OCHOCO N.F. #1