

T.4S. R.3W. W.M.

YAMHILL COUNTY

JUN 07 1991

STATE OF OREGON

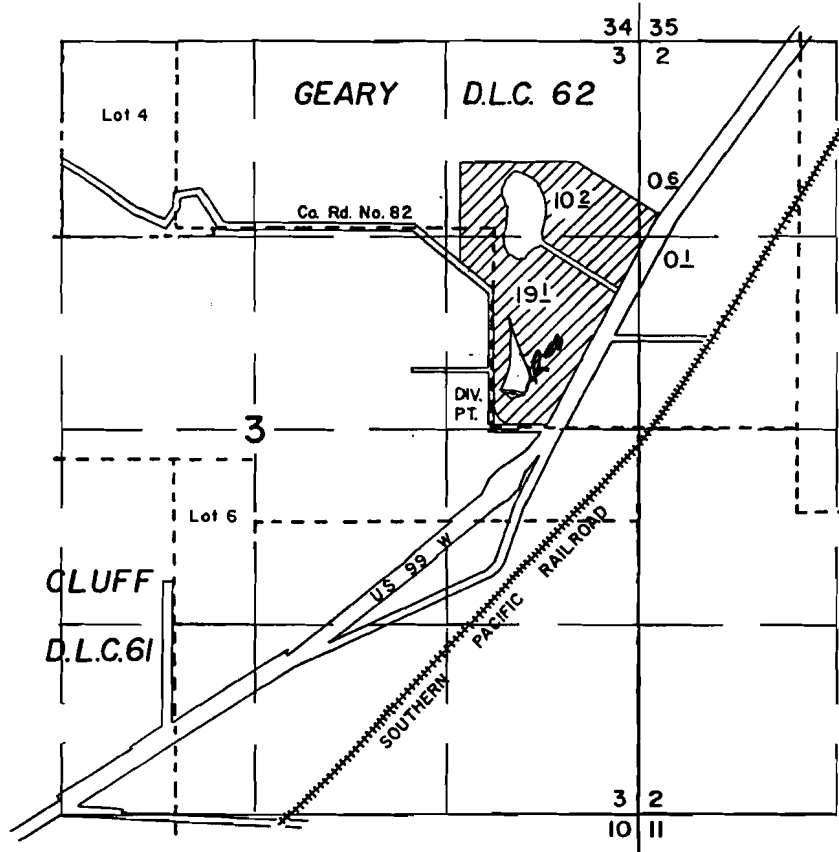

DIV. PT. 257'N & 850'W OF THE EAST 1/4 CORNER OF SEC. 3, T4S, R3W, WM

APPLICATION TO APPROPRIATE SURFACE WATER

Application No R-71690 Permit No R-11409

H. E. WINTERS

JUNE 4, 1991
SCALE 1" = 1320'

