

T.8 S. R.1 W., W.M.

APP #R-72875  
Permit # R11632

**RECEIVED**

OCT 27 1992

WATER RESOURCES DEPT.  
SALEM, OREGON



1" = 400'

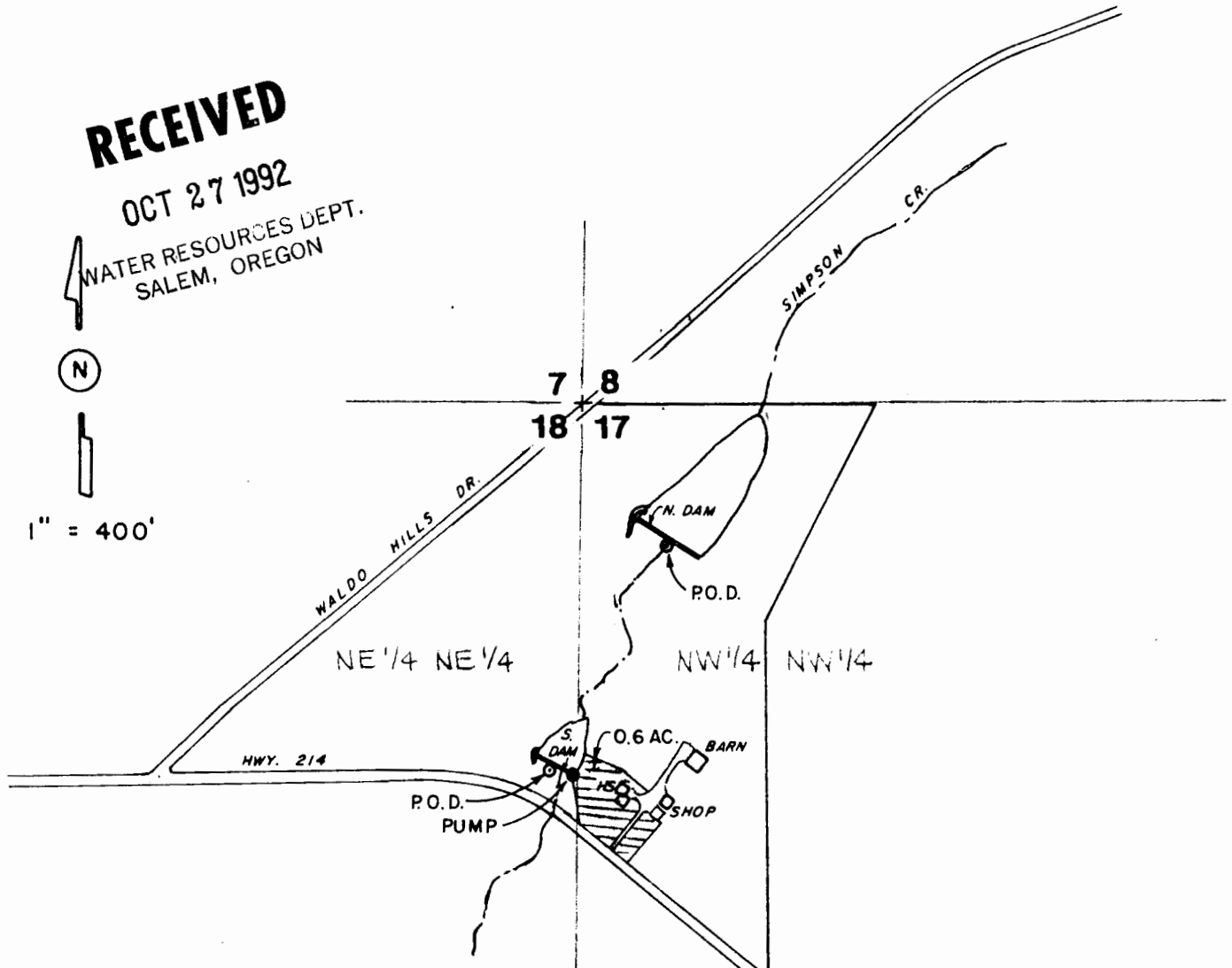

**WATER RIGHT MAP FOR  
LEE & DAWN ROBBERSTAD**

SURVEYED ON SEPT. 30, 1992

BY:   
 LARRY W. LEBOUSSEIER  
 Dec. 7, 1989  
 STATE OF OREGON

THIS MAP WAS PREPARED FOR THE PURPOSE OF IDENTIFYING THE LOCATION OF A WATER RIGHT ONLY AND IS NOT INTENDED TO PROVIDE LEGAL DIMENSIONS OR LOCATION OF PROPERTY OWNERSHIP LINES.

- P.O.D. NDAM LOC. 330' S. & 200' E. FROM SEC. COR. 7,8,17,18
- P.O.D. SDAM LOC. 880' S. & 70' W. FROM SEC. COR. 7,8,17,18
- PUMP @ S.DAM LOC. 870' S. & 20' W. FROM SEC. COR. 7,8,17,18