

APPLICATION MAP IN THE NAME OF GEORGE D. WILLIAMS

SECTION 6, TOWNSHIP 29 SOUTH, RANGE 14 WEST, W.M.

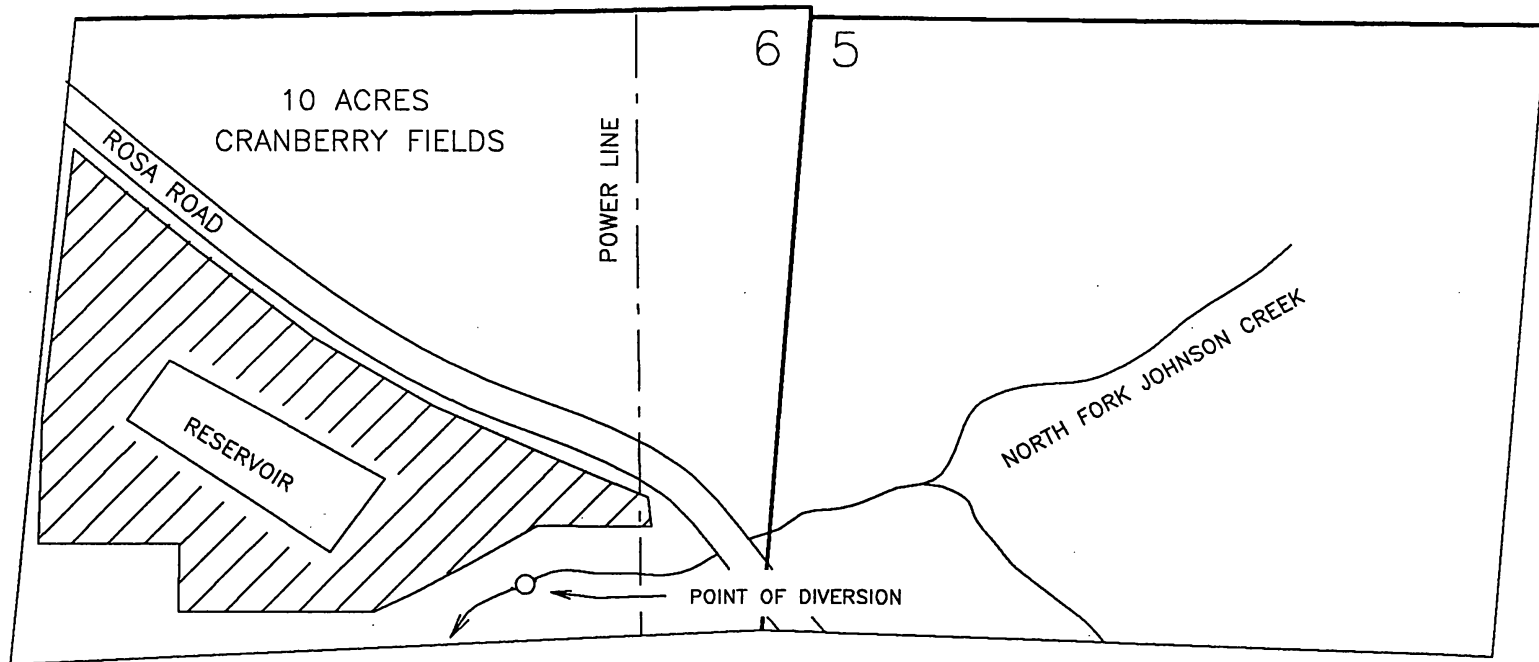

1 INCH = 400 FEET

RECEIVED
OCT 29 1993
WATER RESOURCES DEPT.
SALEM, OREGON

THE POINT OF DIVERSION IS TO BE LOCATED 1,210 FEET SOUTH AND 600 FEET WEST FROM THE NORTHEAST CORNER OF SECTION 6, BEING WITHIN THE NE $\frac{1}{4}$ OF THE NE $\frac{1}{4}$ OF SECTION 6, TOWNSHIP 29 SOUTH, RANGE 14 WEST, W.M., COOS COUNTY.

THE RESERVOIR IS TO BE LOCATED WITHIN THE NE $\frac{1}{4}$ OF THE NE $\frac{1}{4}$ OF SECTION 6, TOWNSHIP 29 SOUTH, RANGE 14 WEST, W.M., COOS COUNTY.

THE PURPOSE OF THIS MAP IS TO IDENTIFY THE LOCATION OF THE WATER RIGHT. IT IS NOT INTENDED TO PROVIDE INFORMATION RELATIVE TO THE LOCATION OF PROPERTY OWNERSHIP BOUNDARY LINES.

Application No. R-73752
Permit No. R11770

Certified Water Right Examiner
#054 WRE
James F. Gosson
James F. Gosson
Nov. 19, 1987
STATE OF OREGON