

APPLICATION MAP

IN THE NAME OF GARDNER E. KENT

SECTION 35, T30S, R7W, W.M.



1 INCH = 1320 FEET

RECEIVED

OCT 18 1990

WATER RESOURCES DEPT.
SALEM, OREGON

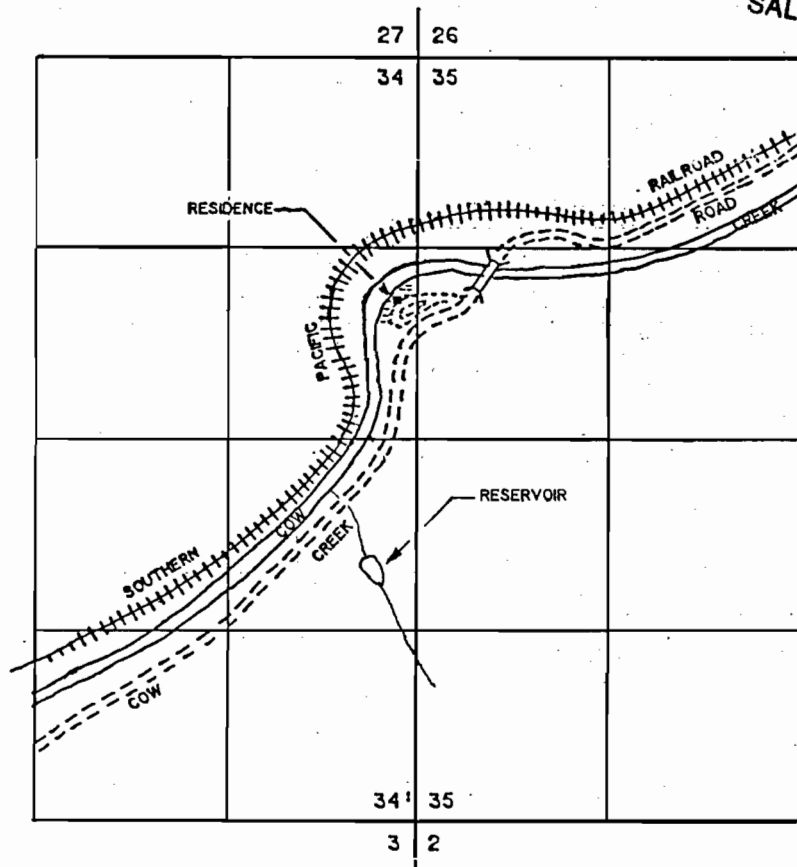

Application No. R-70779 & 70778
Permit No. R11926

THE PURPOSE OF THIS MAP IS TO IDENTIFY THE LOCATION OF THE WATER RIGHT. IT IS NOT INTENDED TO PROVIDE INFORMATION RELATIVE TO THE LOCATION OF PROPERTY OWNERSHIP BOUNDARY LINES.

