

T. 4 S. R. 1 W. & 1 E. W. M. RECEIVED

JUL 8 1996

WATER RESOURCES DEPT.
SALEM, OREGON

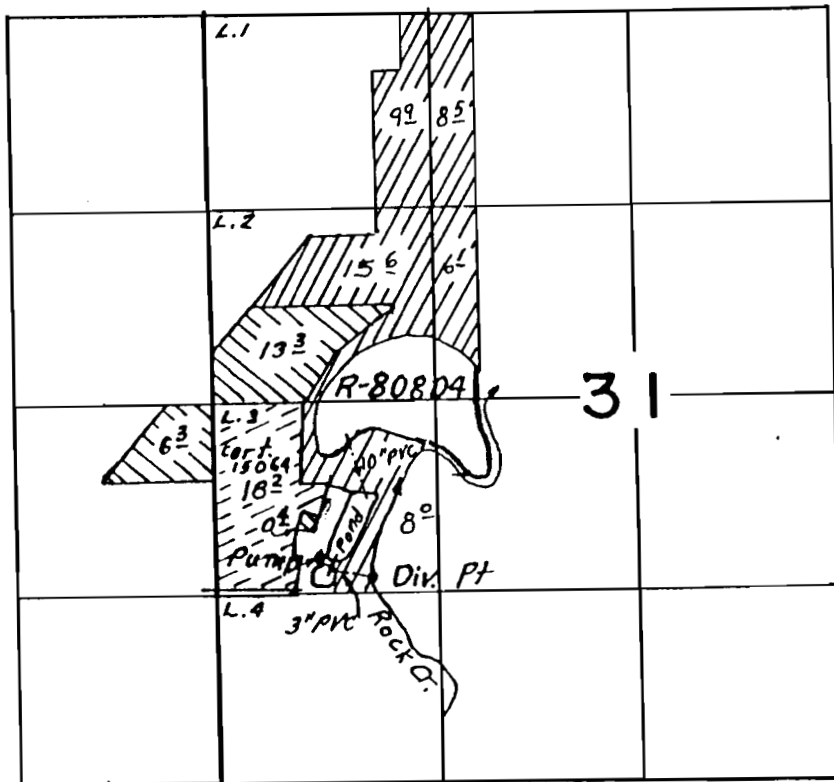

Scale
4" = 1 Mi.

Div. Pt. loc. 1220' S & 1050' E From W 1/4 Cor.



To lands - Cert. 15049 T-_____



Appl. No. 5-80803

ALSO SEE R-80804
permit R11955

WATER RIGHT MAP FOR
JOEL NEUSCHWANDER

THIS MAP WAS PREPARED FOR THE
PURPOSE OF IDENTIFYING THE LOCA-
TION OF A WATER RIGHT ONLY AND IS
NOT INTENDED TO PROVIDE LEGAL
DIMENSIONS OR LOCATION OF PROPER-
TY OWNERSHIP LINES.

