

# Townships 5 & 6 South, Range 1 West, W.M.

Portions of Sections 33, 34 & 35 in Township 5 South  
& Sections 2 & 3 & the East 1/2 of Section 4 in Township 6 South

# RECEIVED

NOV 22 1991

WATER RESOURCES DEP.  
SALEM, OREGON

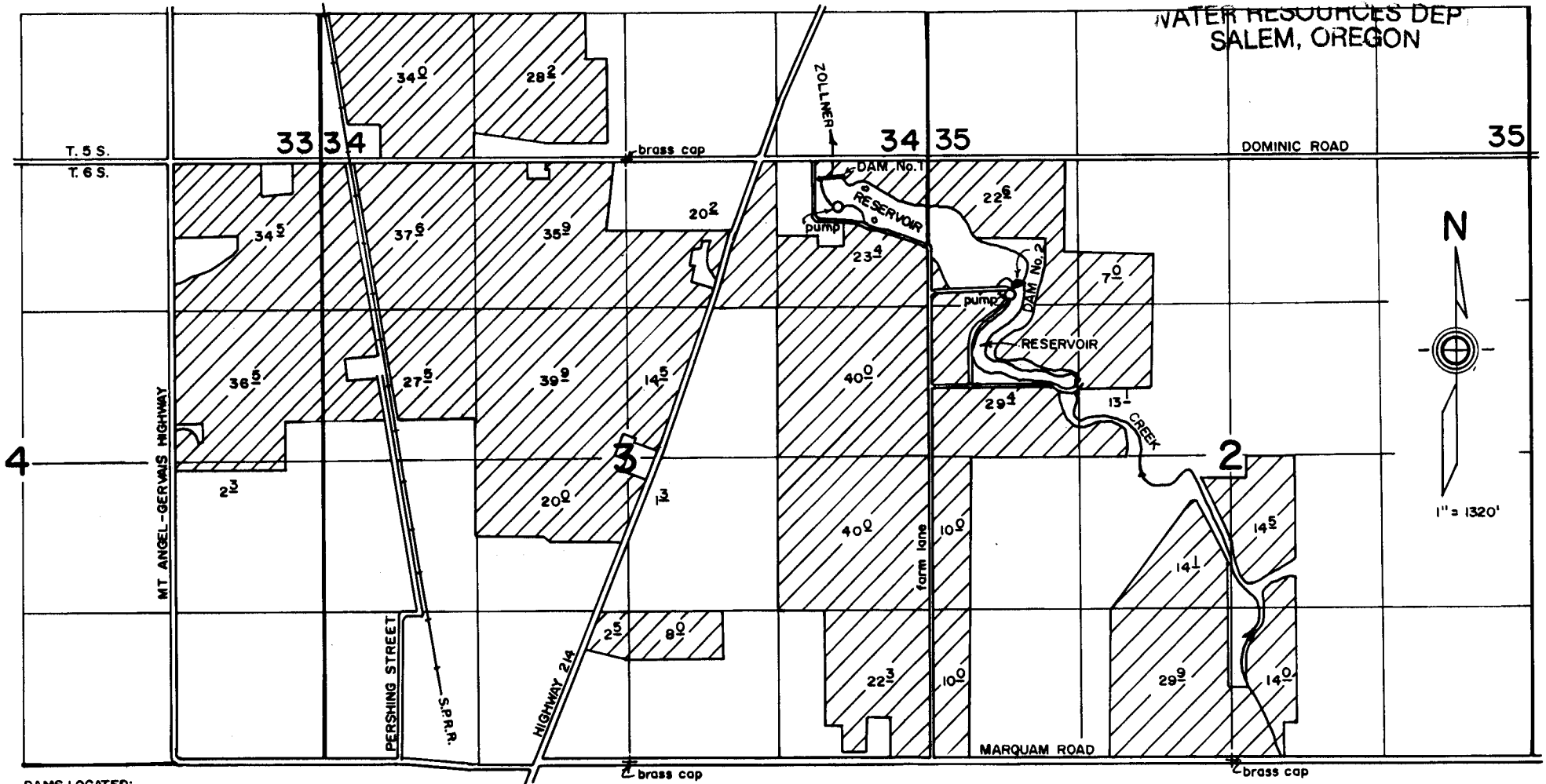

**DAMS LOCATED:**

No. 1, 160' S. and 1790' E.  
No. 2, 1100' S. and 3410' E.  
Both from N. 1/4 cor. Sec. 3

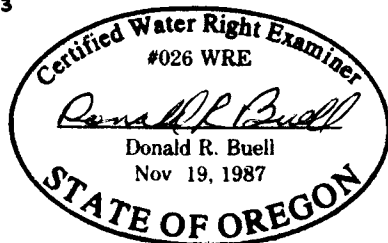

Application Map  
for

**KRAEMER FARMS**

Appl. No. 72038  
Per. No. R12051

THIS MAP WAS PREPARED FOR THE PURPOSE OF IDENTIFYING THE LOCATION OF A WATER RIGHT ONLY AND IS NOT INTENDED TO PROVIDE LEGAL DIMENSIONS OR LOCATION OF PROPERTY OWNERSHIP LINES.