

AS-BUILT

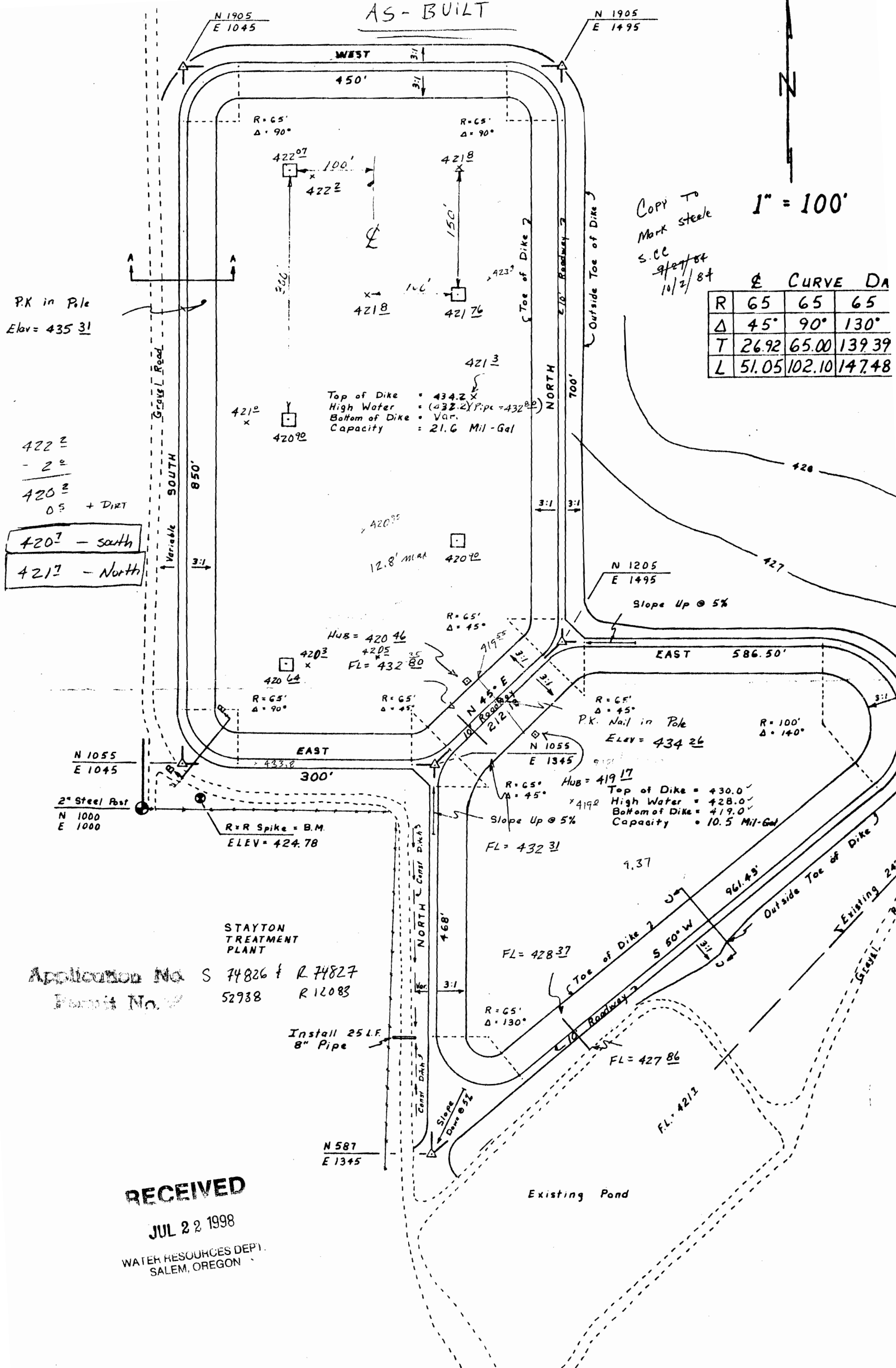

COPY TO Mark Steele
 S.C.C. 9/27/84
 10/2/84

1" = 100'

	CURVE DATA		
R	65	65	65
Δ	45°	90°	130°
T	26.92	65.00	139.39
L	51.05	102.10	147.48

P.K. in Pole
 Elev = 435.31

422.2
 - 2.0
 420.2
 0.5 + DIRT

420.7 - south
 421.7 - North

Top of Dike = 434.2
 High Water = (432.2) Pipe = 432.8
 Bottom of Dike = Var.
 Capacity = 21.6 Mil-Gal

N 1205
 E 1495
 Slope Up @ 5%

Hub = 419.17
 Top of Dike = 430.0
 High Water = 428.0
 Bottom of Dike = 419.0
 Capacity = 10.5 Mil-Gal

STAYTON TREATMENT PLANT
 Application No S 74826 & R 74827
 Permit No. 52938 R 12083

RECEIVED
 JUL 22 1998
 WATER RESOURCES DEPT.
 SALEM, OREGON

Final Proof Maps

available through

OWRD WrisQuery page

[View all scanned documents](#)