

Application No. R-72732
Permit No. R12091

T.1&2S,R.2E.W.M.

RECORDED

LAND RESOURCES DE-
PT. OF OREGON

SEP 2 1972

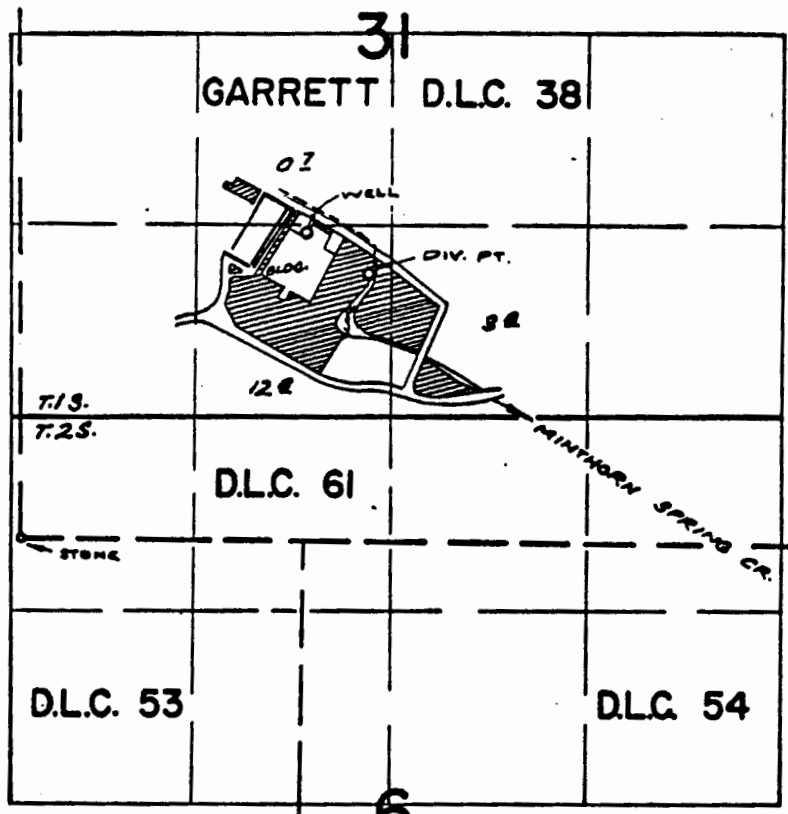

WELL LOC. 1900' E. & 2070' N. FROM S.W. COR. GARRETT D.L.C. 38
DIV. PT. 200' E. & 1000' N.

FINAL PROOF SURVEY
UNDER

TRANSFER No. 0-54
Application No. ~~G-9235~~ ^{G-4517} Permit No. ~~G-3041~~ ^{G-4276}
IN NAME OF

OMARK PROPERTIES, INC.

Surveyed Nov. 6, 1970, by L. E. GAULD.