

Application No. 72442

Permit No. R12175

TOWNSHIP 31 SOUTH, RANGE 15 WEST

MAP TO ACCOMPANY SURFACE WATER AND RESERVOIR APPLICATION IN SEC. 2

Prepared For: Peter and Diane Bussmann
P.O. Box 282
Sixes, OR 97476

Prepared By: Prahar Surveying
1045 Baltimore #1
Bandon, OR 97411
(503)347-9517

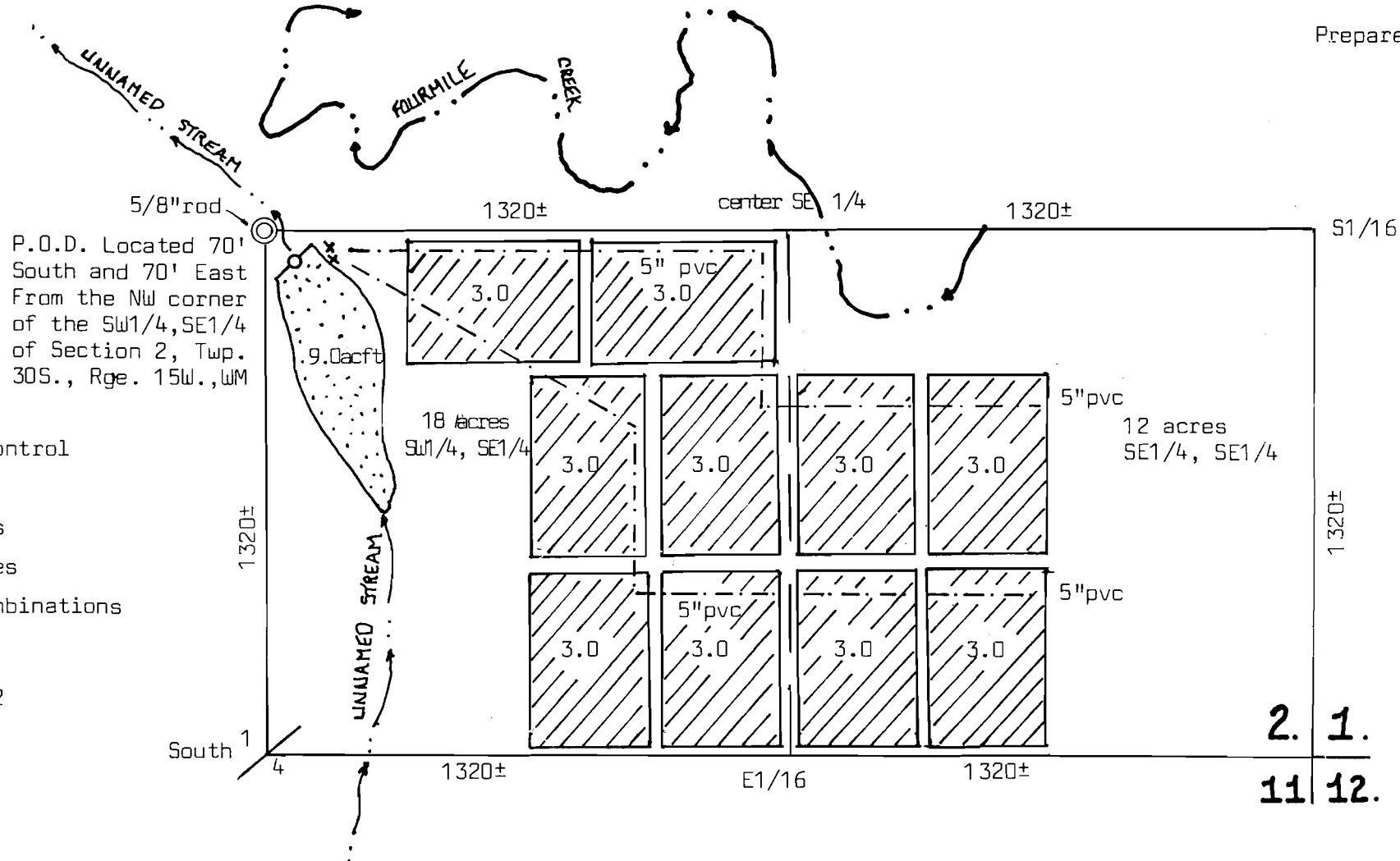

- LEGEND: ⊙ 5/8" rod for control
- Reservoir
- Cranberry Bogs
- main waterlines
- Pump/motor combinations
- water courses

DATE: April 21, 1992

