

Miles.
Crossing
1.6 mi

83091

RECEIVED

Plan No. R1228

JUL 10 1997

Sec. 36
T8N
R10W

Sec. 31
T8N
R9W
WATER RESOURCES DEPT.
SALEM, OREGON



Petersen Road

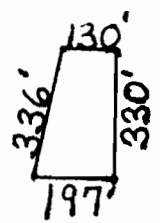

NE 1/4 of SE 1/4 Sec. 36
tax lot #1100

Hwy
Clark
and
Lewis

Lawn

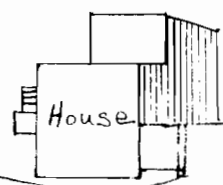

Bank



Helligso Road

100'

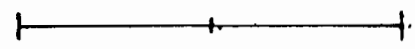

Scale 1" : 50'

RECEIVED

JUL 10 1997

WATER RESOURCES DEPT
SALEM, OREGON

Clatsop
County
Airport

Day
Point

YOUNG'S

Miles
Crossing

101
ALT

Ft. Clatsop
Natl.
Monument

Substation

Si. Lewis
Green

CLARK

LEWIS &
Barrett Cr.

Fry
Island

TUCKER

MAINLINE

Application No. 83441

Permit No. R12283

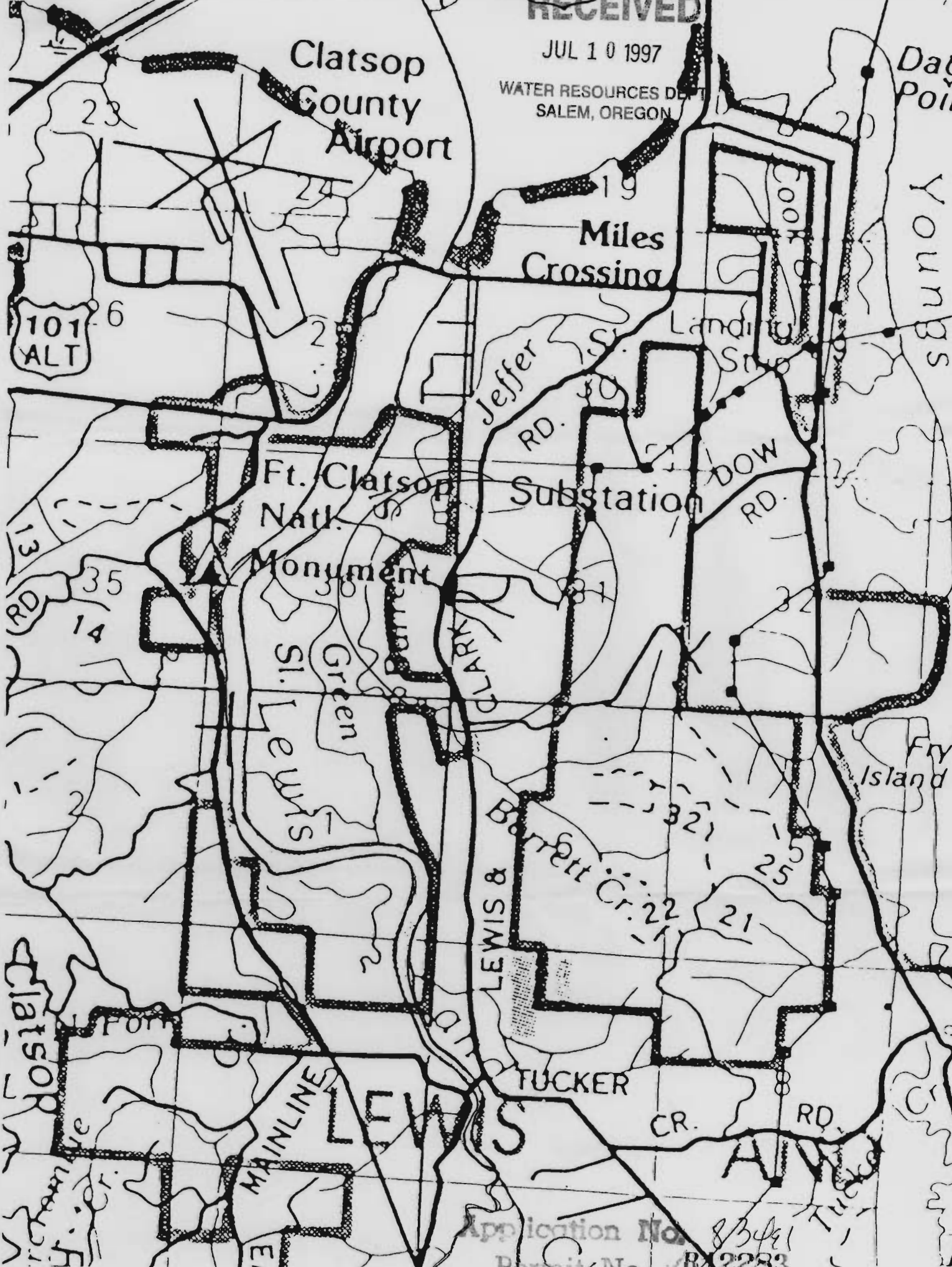

RECEIVED

JUL 10 1997

WATER RESOURCES DEPT.
SALEM, OREGON

Taylor Sands

TONGUE POINT

T. 9 N.
15'

Application No. 83091
Permit No. 17283

T. 7 N.

T. 6 N.
46° 00'



O C C E A N