

**RECEIVED**

APR - 2 1997

APPLICATION MAP  
IN THE NAME OF ROBERT M. LOFTIN

WATER RESOURCES DEPT.  
SALEM, OREGON

SECTIONS 8 & 9, T 29 S, R 14 W, W.M.

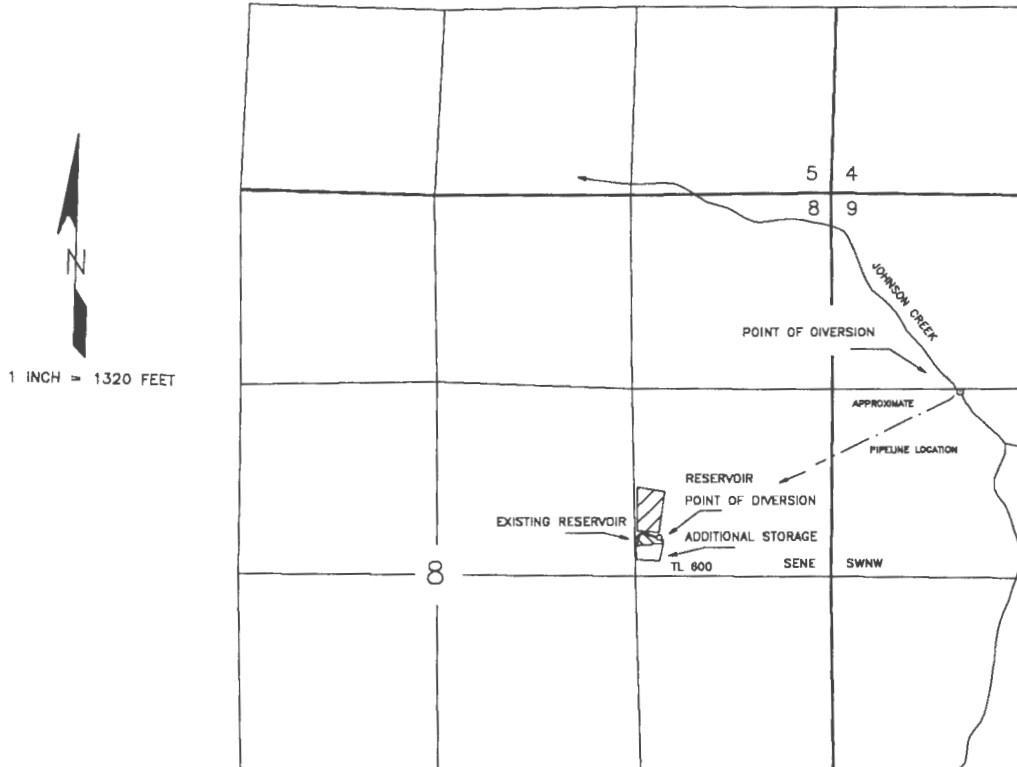

Application No. R-83393  
Permit No. R12324

THE POINT OF DIVERSION FROM JOHNSON CREEK IS LOCATED 1,350 FEET SOUTH AND 880 FEET EAST FROM THE NORTHWEST CORNER OF SECTION 9, BEING WITHIN THE SW $\frac{1}{4}$ NW $\frac{1}{4}$  OF SECTION 9, TOWNSHIP 29 SOUTH, RANGE 14 WEST, W.M., COOS COUNTY.

THE POINT OF DIVERSION FROM THE RESERVOIR IS LOCATED 2,380 FEET SOUTH AND 1,175 FEET WEST FROM THE NORTHEAST CORNER OF SECTION 8, BEING WITHIN THE SE $\frac{1}{4}$ NE $\frac{1}{4}$  OF SECTION 8, TOWNSHIP 29 SOUTH, RANGE 14 WEST, W.M., COOS COUNTY

THE PURPOSE OF THIS MAP IS TO IDENTIFY THE LOCATION OF THE WATER RIGHT.  
IT IS NOT INTENDED TO PROVIDE INFORMATION RELATIVE TO THE LOCATION OF  
PROPERTY OWNERSHIP BOUNDARY LINES.