

T.3S. R.3W. W.M.

YAMHILL COUNTY

RECEIVED

MAR 02 1990

Application No. R 70217
Permit No.

WATER RESOURCES DEPT.
SALEM, OREGON



SCALE: 1" = 1320'
FEBRUARY 20, 1990

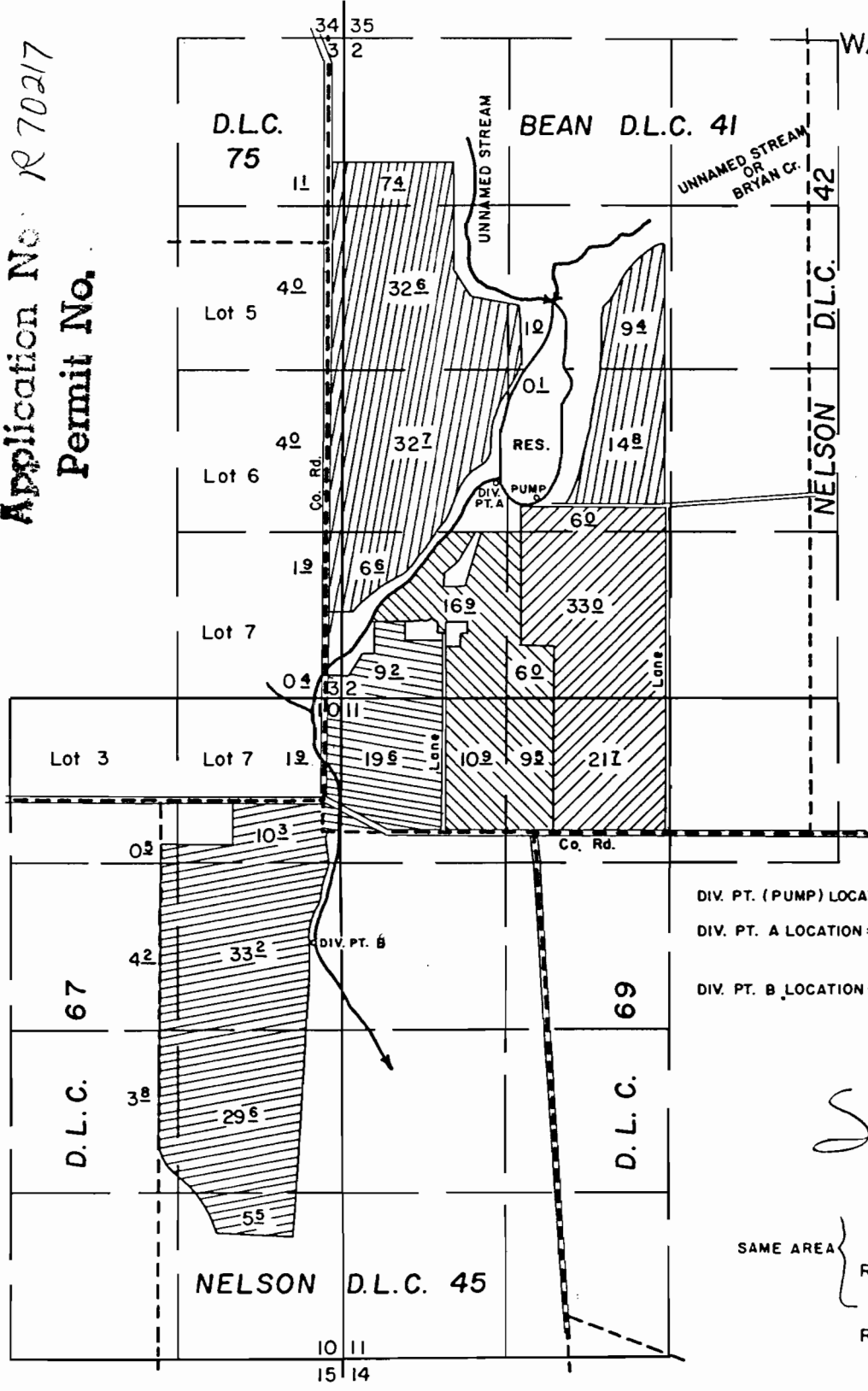

DIV. PT. (PUMP) LOCATION: NW 1/4, SW 1/4, SEC. 2, WITHIN BEAN DLC NO. 41
 DIV. PT. A LOCATION: NW 1/4, SW 1/4, SEC. 2, WITHIN BEAN DLC 41 1750' N & 1240' E OF SE COR. SEC. 2. PERMIT 46315
 DIV. PT. B LOCATION: SE 1/4, NE 1/4, SEC. 10, WITHIN NELSON DLC NO 45, 1950' S & 240' W OF SE COR. SEC. 2

SW cor 2

SAME AREA	25834		21656
	R-28748		R-1560
	28749		22616
	R-29637		R-1761
	29638		23676
	63105		46315
	69882		50741

CANCELED CERT. No. 29001, 29000, 22261 Application No. R- Permit No. R-

BAILEY NURSERIES INC.

APPLICATION FOR ENLARGEMENT OF RESERVOIR