

APPLICATION MAP

IN THE NAME OF NIELS L. & JANICE MARTIN

SECTION 9, T 32 S, R 15 W, W.M.

WATER RESOURCES DEPT
SAPPHIRE DIVISION
FEB 23 1998

Application No. **R 83775**
Permit No. **R12615**

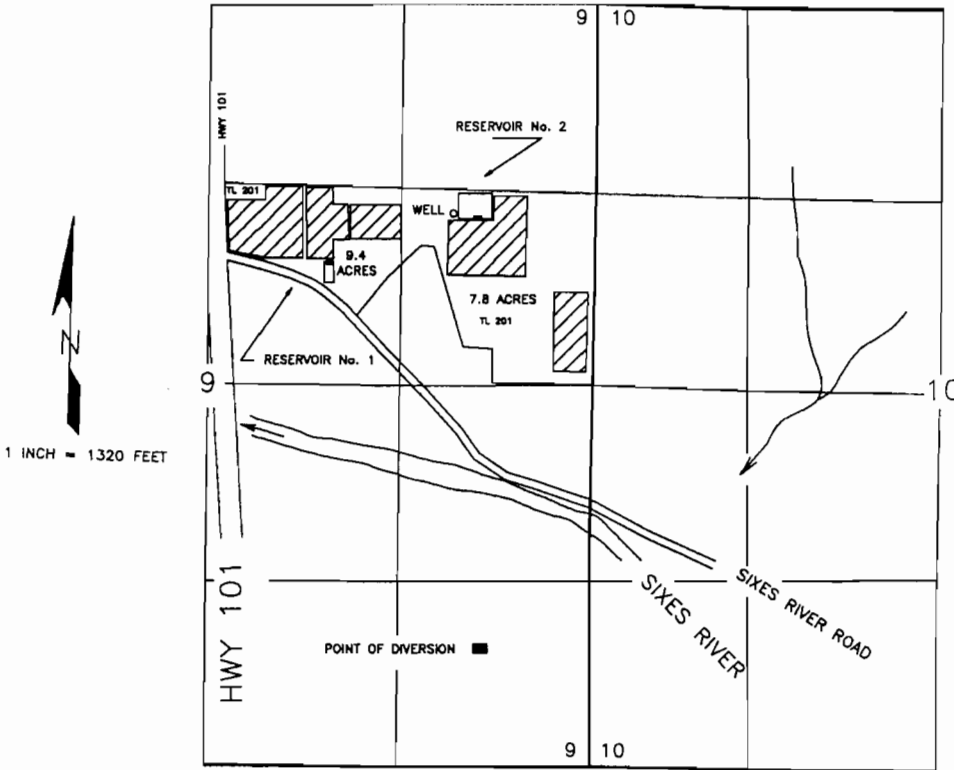

THE RESERVOIRS ARE TO BE LOCATED AS FOLLOWS:

SOURCE	SOUTH	WEST	¼ ¼	SECTION
Reservoir No. 1	1,770 Feet	1,840 Feet	SW¼NE¼	9
Reservoir No. 2	1,470 Feet	810 Feet	SE¼NE¼	9

BOTH FROM THE NORTHEAST CORNER OF SECTION 9, AND WITHIN SECTION 9, TOWNSHIP 32 SOUTH, RANGE 15 WEST, W.M., CURRY COUNTY.