

APPLICATION MAP

IN THE NAME OF NIELS L. & JANICE MARTIN

SECTION 9, T 32 S, R 15 W, W.M.

FEB 23 1998  
 WATER RESOURCES DEPT.  
 SALEM, OREGON

Application No. **R-83774**  
 Permit No. **R12616**

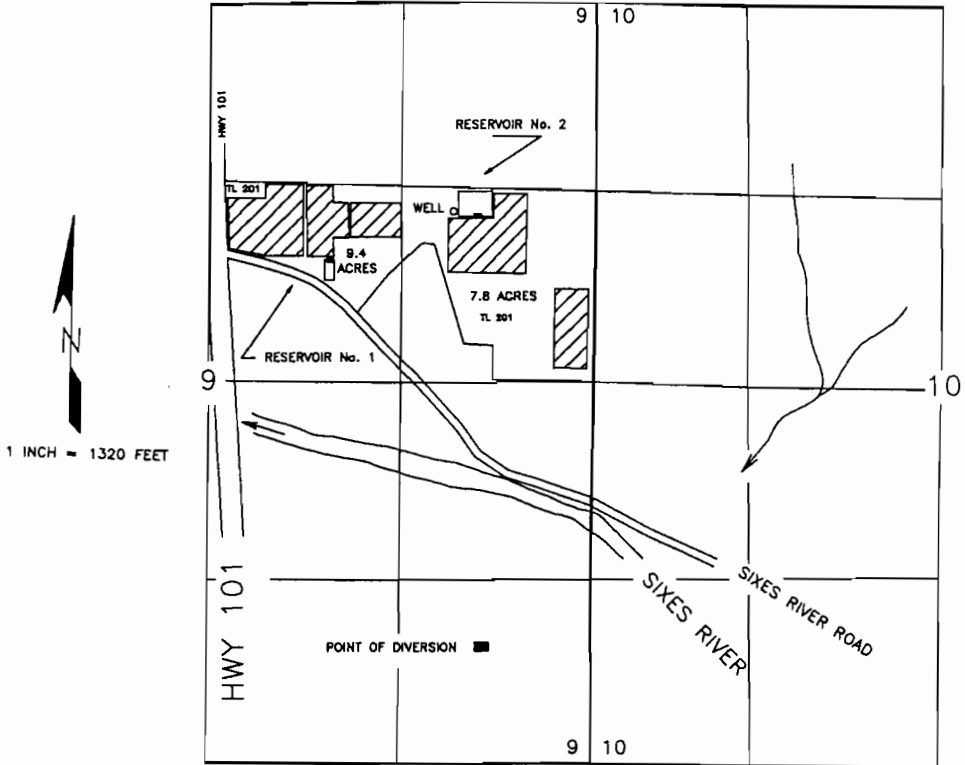

THE RESERVOIRS ARE TO BE LOCATED AS FOLLOWS:

SOURCE	SOUTH	WEST	¼ ¼	SECTION
Reservoir No. 1	1,770 Feet	1,840 Feet	SW¼NE¼	9
Reservoir No. 2	1,470 Feet	810 Feet	SE¼NE¼	9

BOTH FROM THE NORTHEAST CORNER OF SECTION 9, AND WITHIN SECTION 9, TOWNSHIP 32 SOUTH, RANGE 15 WEST, W.M., CURRY COUNTY.

THE PURPOSE OF THIS MAP IS TO IDENTIFY THE LOCATION OF THE WATER RIGHT. IT IS NOT INTENDED TO PROVIDE INFORMATION RELATIVE TO THE LOCATION OF PROPERTY OWNERSHIP BOUNDARY LINES.