

RECEIVED

APR - 3 1998

T.11.,R.5W.,W.M.

WATER RESOURCES DEPT.
SALEM, OREGON



1" = 1320'

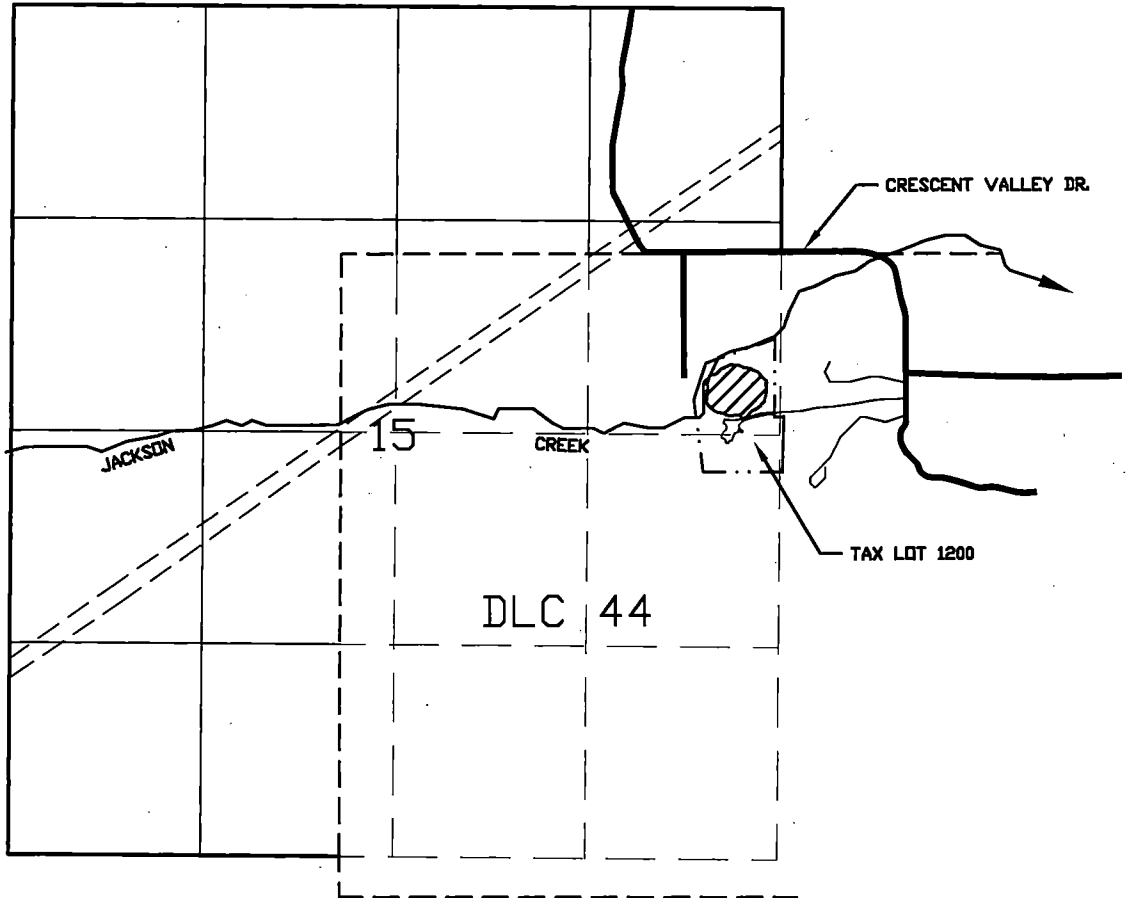

SURFACE WATER
STORAGE APPLICATION
MAP FOR

R-83800
Application No. Permit No. **R12631**

JOHN & JO ANN ACRES

4386 NW CRESCENT VALLEY DR.
CORVALLIS, BENTON COUNTY, OREGON 97330

Date: 3/30/98 by

Trimmer Engineering, Inc.
3924 Walnut Place
Corvallis, OR 97330
Phone (541) 754-2819

DAM LOCATION: IN
TAX LOT 1200, 170 FT.
WEST, 2340 FEET
SOUTH IN SECTION 15.

 = POND SURFACE

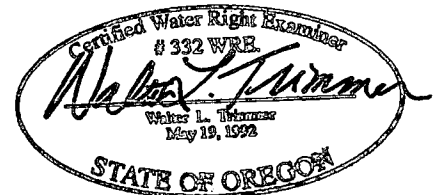
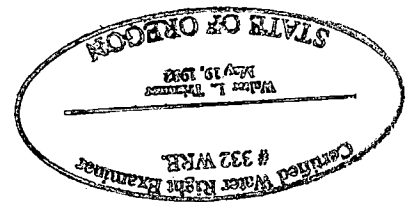

EXP 6-30-98