

Polk Co. Regional Taxlot/Zone Map

Scale 1:594

01/30/97

Application No. R-84051

Permit No. R-12713

T 6 S
R 6 W

RECEIVED

JAN 25 1999

WATER RESOURCES DEPT.
SALEM, OREGON

NE 1/4 SW 1/4 SEC 2 T6S R6W

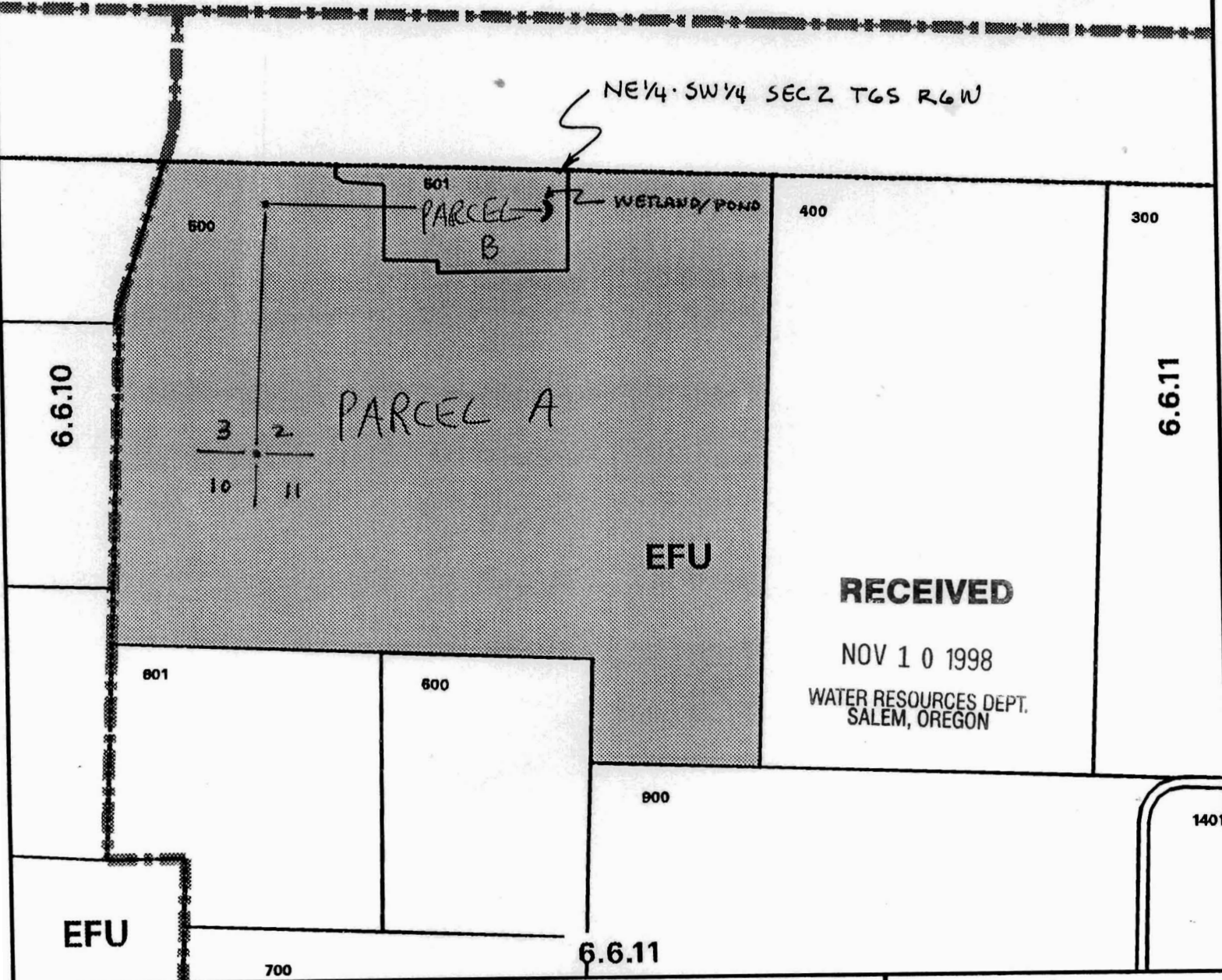

RECEIVED

NOV 10 1998

WATER RESOURCES DEPT.
SALEM, OREGON

This map was produced from data stored in the Polk County Geographic databases. The data originally came from the Assessor Taxdot Maps. The data is maintained by county to support its governmental activities. The county is not responsible for any map errors, possible misuse, or misinterpretations.

Map user: -Polk Co-ComDev



Map Location

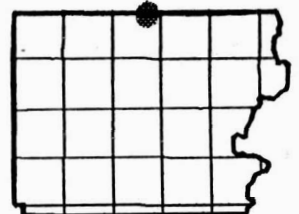

CONSERVATION PLAN

BILL & FREDJA JARVIS
27175 FRY'S LN
SHERIDAN, OR 97378

RECEIVED

JAN 25 1999

WATER RESOURCES DEPT.
SALEM, OREGON

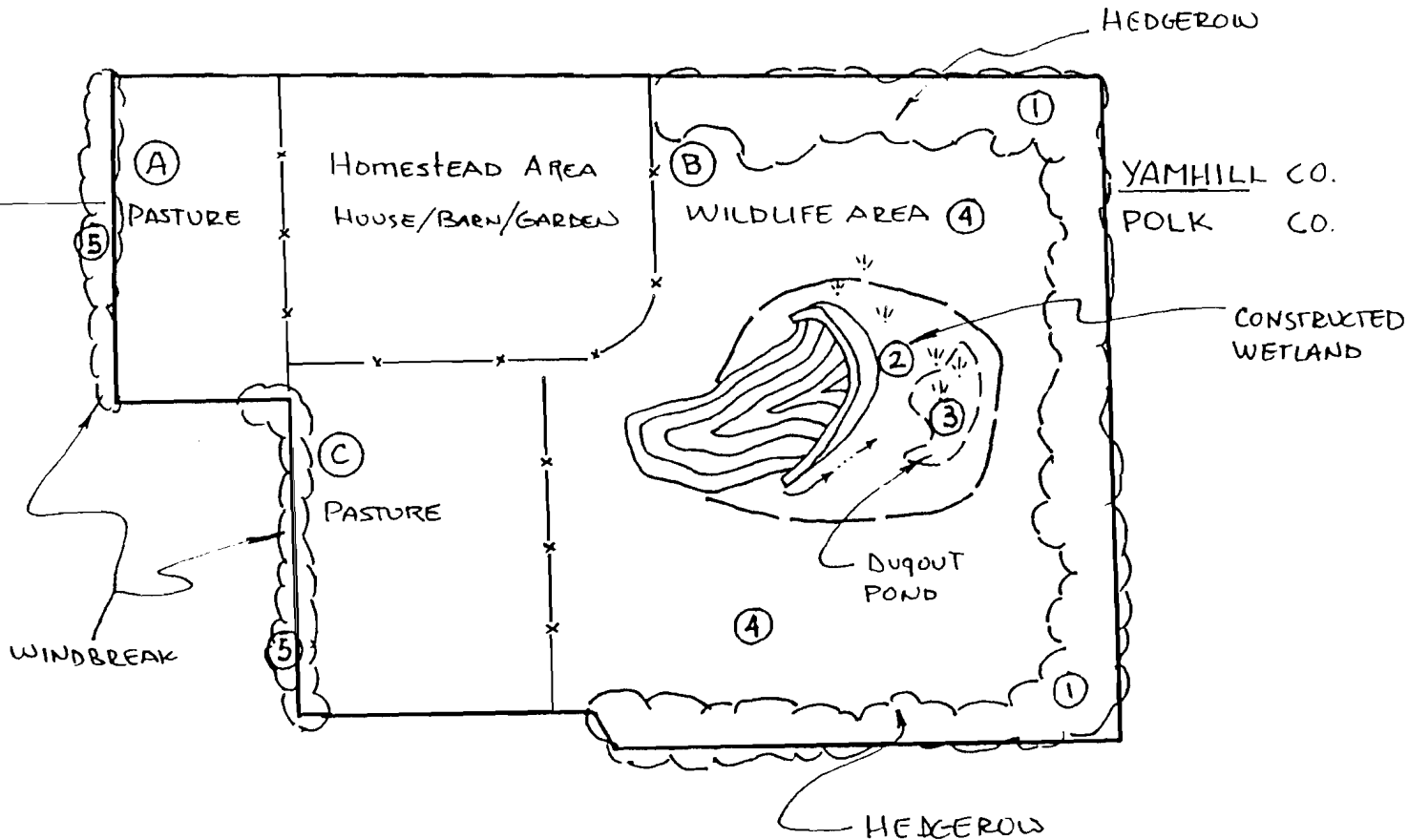

Application No. R 84051

Permit No. FOR REFERENCE ONLY

RECEIVED

NOV 10 1998

WATER RESOURCES DEPT.
SALEM, OREGON

FIELD	USE	ACRES
A	PASTURE	1.0
B	WILDLIFE AREA	6.4
C	PASTURE	1.7
H	HOMESTEAD	1.9