

RECEIVED

JUN 15 1999

WATER RESOURCES DEPT.
SALEM, OREGON

SUPERVISOR

T.9S. R.3W. W.M.

MARION COUNTY

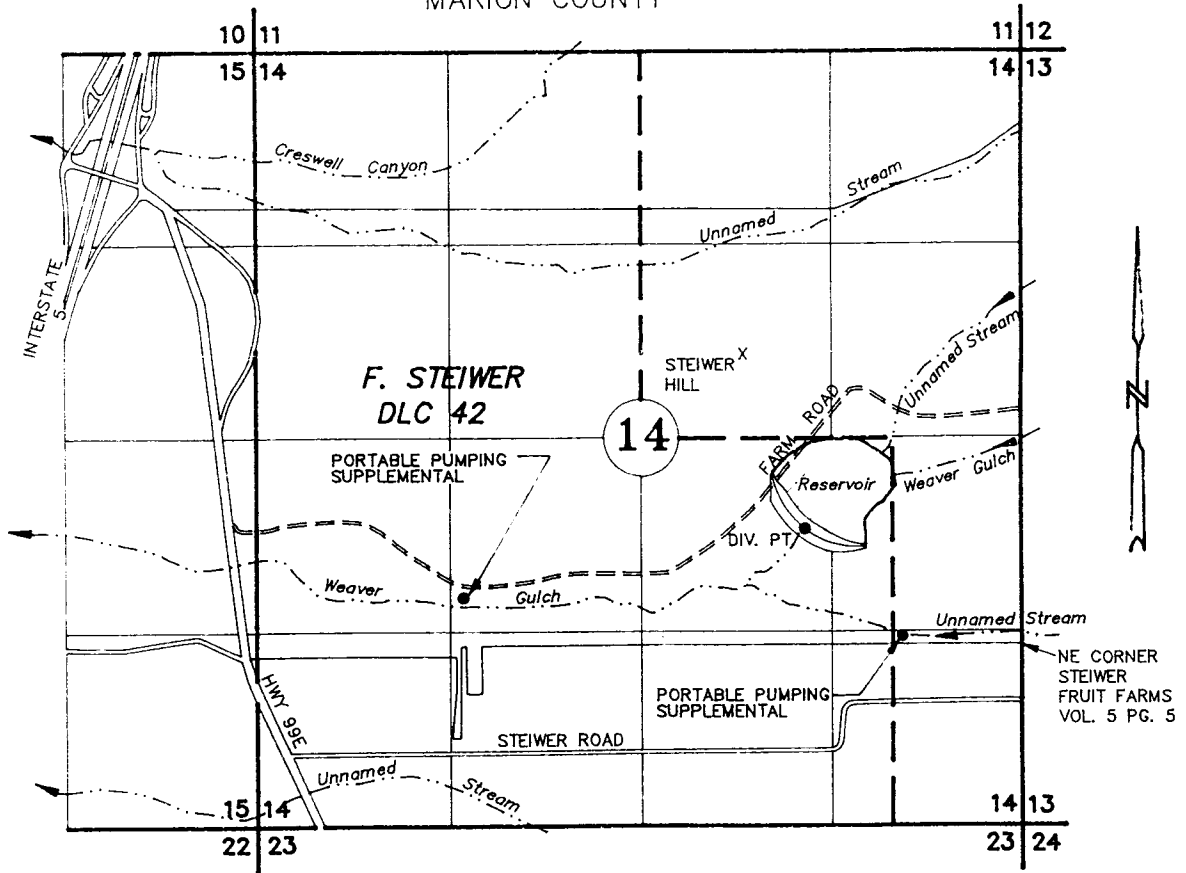

DIV. PT. LOCATION (PUMP): NW 1/4 SE 1/4, SEC. 14;
785' N AND 1510' WEST OF NE COR. STEIWER FRUIT FARMS

APPLICATION TO CONSTRUCT A RESERVOIR

Application No. _____

R-22915	R-916
22916	18066
R-84036	
S-84037	

Permit No. _____

GLENN AND MARY WESTBROOK

JANUARY 08, 1999
SCALE 1" = 1320'

NOTE: This map is for the purpose of identifying the location of water rights and has no intent to dimension or locate property ownership lines.

REVISED: APRIL 08, 1999
REVISED: APRIL 30, 1999

