

RECEIVED

DEC 20 2000

T. 17S, R. 10W. W.M.

RECEIVED

JAN 08 2001

WATER RESOURCES DEPT.
SALEM, OREGON

WATER RESOURCES DEPT.
SALEM, OREGON

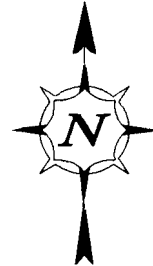
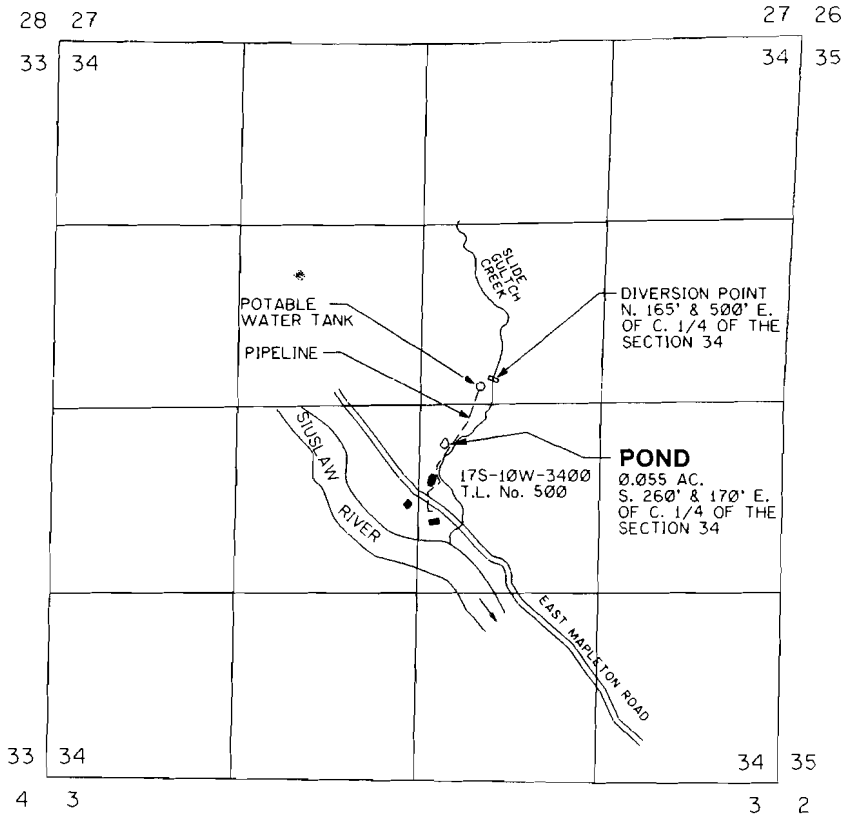

APPLICATION MAP
FOR STORAGE RESERVOIR

Application No. R-84634

Permit No. R-13125

1" = 1320'

IN THE NW 1/4 OF SE 1/4 OF SECTION 34,
T. 17S., R. 10W., W.M.
LANE COUNTY, OREGON

FOR

GORDON A. & MARILYN CAMP

OCTOBER 19, 2000

BY: MIKE MCALLISTER ENGINEERING
11301 E. MAPLETON ROAD
MAPLETON, OREGON 97453

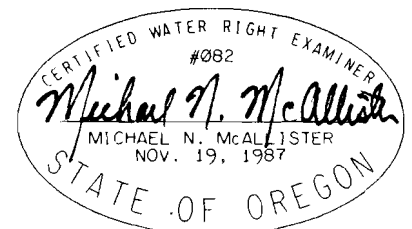

NOTE:

THIS MAP IDENTIFIES THE LOCATION OF THE
WATER RIGHT ONLY, AND IS NOT INTENDED TO PROVIDE
DIMENSIONS OR LOCATE PROPERTY OWNERSHIP LINES.