

RANGE 37 EAST.

RANGE 38 EAST.

RANGE 39 EAST.

TP., 6 SOUTH.

UNSURVEYED.

TP., 7 SOUTH.

UNSURVEYED.

TP., 8 SOUTH.

UNSURVEYED.

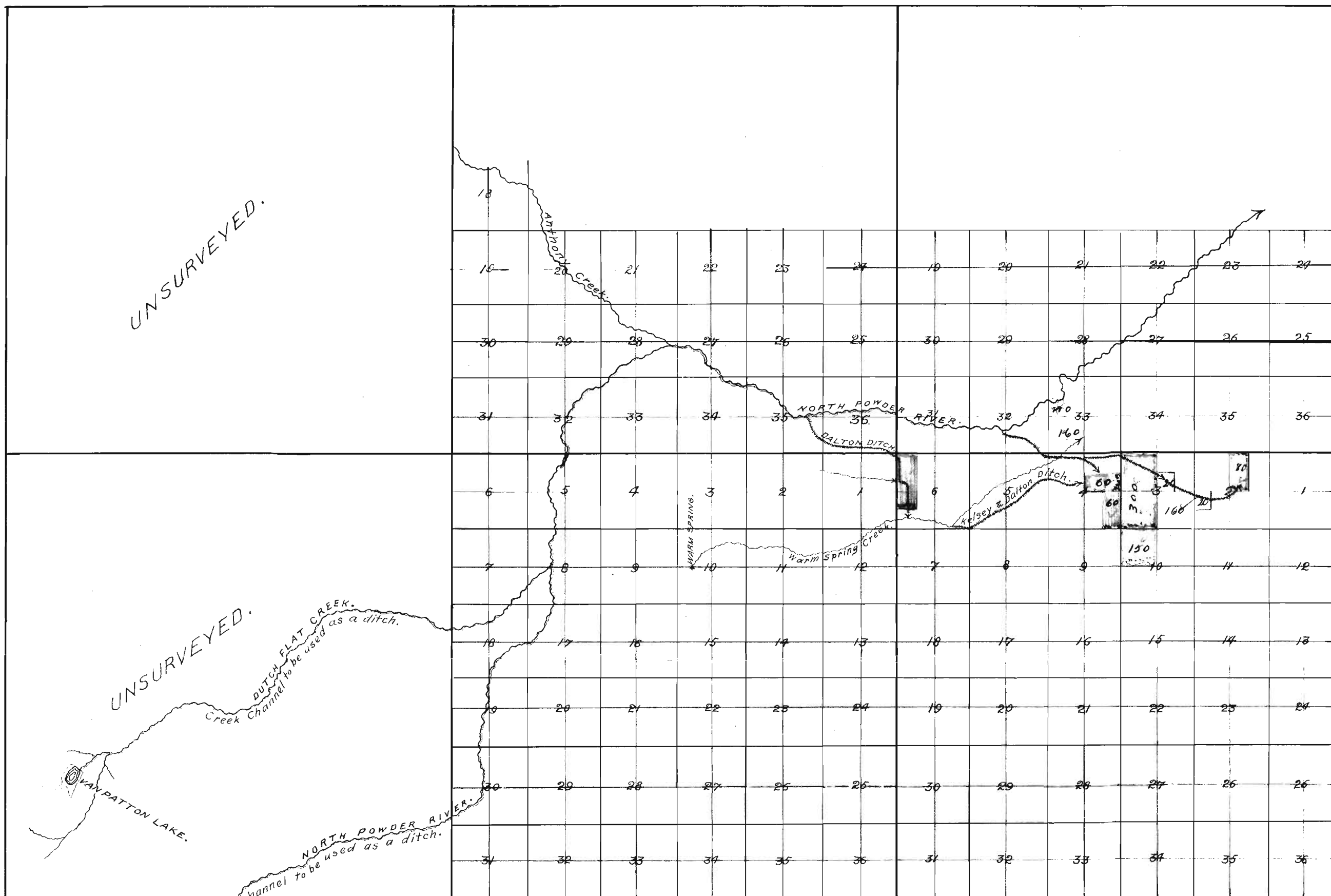

DIAGRAM

to accompany the application of James Dalton & J.T. York for a permit to store, divert and use waters from Van Patton Lake, Summit Lake and Little Summit Lake.

Drawn June 21st 1911
by C.M. Foster Surveyor.

REFERENCE.

James Daltons Lands represented in Orange tint.
J.T. York's Lands represented in Green tint.

CERTIFICATE OF SURVEYOR.

I, C.M. Foster of Baker, Oregon, do hereby certify that this map was made from private surveys made at various dates and from my knowledge of the country and from data obtained from the U.S. Geological Survey of the country represented hereon and that it correctly represents the works described in the accompanying application, together with the location of streams and other ditches in the immediate vicinity, and has written thereon the area in each smallest legal subdivision which it is proposed to irrigate.

C.M. Foster
Surveyor.

OFFICE OF STATE ENGINEER

BIUCO

JUN 20 1911

SALE OFFICE

Application No. 1611

Reservoir Permit No. 132