

Polk Co. Regional Scale Map
 1 inch = 831 feet
 06/05/01

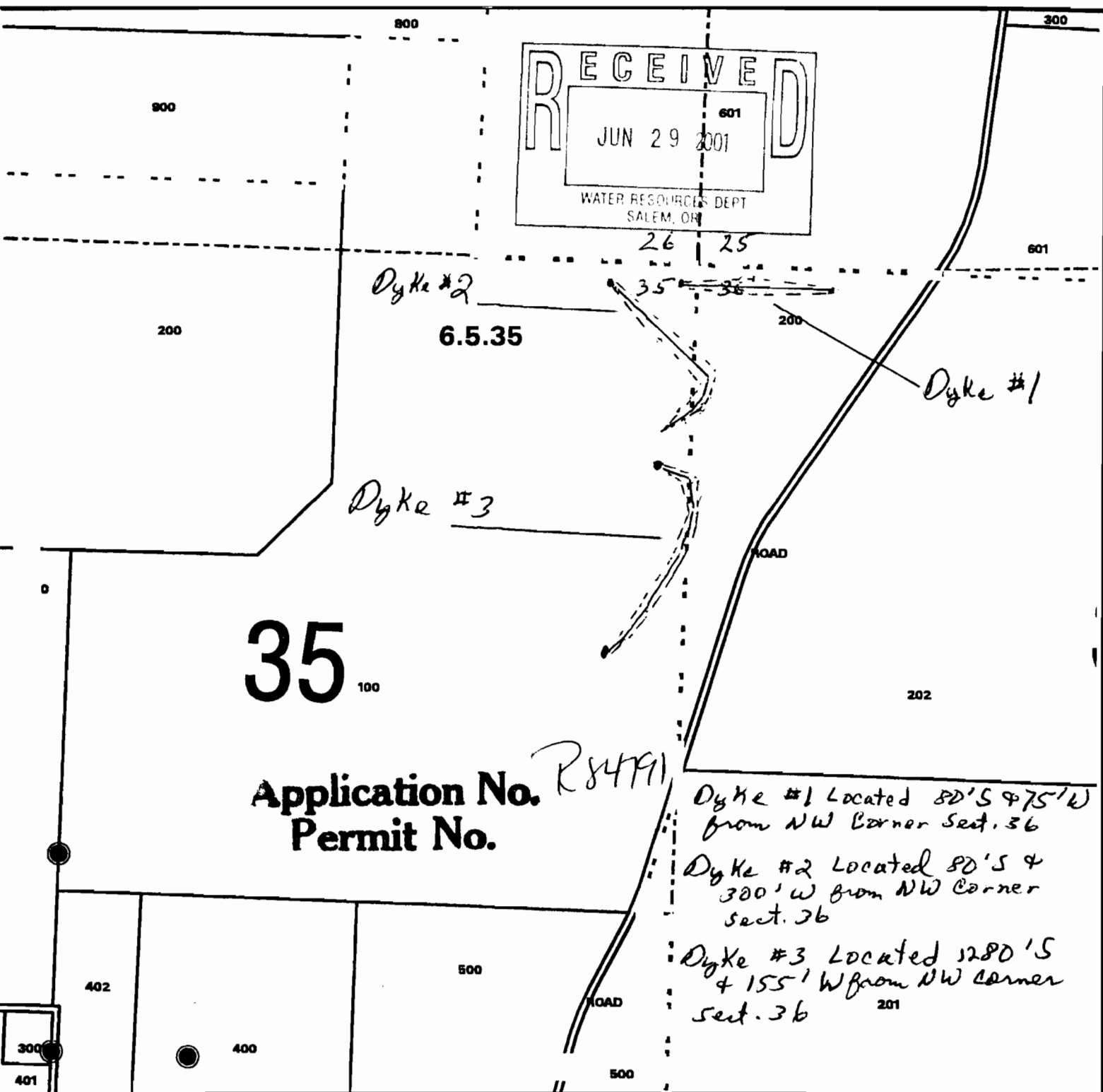
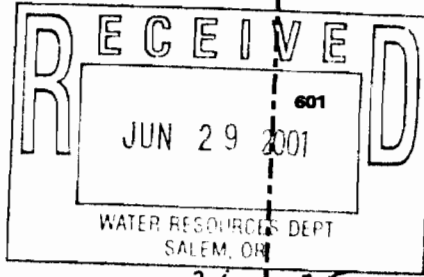

35

Application No.
Permit No.

R84911

*Dyke #1 Located 80'S & 75' W
 from NW Corner Sect. 36*

*Dyke #2 Located 80'S &
 300' W from NW Corner
 sect. 36*

*Dyke #3 Located 1280'S
 & 155' W from NW corner
 sect. 36*

Map Features & Feature Source
 PLS - USGS / Polk Co. Surveys
 Taxmap - Polk Co. Assessor Office

Map Location

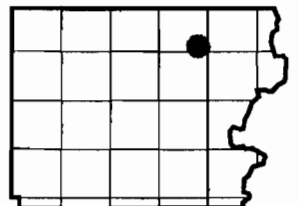

This map was produced from data stored in the Polk County Geographic database. The data originally came from the Assessor Taxdot Maps. The data is maintained by county to support its governmental activities. The county is not responsible for any map errors, possible misuse, or misinterpretations.

Map user: -Polk Co-Assessor

MAP
FIGURE
2

T 6 S
R 5 W
Sec 35 & 36
Tax lot 100 & 201
Polk Co., Ore

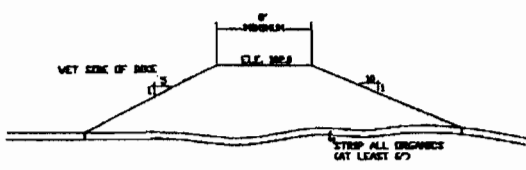

⊕ TYPICAL DIKE SECTION
(not to scale)

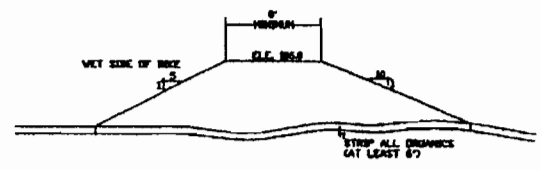

⊕ TYPICAL DIKE SECTION
(not to scale)

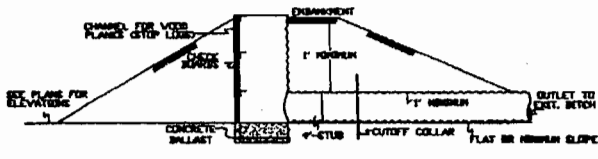

TYPICAL DIKE SECTION @ HALF RISER
(not to scale)

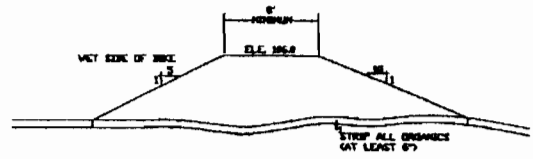

⊕ TYPICAL DIKE SECTION
(not to scale)

Application No. R84791
Permit No.

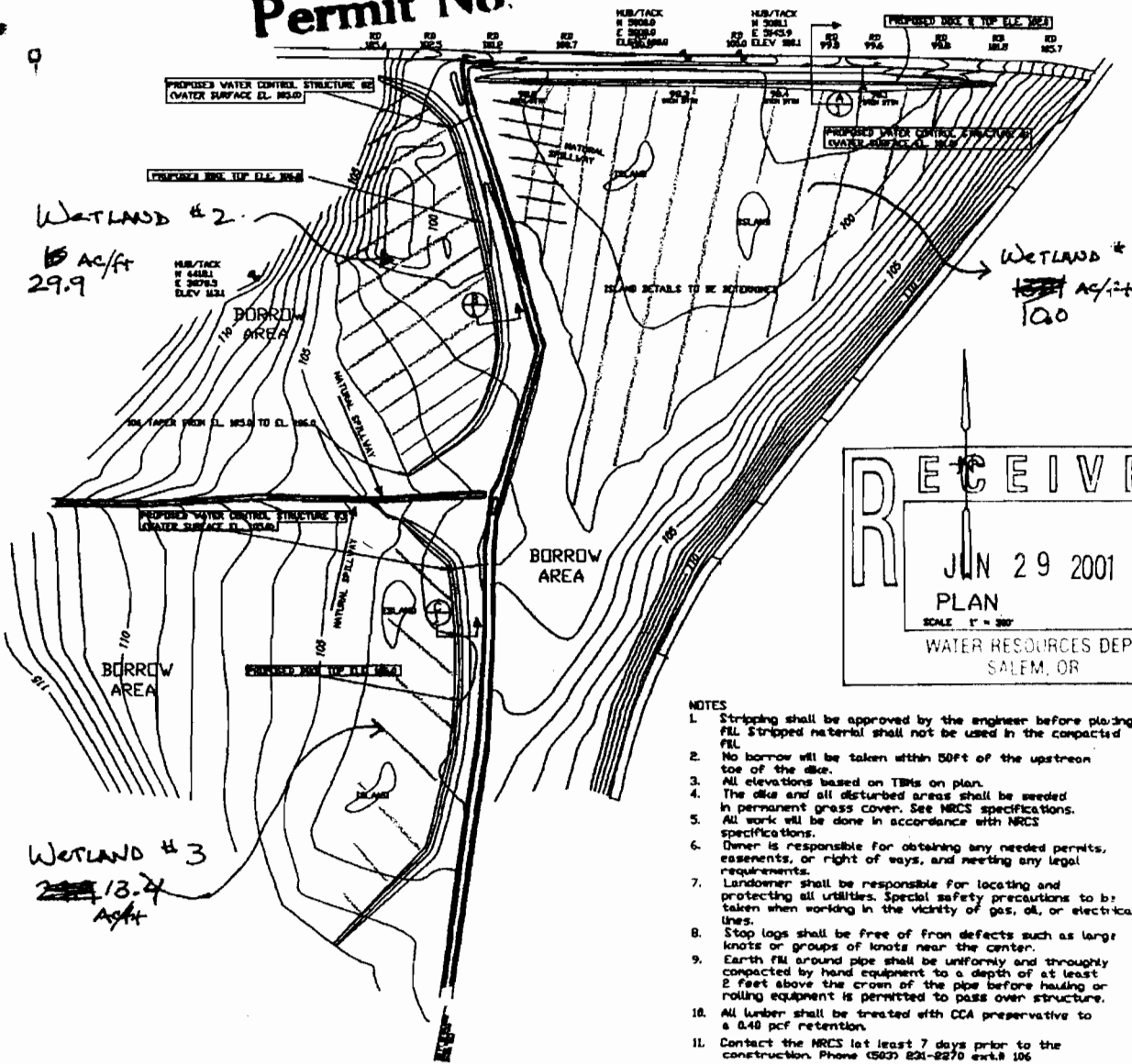

- NOTES
1. Stripping shall be approved by the engineer before placing fill. Stripped material shall not be used in the compacted fill.
 2. No borrow will be taken within 50ft of the upstream toe of the dike.
 3. All elevations based on TBM on plan.
 4. The dike and all disturbed areas shall be seeded in permanent grass cover. See NRCS specifications.
 5. All work will be done in accordance with NRCS specifications.
 6. Owner is responsible for obtaining any needed permits, easements, or right of ways, and meeting any legal requirements.
 7. Landowner shall be responsible for locating and protecting all utilities. Special safety precautions to be taken when working in the vicinity of gas, oil, or electrical lines.
 8. Strip logs shall be free of iron defects such as large knots or groups of knots near the center.
 9. Earth fill around pipe shall be uniformly and thoroughly compacted by hand equipment to a depth of at least 2 feet above the crown of the pipe before hauling or rolling equipment is permitted to pass over structure.
 10. All lumber shall be treated with CCA preservative to a 0.40 pcf retention.
 11. Contact the NRCS at least 7 days prior to the construction. Phone (503) 831-8270 ext. 106

DRAFT

DRAFT

DESIGNED BY: RON MARX WRP
DRAWN BY: POLK COUNTY SOIL AND WATER CONSERVATION DISTRICT
USDA NATURAL RESOURCES CONSERVATION SERVICE

Designed	PLM	DATE	2/15
Drawn	PLM	DATE	2/15
Checked		DATE	
Approved		DATE	