

Township 11 S, Range 15 E.W.M.

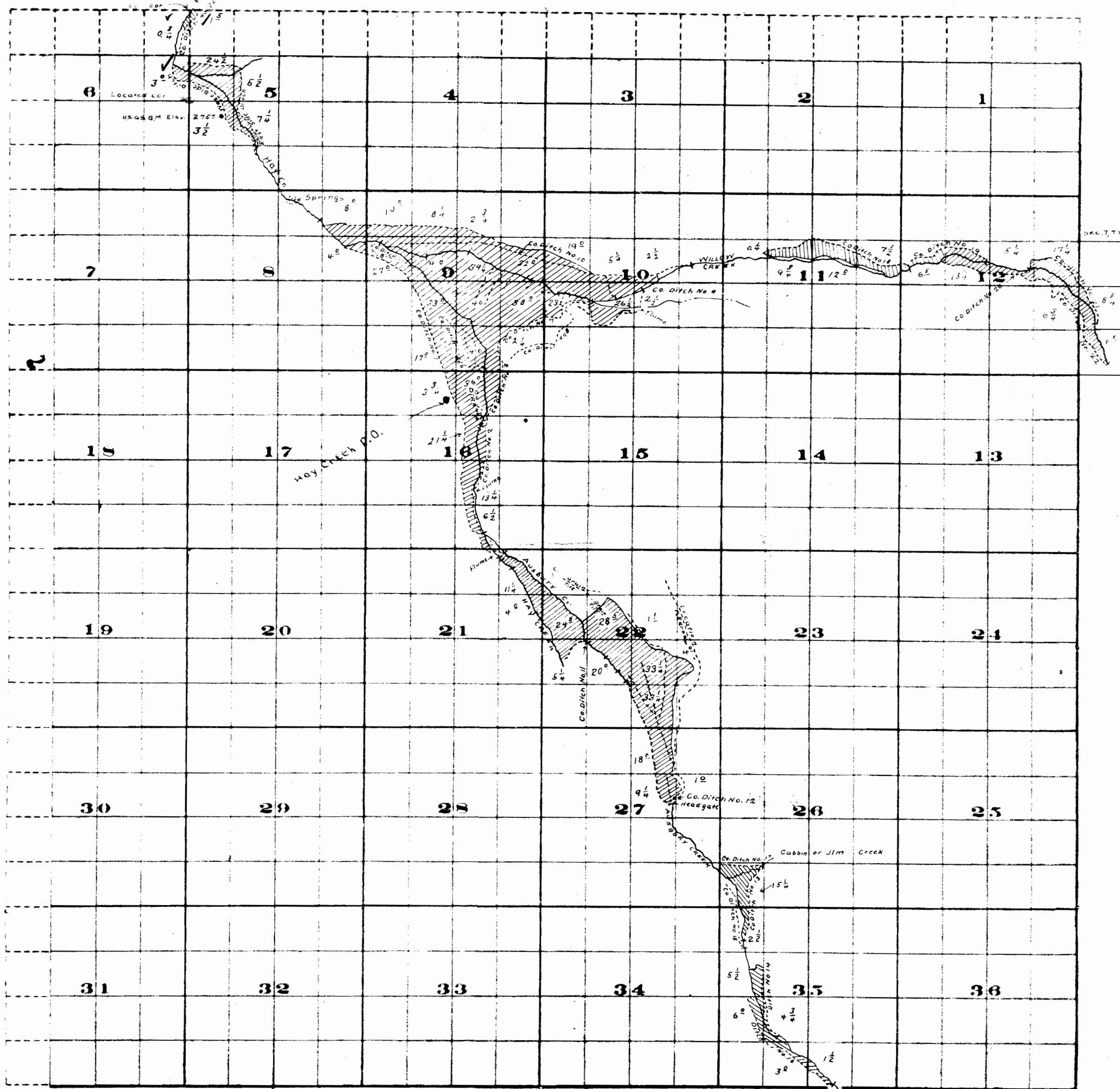

Survey Sept. 17-23, 1915

FROM OFFICE OF THE STATE ENGINEER, SALEM, OREGON

- LEGEND**
- Irrigated land with areas
 - Streams
 - Ditches
 - Dams

Scale of Feet

DO NOT SEND OUT
OF OFFICE OF STATE
ENGINEER

Adjudication Survey
Trout Creek
and
Tributaries

App. No.
Permit No.

APP. NO. 26226
 R-26226
 26226
 R-1333
 21403

Township 10 S, Range 15 E.W.M.

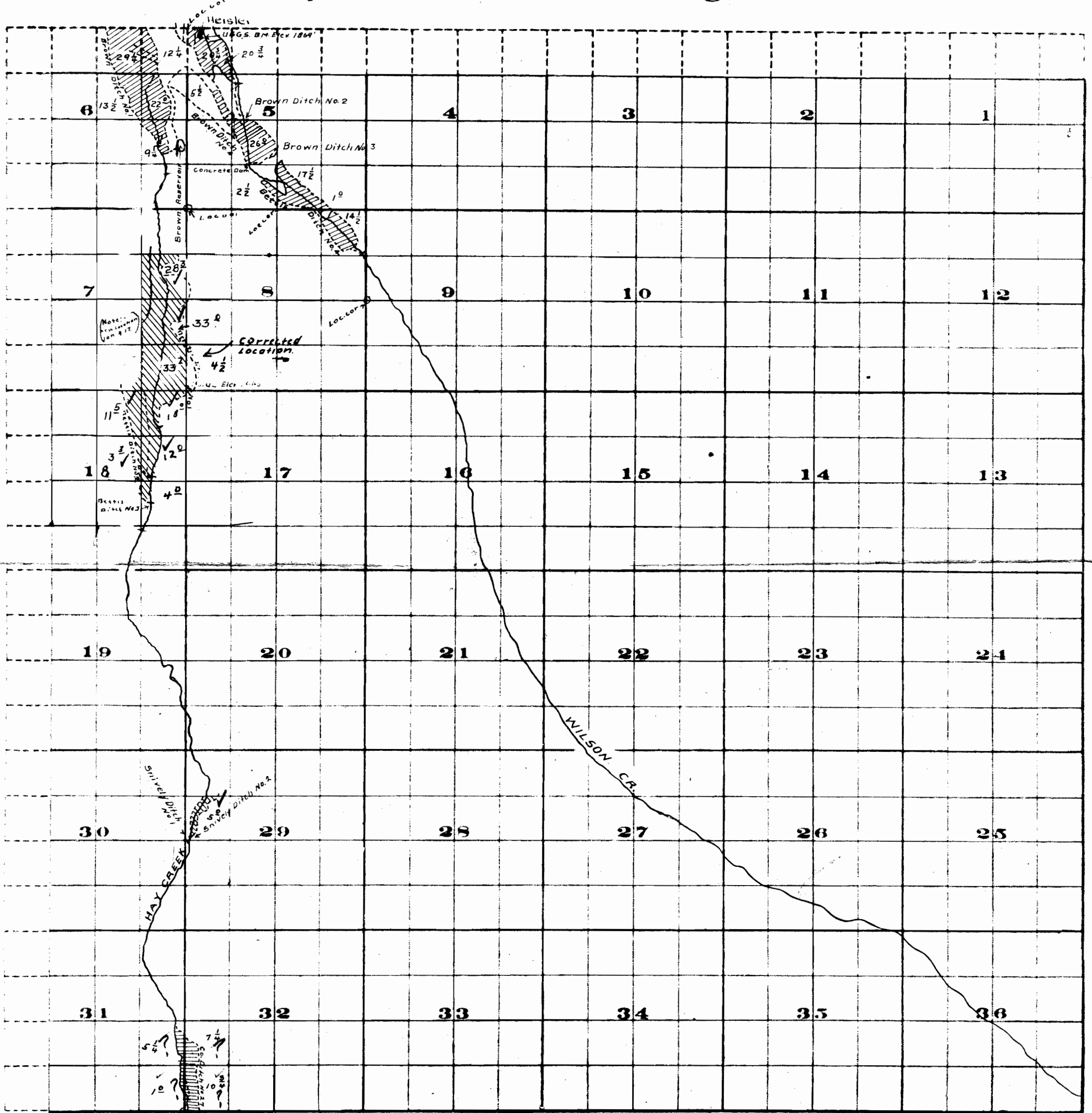

Capacity of Brown Res. 40 ac.ft.

Survey Sept 21-23, 1915

FROM OFFICE OF THE STATE ENGINEER, SALEM, OREGON

Adjudication Survey
Trout Creek
and
Tributaries

LEGEND
 Irrigated land with area
 Streams
 Ditches

**DO NOT SEND OUT
OF OFFICE OF STATE
ENGINEER**

APP No. 26226
LITTLE WILLOW

App. No. R-26225
 Permit No. 26226
 R-1333
 21403

RECEIVED
JUL 18 1962
STATE ENGINEER
SALEM, OREGON

MAP TO ACCOMPANY APPLICATION
FOR PERMIT TO APPROPRIATE
PUBLIC AND UNDERGROUND WATERS

IN THE NAME OF
FRED W. WICKMAN
HAY CREEK, OREGON

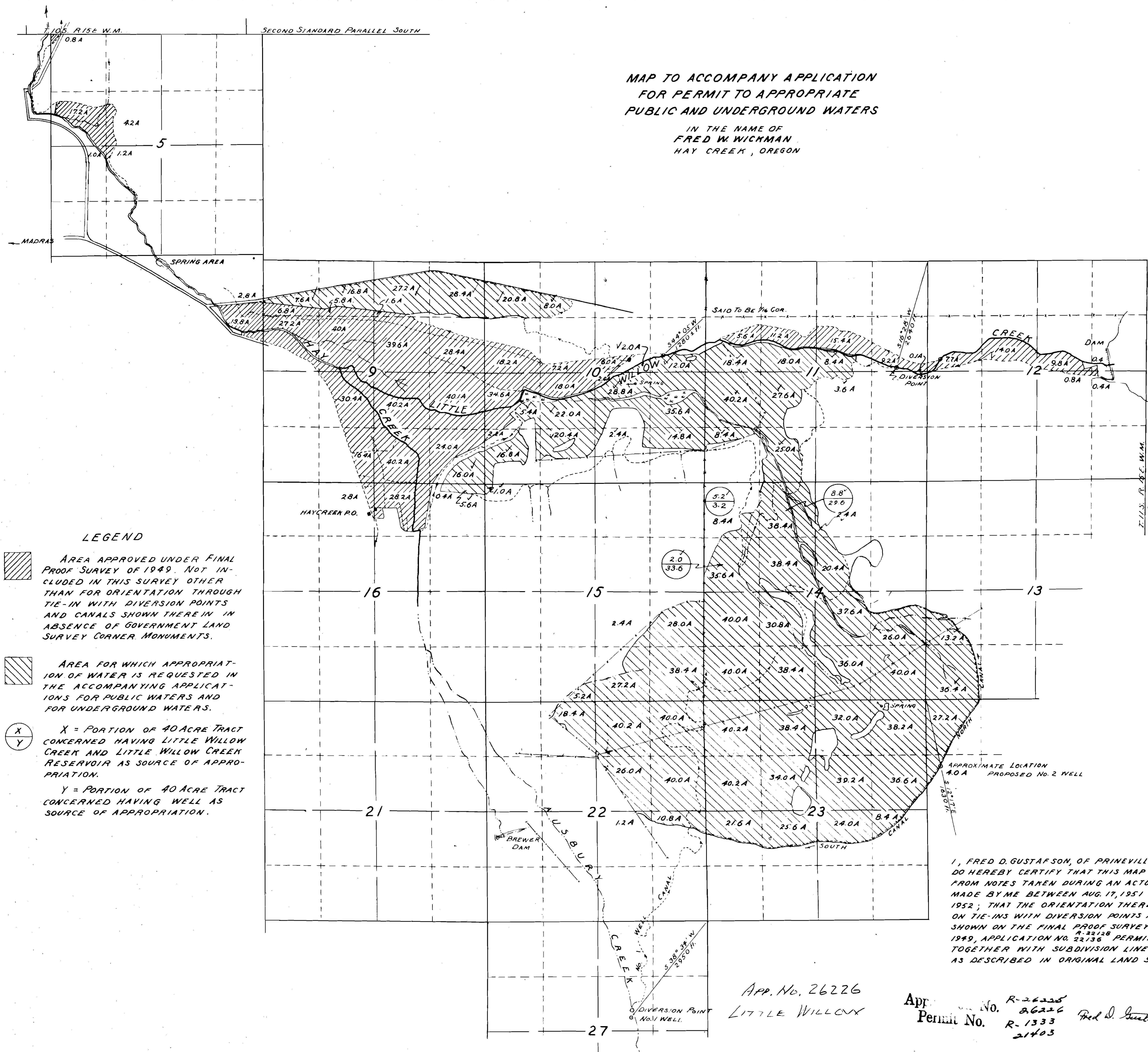

LEGEND

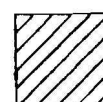
 AREA APPROVED UNDER FINAL PROOF SURVEY OF 1949. NOT INCLUDED IN THIS SURVEY OTHER THAN FOR ORIENTATION THROUGH TIE-IN WITH DIVERSION POINTS AND CANALS SHOWN THEREIN IN ABSENCE OF GOVERNMENT LAND SURVEY CORNER MONUMENTS.

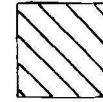
 AREA FOR WHICH APPROPRIATION OF WATER IS REQUESTED IN THE ACCOMPANYING APPLICATIONS FOR PUBLIC WATERS AND FOR UNDERGROUND WATERS.

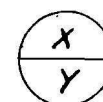
 X = PORTION OF 40 ACRE TRACT CONCERNED HAVING LITTLE WILLOW CREEK AND LITTLE WILLOW CREEK RESERVOIR AS SOURCE OF APPROPRIATION.
Y = PORTION OF 40 ACRE TRACT CONCERNED HAVING WELL AS SOURCE OF APPROPRIATION.

I, FRED D. GUSTAFSON, OF PRINEVILLE, OREGON DO HEREBY CERTIFY THAT THIS MAP WAS MADE FROM NOTES TAKEN DURING AN ACTUAL SURVEY MADE BY ME BETWEEN AUG. 17, 1951 AND MAY 7, 1952; THAT THE ORIENTATION THEREOF IS BASED ON TIE-INS WITH DIVERSION POINTS AND STREAMS SHOWN ON THE FINAL PROOF SURVEY MAP OF 1949, APPLICATION NO. 22136 PERMIT NO. 17530 TOGETHER WITH SUBDIVISION LINES PROJECTED AS DESCRIBED IN ORIGINAL LAND SURVEY NOTES.

APP. NO. 26226
LITTLE WILLOW

App. No. R-26226
Permit No. R-1333
21403
Fred D. Gustafson