

Application No. R-85108

Permit No.

T.18S. R.12W. Sec. 23

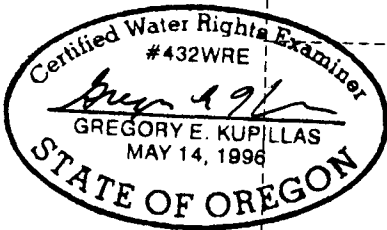
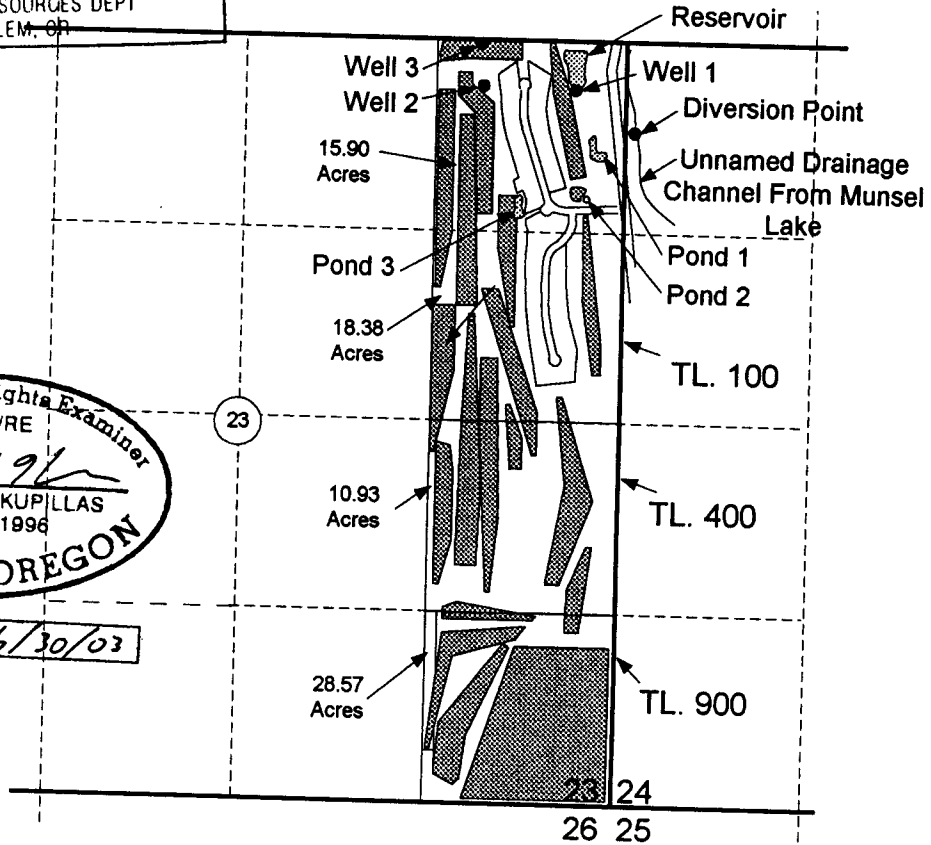
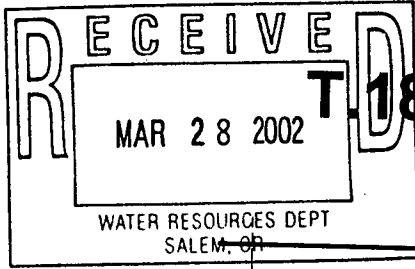

EXPIRATION DATE: 6/30/03

Diversion Point is located 625 feet south and 50 feet east of the northeast corner of Section 23. Proposed Well 1 is located 325 feet south and 350 feet west of the northeast corner of Section 23. Proposed Well 2 is located 300 feet south and 970 feet west of the northeast corner of Section 23. Proposed Well 3 is located 30 feet south and 1,010 feet west of the northeast corner of Section 23. The Reservoir is located 175 feet south and 350 feet west of the northeast corner of Section 23. Pond 1 is located 750 feet south and 200 feet west of the northeast corner of Section 23. Pond 2 is located 1,090 feet south and 260 feet west of the northeast corner of Section 23. Pond 3 is located 1,150 feet south and 730 feet west of the northeast corner of Section 23.

- Area ( 73.78 Acres) to be irrigated.
Pond or Reservoir

Scale: 1" = 1,320'

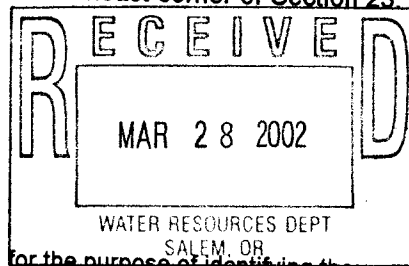
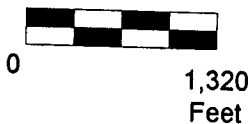

This map was prepared for the purpose of identifying the location of a water right only and is not intended to provide legal dimensions or location of property ownership lines.



Water Right Application Map

Pacific Hydro-Geology Inc.

Ocean Dunes Golf Links
T.18 S. R.12W. Sec. 23 Tax Lots 100, 400, and 900