

SCALE 1" = 200'

T18 R4 W SEC 6

SE 1/4 SE 1/4

RECEIVED
OCT 28 2002

WATER RESOURCES DEPT.
SALEM, OREGON

RECEIVED

NOV 19 2002

WATER RESOURCES DEPT.
SALEM, OREGON

SECTION LINE

Permit # R-13538

App # R-85347

6

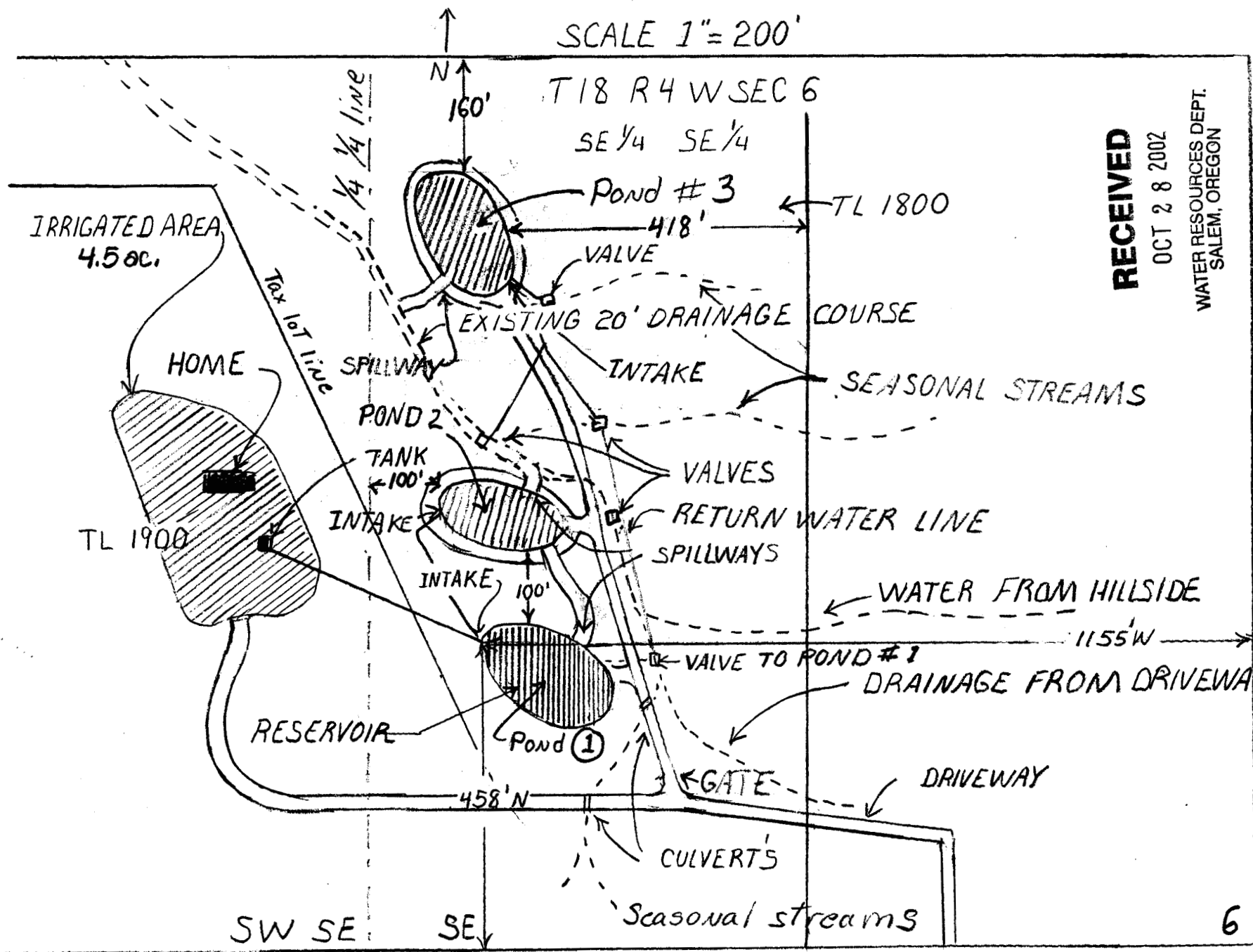

IRRIGATED AREA
4.5 ac.

HOME

Pond #3

TL 1800

VALVE

EXISTING 20' DRAINAGE COURSE

INTAKE

SEASONAL STREAMS

SPILLWAY

POND 2

TANK

VALVES

RETURN WATER LINE

INTAKE

SPILLWAYS

WATER FROM HILLSIDE

TL 1900

INTAKE

100'

VALVE TO POND #1

DRAINAGE FROM DRIVEWAY

RESERVOIR

Pond #1

458' N

GATE

DRIVEWAY

SW SE

SE

Seasonal streams

SECTION LINE

SE SECTION COR

GRAND OAKS RESERVOIRS

DRAWN - MW