

APPLICATION MAP FOR PERMIT TO ENLARGE A RESERVOIR

SW1/4 SW1/4 SEC 29 T 22S R 41E W.M.

U.S.G.S. QUAD - RUFIND BUTTE, OREG. - 7 1/2'

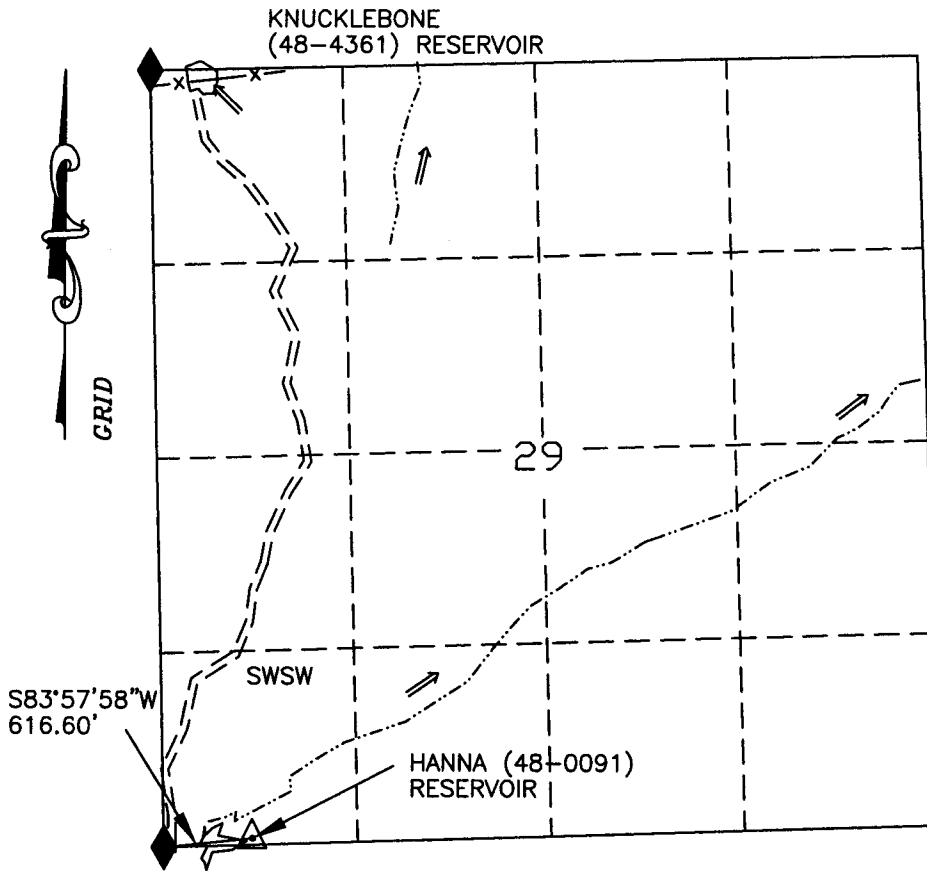

LEGEND

- RESERVOIR
- ROAD
- CHANNEL
- FD SEC COR
- FENCE
- PROJECT MON.

HANNA (48-0091) RESERVOIR

RECEIVED

DEC 09 2002

WATER RESOURCES DEPT.
SALEM, OREGON

app # R-85395
Permit # R-13573



SCALE 1"=1320'

THIS MAP IS FOR THE PURPOSE OF LOCATING
A WATER RIGHT AND IS NOT INTENDED TO
PROVIDE LEGAL DIMENSIONS FOR LOCATION
OF PROPERTY BOUNDARIES.



UNITED STATES DEPARTMENT OF THE INTERIOR
BUREAU OF LAND MANAGEMENT
DIVISION OF OPERATIONS VALE DISTRICT

HANNA (48-0091)
RESERVOIR

DESIGNED _____
REVIEWED *John E. Hall*
APPROVED *Thomas Henry*
CHIEF, BRANCH OF ENGINEERING

DRAWN: CG SCALE: 1"=1320'

DATE: 11/07/02 SHEET 1 OF 1

DRAWING NO. OR-03-9172.45-1159

ACAD2000
DWG FILE: HANNA.DWG