

Union County; T 6S; R 39E; Sec 17; NE/SE; Tax Lot # 2600

Dam 1 = 1605' N, 20' W of the SE corner of Sec 17

Dam 2 = 1660' N, 360' W of the SE corner of Sec 17

Dam 3 = 1750' N, 660' W of the SE corner of Sec 17

1" = 1320'

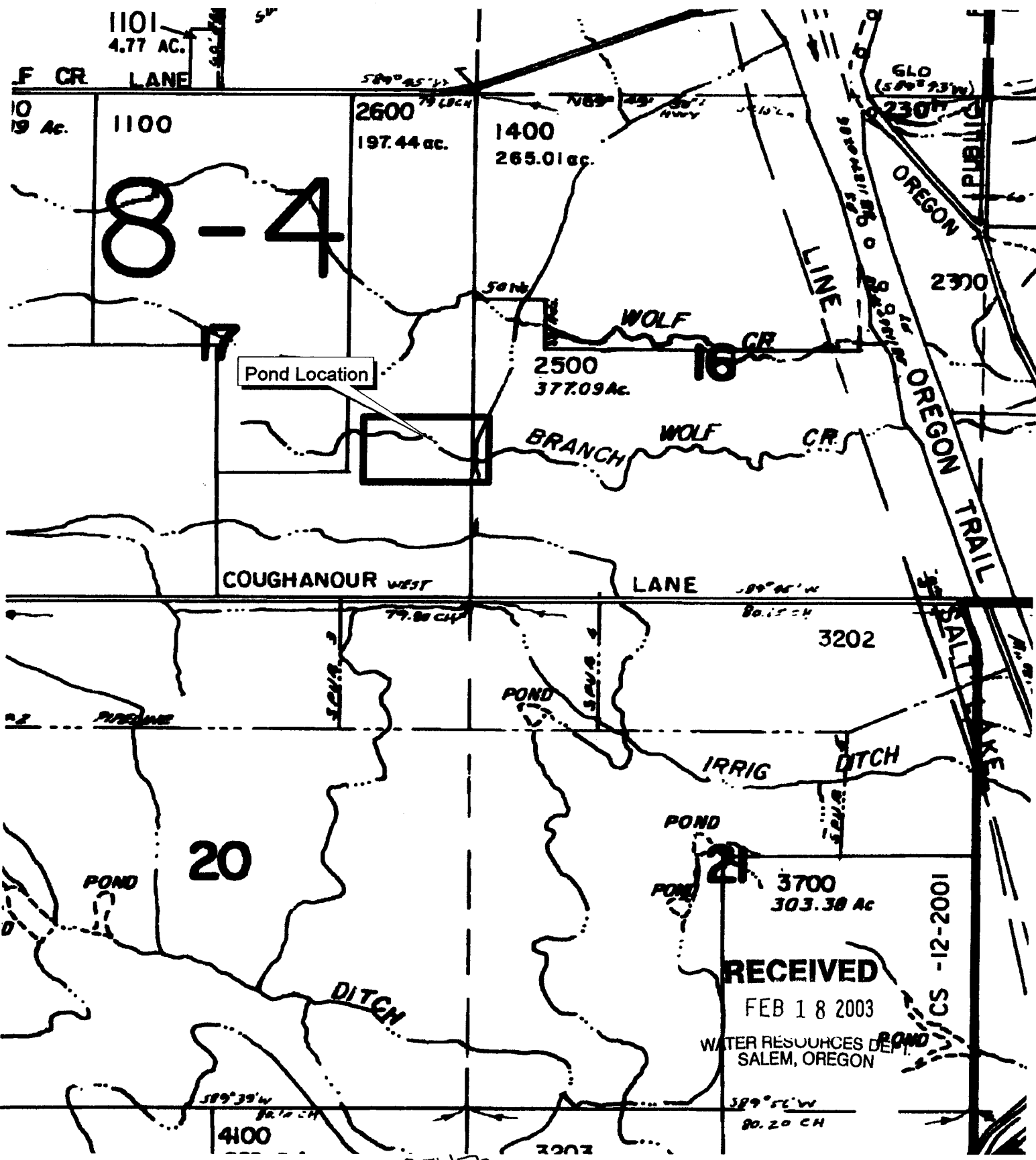

App # R-85472
Permit # R-13617