

APPLICATION MAP

IN THE NAME OF: U.S. FISH AND WILDLIFE SERVICE

Place of Use: SENE, NWSE, Section 18,

T. 2 S., R. 1 W., W.M.

WASHINGTON COUNTY, OREGON

RECEIVED

APR 24 2003

WATER RESOURCES DEPT.
SALEM, OREGON

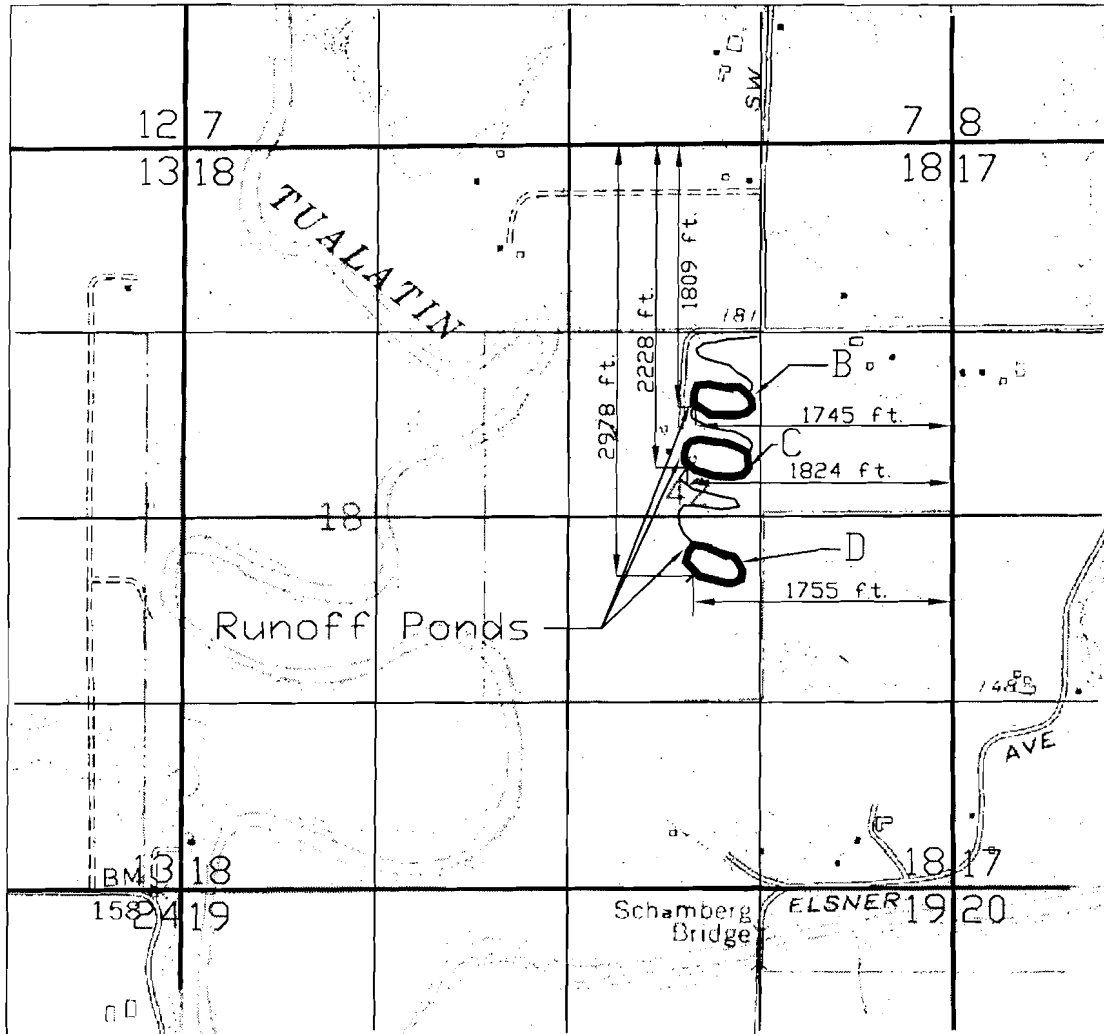

1" = 1320'

PDD Runoff B: 1745 ft West and 1809 ft South of the NE Corner of Sec. 18, T 2 S, R 1 W

PDD Runoff C: 1824 ft West and 2228 ft South of the NE Corner of Sec. 18, T 2 S, R 1 W

PDD Runoff D: 1755 ft West and 2978 ft South of the NE Corner of Sec. 18, T 2 S, R 1 W

app no R-85572 Permit No-R-13732