

T7S R11W WM

LINCOLN COUNTY

TAX LOT:
07 11 11 CC 00100
07 11 11 CC 00200
07 11 11 CB 03200

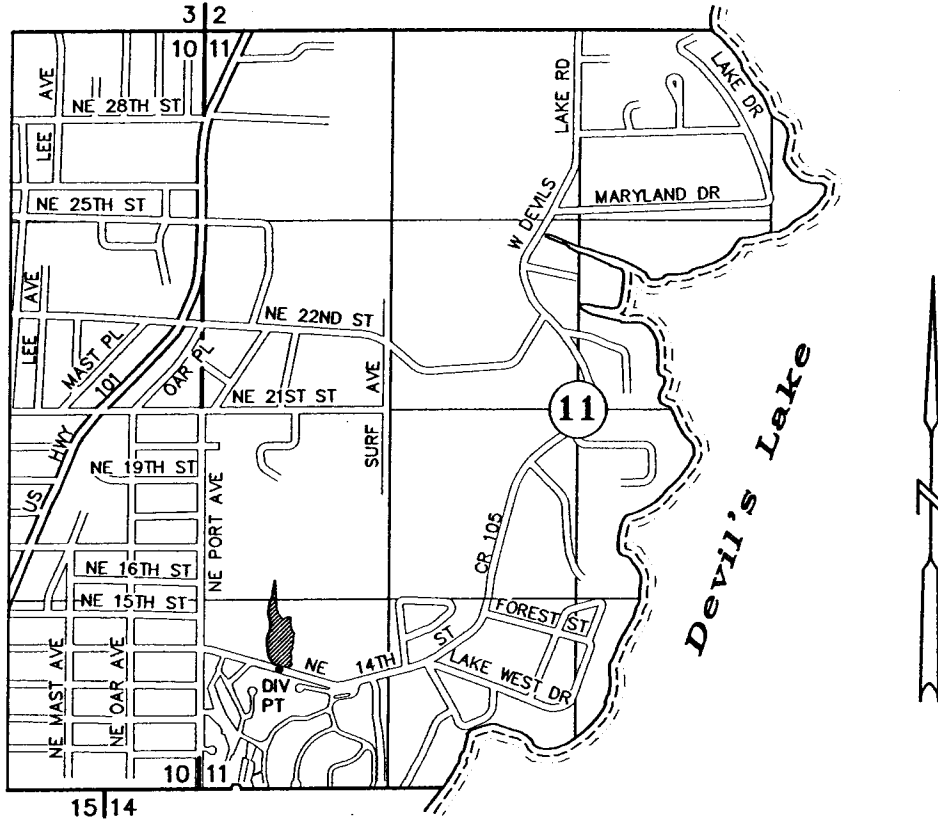

DIV. PT.: 532' S. AND 526' E. OF THE 1/16 CORNER SECTIONS 10 & 11.

APPLICATION TO CONSTRUCT A RESERVOIR

Application No. R-85474

Permit No. R-13774

CITY OF LINCOLN CITY

JANUARY 13, 2003
SCALE: 1" = 1320'

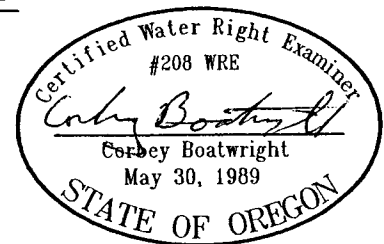

NOTE: This map is for the purpose of identifying the location of water rights and has no intent to dimension or locate property ownership lines.

RECEIVED

MAR 19 2003

WATER RESOURCES DEPT.
SALEM, OREGON

Expires: 12/31/2003