

T.4S., R.2.W, W.M

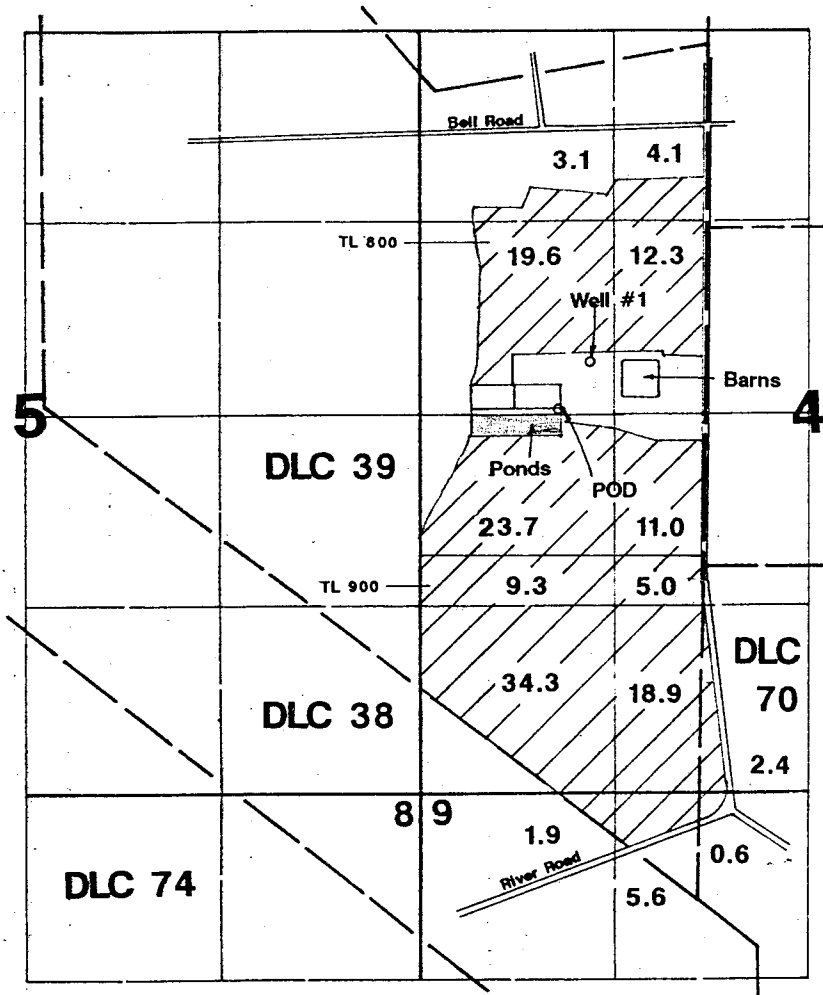

Well #1 located 1400'N & 800'W
 POD located 1100'N & 1000'W--both from the NW corner DLC 70.

Application Map

Sar-Ben Farms

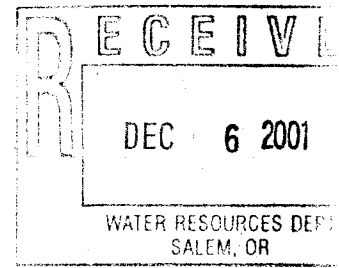

Application #:

Permit #:

Application No. 84984
 Permit No. R-14009

This Map Was Prepared For The Purpose of Showing the location of a Water Right Only and is Not Intended to Provide Legal Dimensions or Location of Property Owners' Interests.

