

T.22 S., R. 33 E., W.M.

MAP TO ACCOMPANY APPLICATION
For PERMITS
In the Name of
Bo Thorenfeldt

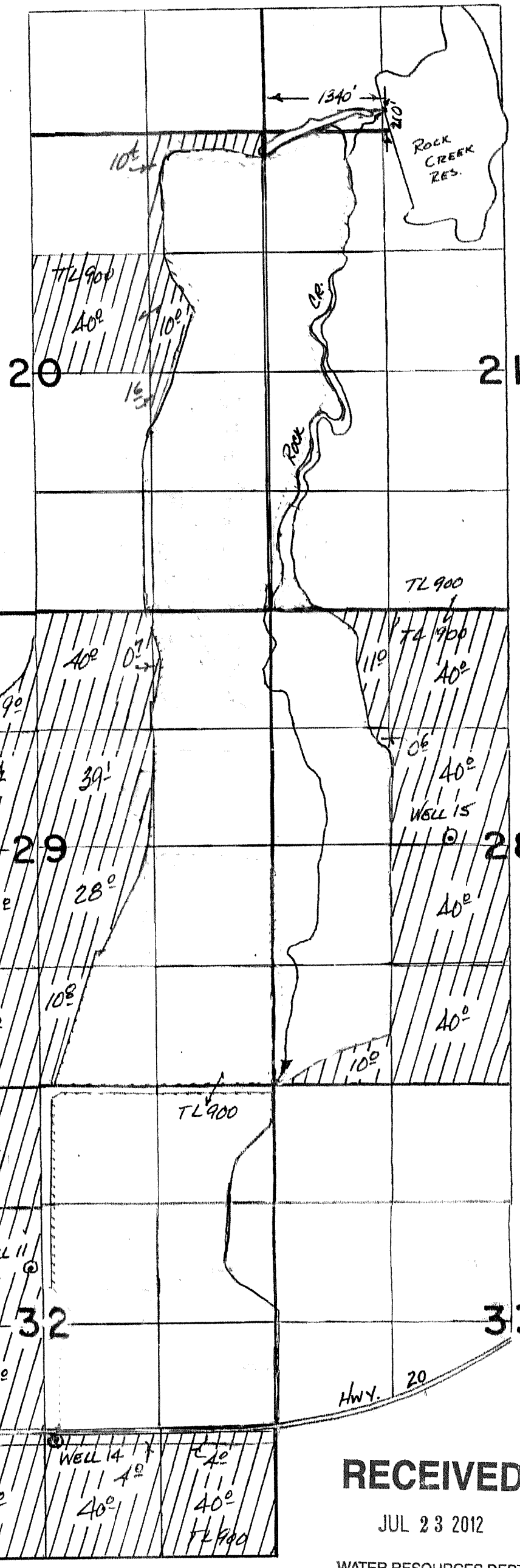
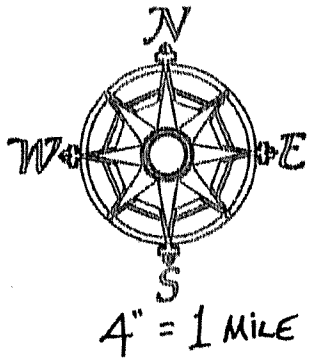

RECEIVED

JUL 23 2012

WATER RESOURCES DEPT
SALEM, OREGON

This map is for the purpose of identifying the location of water rights only, and is not intended to provide legal dimensions or locations of property lines.

2012 *Ma*

2-87922