

RECEIVED  
 JUN 01 2004  
 WATER RESOURCES DEPT  
 SALEM, OREGON

07

Section Boundary

06

**WETLAND MITIGATION AREA 2 (Campus), 0.63 acre—feet:**  
 Mitigation wetland is located in SW $\frac{1}{4}$  of SE $\frac{1}{4}$  Section 5 & NW $\frac{1}{4}$  of NE $\frac{1}{4}$  of Section 08, Township 08S Range 02E, Tax Lot 100 & 1900.  
 Center of mitigation wetland is 200 feet bearing 95 deg. from Section 5 & 8  $\frac{1}{4}$  corner.

Marion County, Oregon Tax  
 Assessors Maps Township 8S,  
 Range 2W, Sections 5 & 8

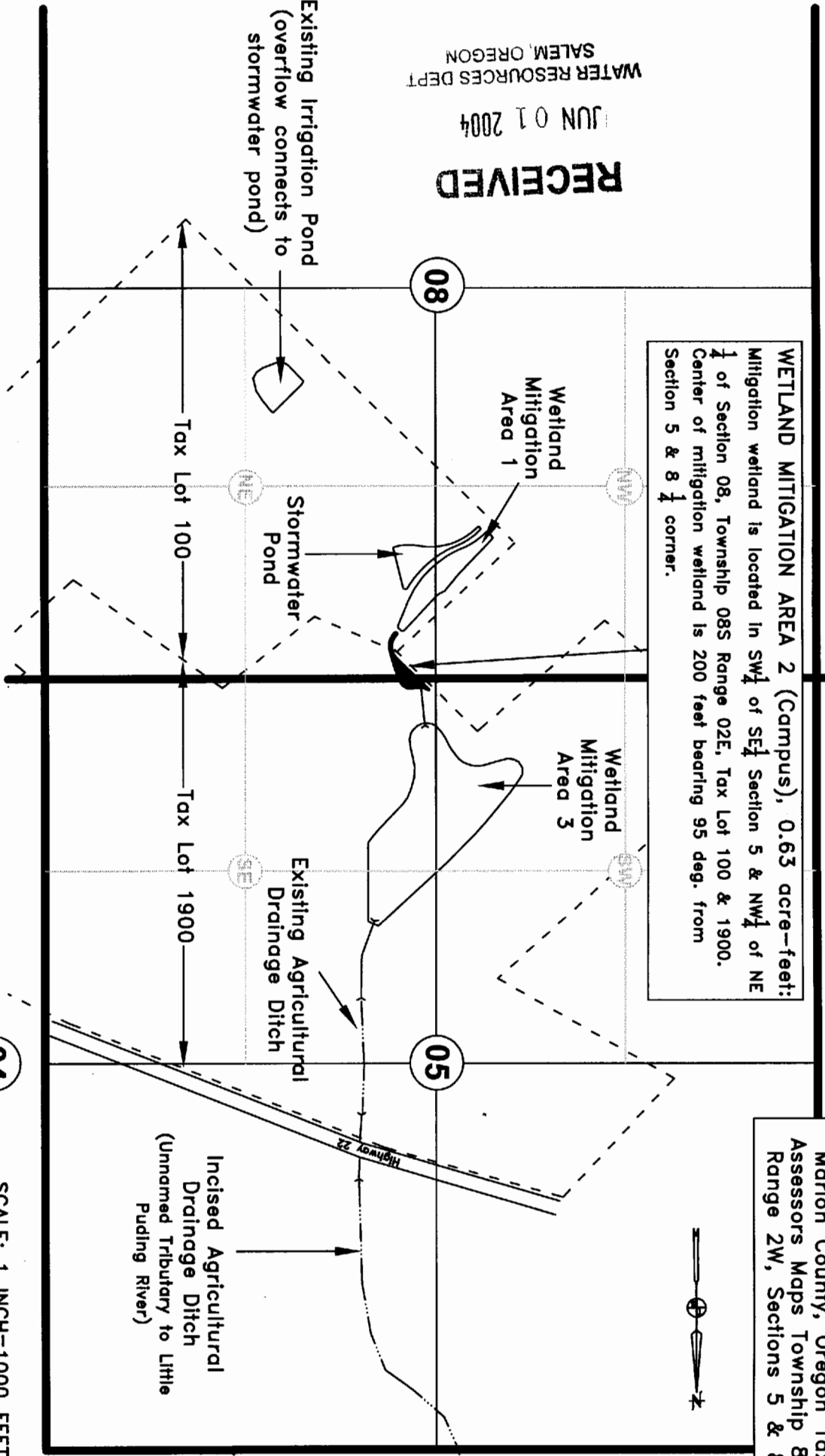

SCALE: 1 INCH=1000 FEET  
 0 500 1000 2000

Terra Science, Inc.  
 Soil, Water, & Wetland Consultants

May 2004

WATER RIGHTS APPLICATION FOR THE  
 OREGON DEPARTMENT OF PUBLIC SAFETY  
 STANDARDS AND TRAINING CAMPUS  
 COMPENSATORY WETLAND MITIGATION  
 Salem, Marion County, Oregon

05 Section Number

1/4 Section Center

WETLAND MITIGATION AREA 2

FIGURE 2

app no. R 86017