

**RECEIVED**

MAR 03 2005

Silvies River-Junction 395 Section (Key #07219)  
Wetland Mitigation Site, Harney County Oregon  
T. 22 S., R. 31 E., Section 32, SE 1/4, SE 1/4 W. M., Tax Lot T-1197

**WATER RESOURCES DEPT  
SALEM, OREGON**

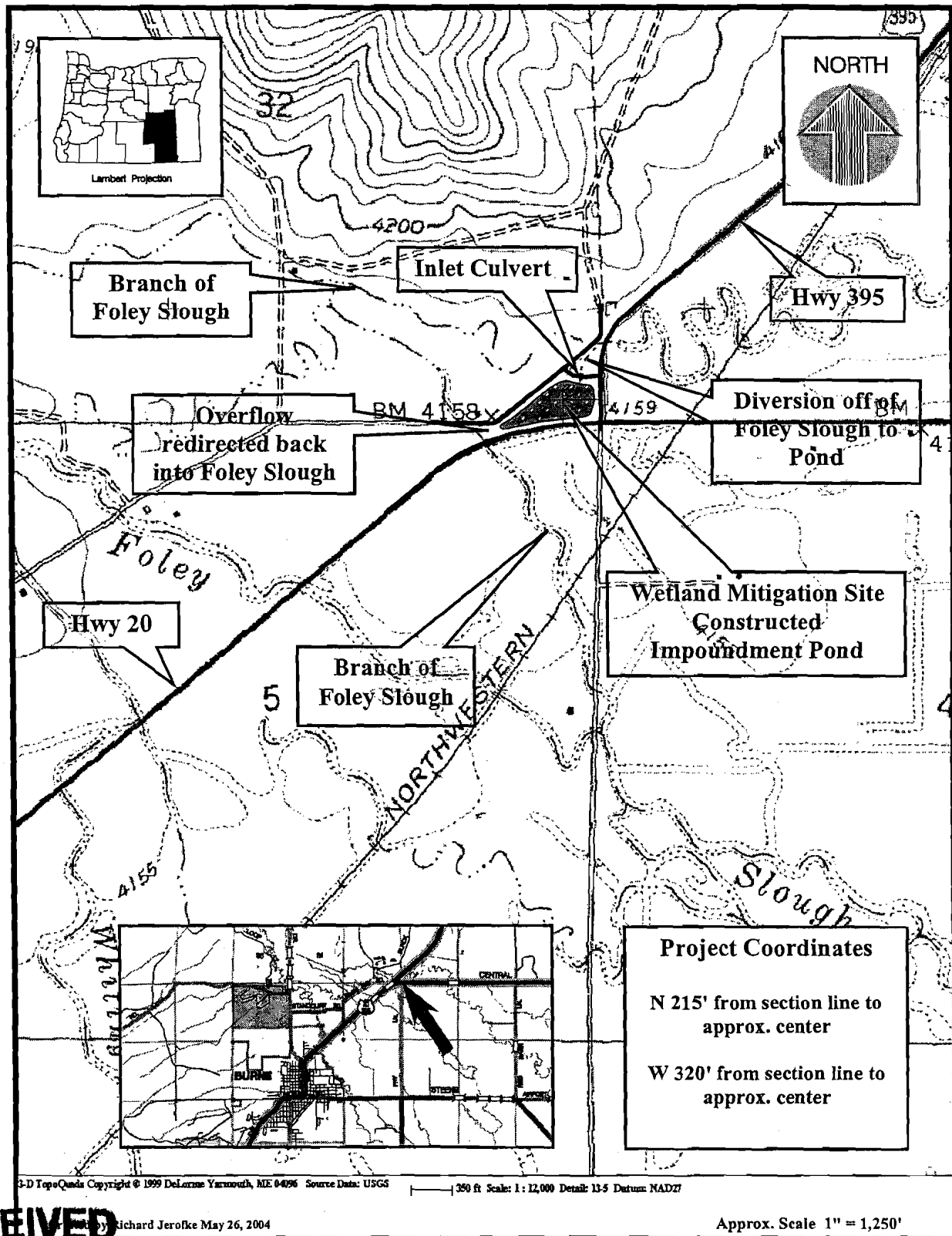

**RECEIVED**

MAR 23 2005

**WATER RESOURCES DEPT  
SALEM, OREGON**

Approx. Scale 1" = 1,250'