

T4S, R1W W.M.
SECTION 11
MARION COUNTY

1 INCH = 1320 FEET



RECEIVED

JAN 12 2005

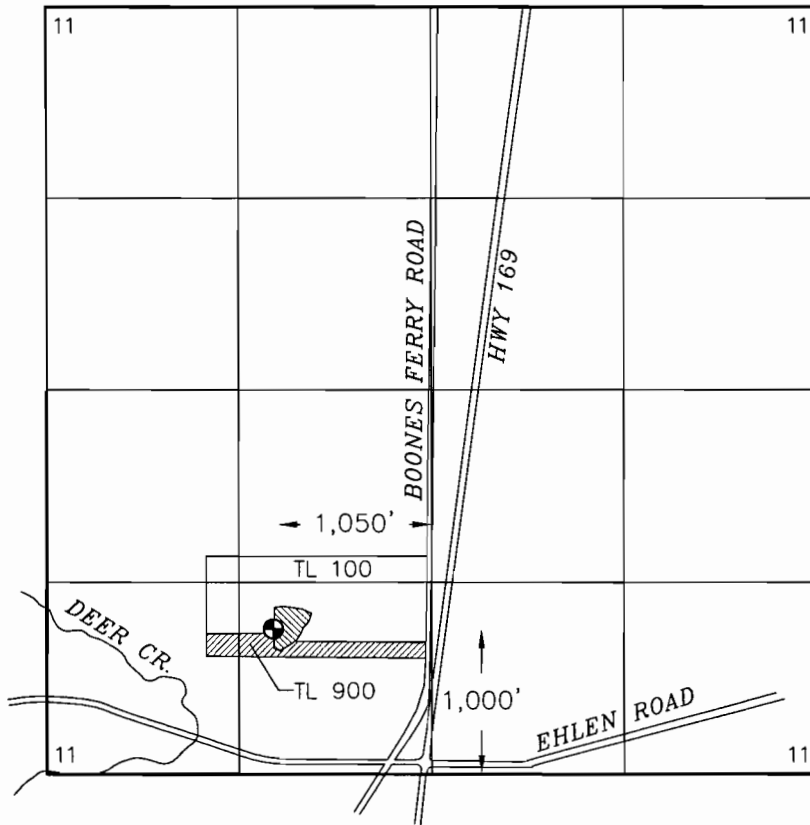
WATER RESOURCES DEPT
SALEM, OREGON



EXPLANATION:

-  IRRIGATION 4.0AC
-  RESERVOIR 1.3AC
-  POINT OF DIVERSION

app # R 86148

THIS MAP IS NOT INTENDED TO PROVIDE LEGAL
DIMENSIONS OR LOCATIONS OF PROPERTY OWNERSHIP LINES.



**APPLICATION MAP
WESTERN SUN LANDSCAPING**

FIGURE 1

PORT\p:\11294002\00\CAD\1129400200A.DWG EHZ:SYF 08/25/04