

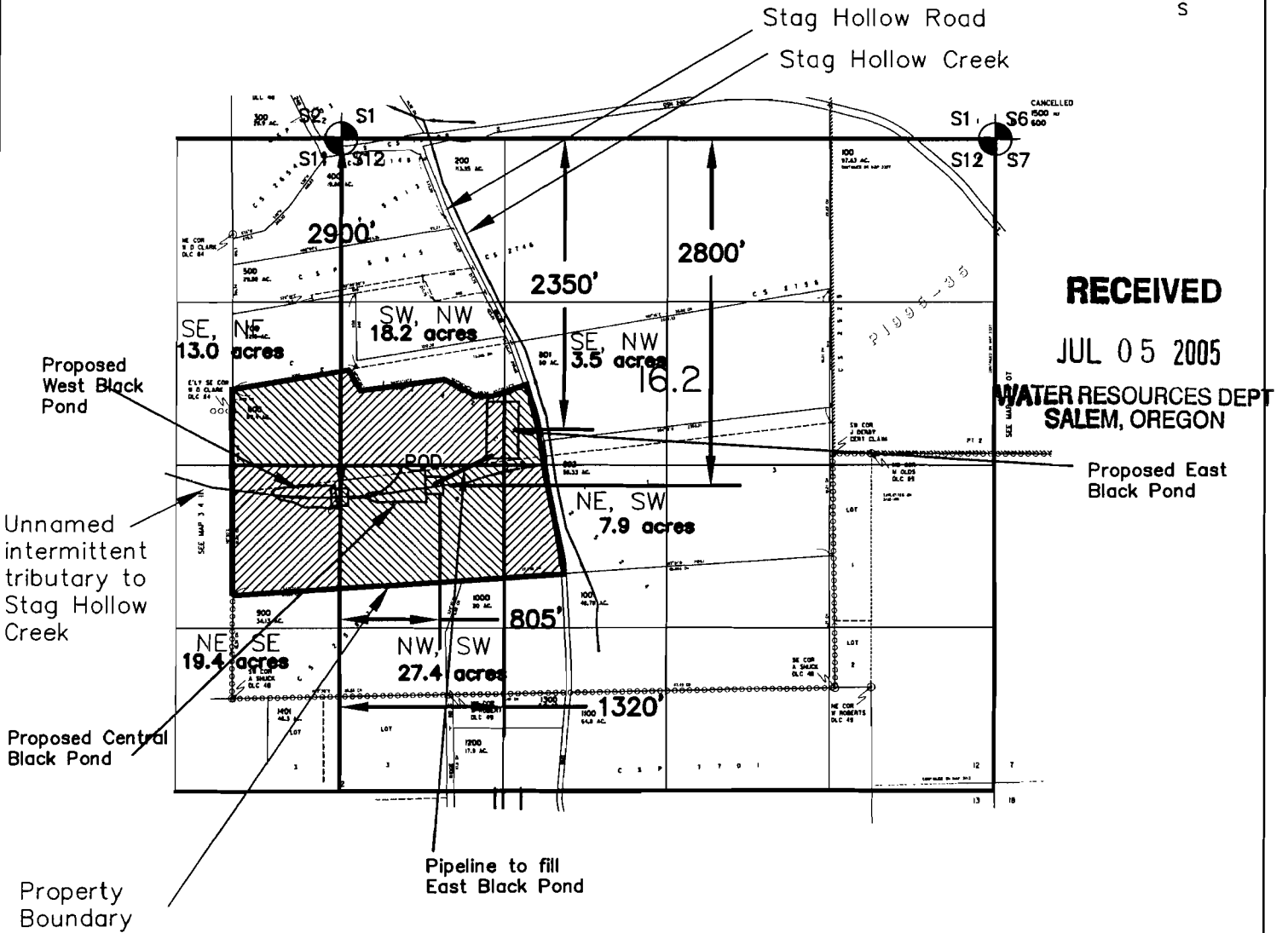

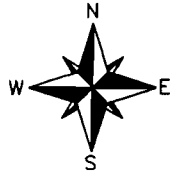

Water Rights Application Map

LOCATED IN TAX LOT 800, SECTION 12, T3S, R4W, WM.
YAMHILL COUNTY, OREGON



RECEIVED
JUL 05 2005
WATER RESOURCES DEPT
SALEM, OREGON

Application done for:
Black Family Vineyards

- LEGEND:**
-  Approximate Point of Diversion Locations
 -  Section corner used to scale tax assessor map and then USGS quad map.
 -  Maximum acres to be irrigated

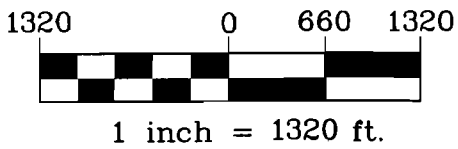

Distances based on scaled tax assessor map and USGS topo map.

appno R-86367
Permit RD



Project: 305-2-048
Drawing: 3052048A
By: URSTADT
Date: 25 MAY 2005