

# Water Rights Application Map

LOCATED IN TAX LOT 800, SECTION 12, T3S, R4W, WM.  
YAMHILL COUNTY, OREGON

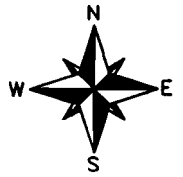

Stag Hollow Road  
Stag Hollow Creek

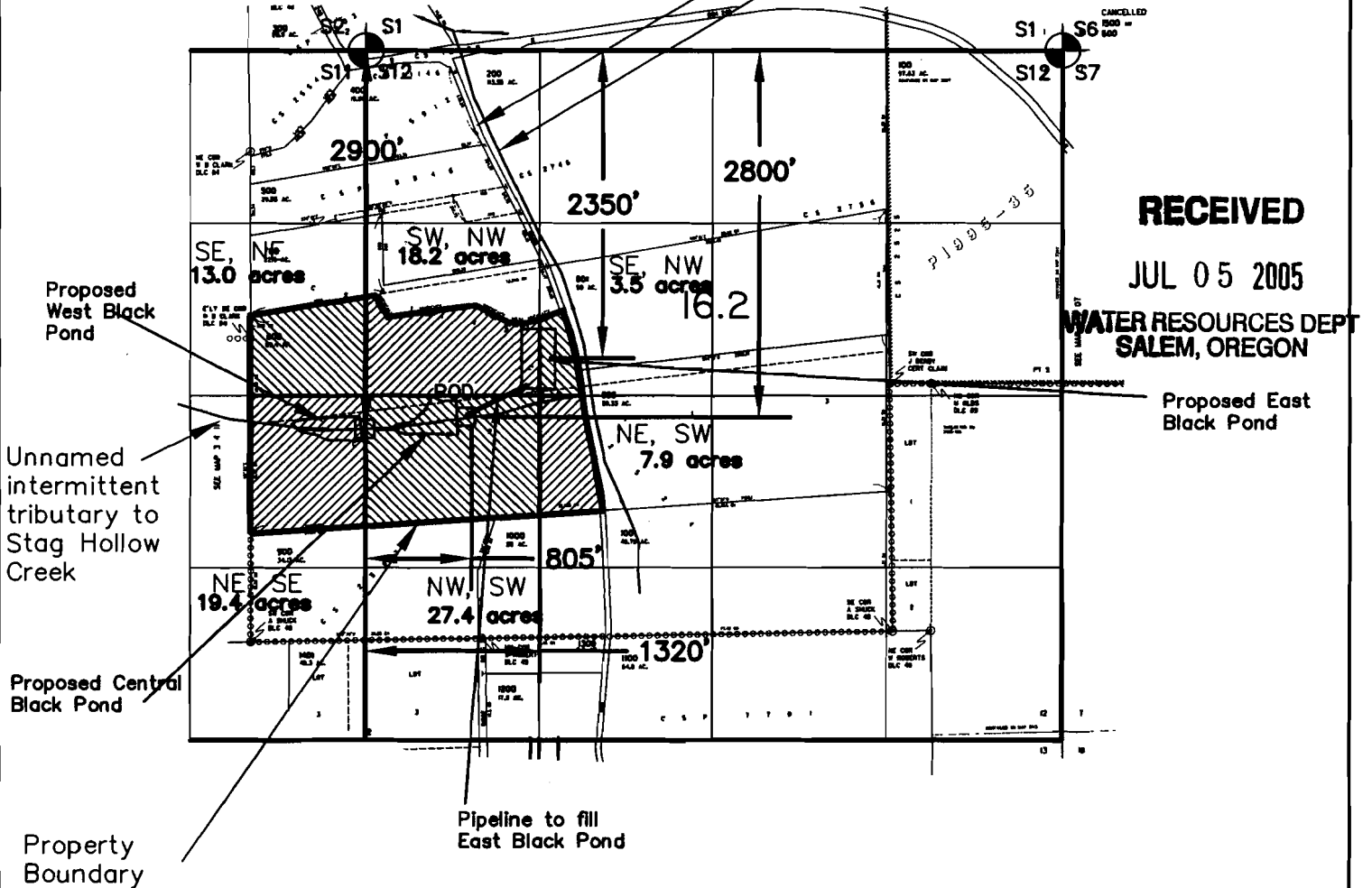



**RECEIVED**

JUL 05 2005

**WATER RESOURCES DEPT  
SALEM, OREGON**

Application done for:  
**Black Family Vineyards**

**LEGEND:**

-  Approximate Point of Diversion Locations
-  Section corner used to scale tax assessor map and then USGS quad map.
-  Maximum acres to be irrigated

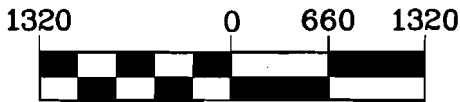

1 inch = 1320 ft.

Distances based on scaled tax assessor map and USGS topo map.

app no R 86369  
permut no R 14224



Project: 305-2-048  
Drawing: 3052048A  
By: URSTADT  
Date: 25 MAY 2005