

1/4 S R5W W.M.  
COUNTY

Scale 1" = 400'

34 S 5 W 17



5 8  
DCH.

8

9

NE 1/4  
CORNER

100-96  
380.00 Ac.

17

16

850' West  
and  
2650' South  
of NE 1/4  
Corner

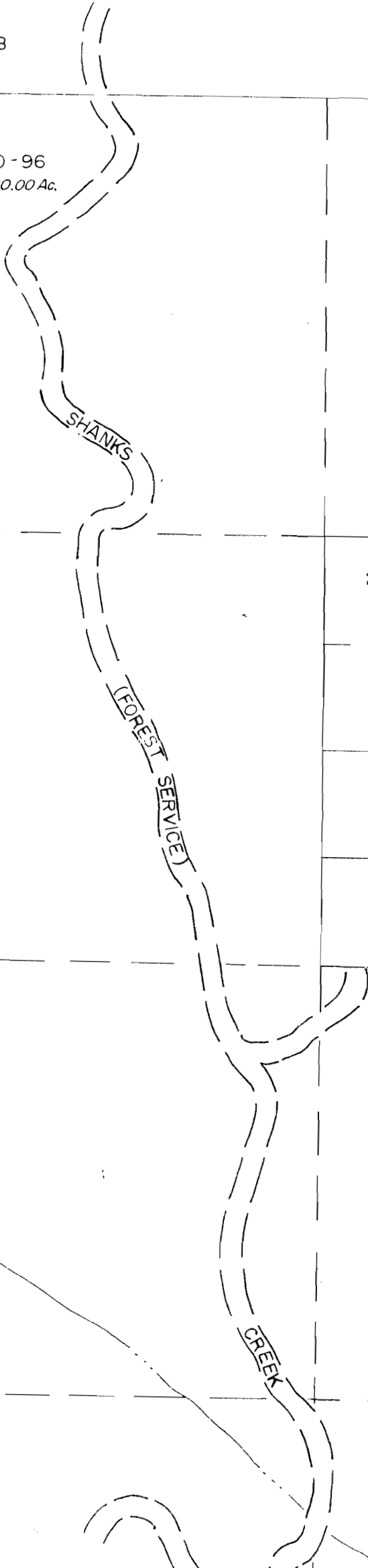

200  
15.00 Ac.

2650'

300  
15.00 Ac.

400  
10.00 Ac.

850'

Proposed  
pond

Unnamed  
Stream

SEE MAP 34 5

N 00° 09' 30" E 5341.46'  
C.S. 70-59  
1335.97'

RECEIVED  
JUL 27 2005  
WATER RESOURCES DEPT  
SALEM, OREGON

App No R 86386  
Permit No