

RECEIVED

MAR 10 2006

WATER RESOURCES DEPT
SALEM, OREGON

Application Map
In the name of Larry W. Martin
Section 31, T37S, R4W, W.M.
Jackson County, Oregon
Tax Lot No. 37 4W 31 - 800 & 801



Scale: 1" = 400'

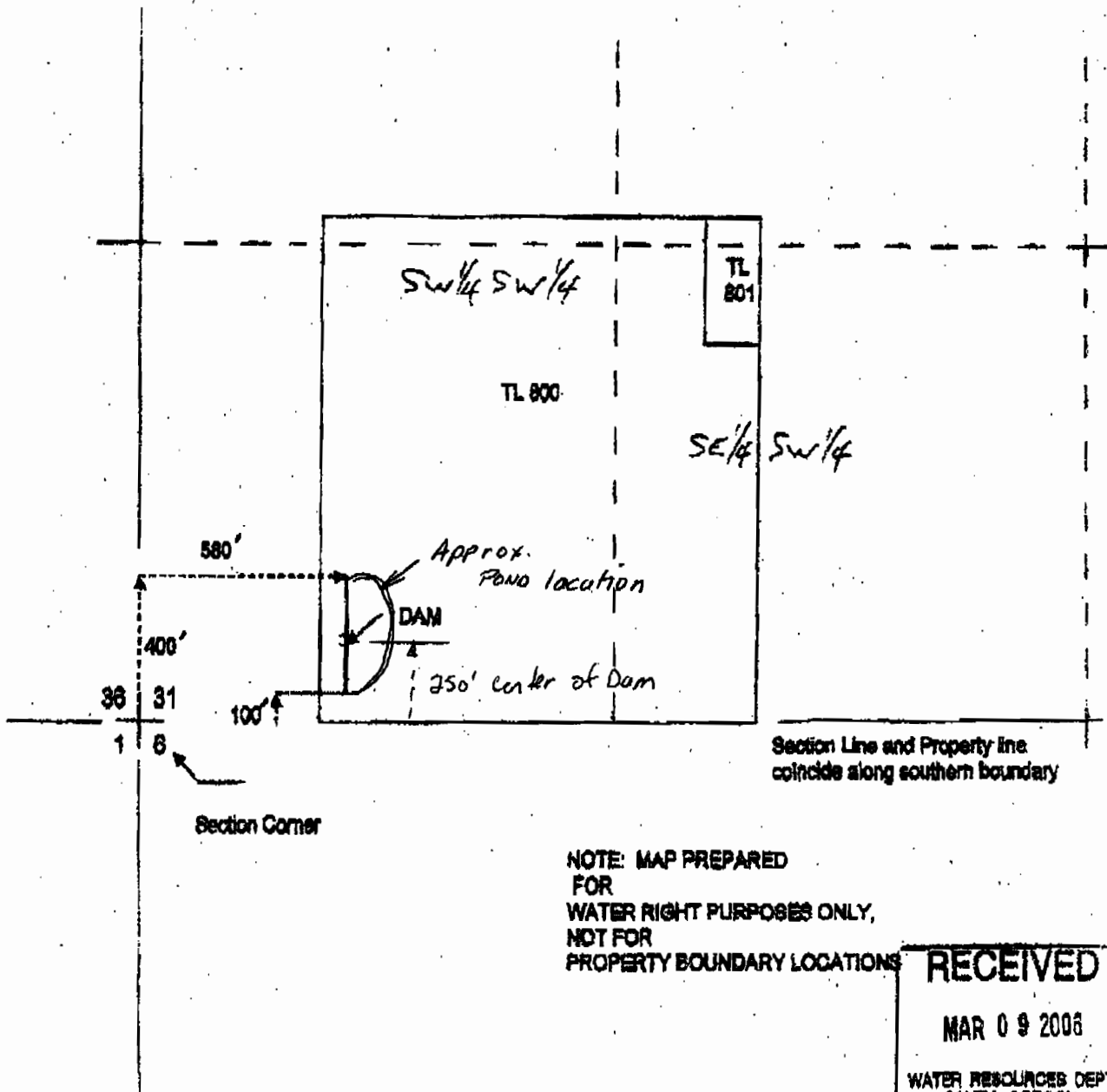

Section Corner

Section Line and Property line
coincide along southern boundary

NOTE: MAP PREPARED
FOR
WATER RIGHT PURPOSES ONLY,
NOT FOR
PROPERTY BOUNDARY LOCATIONS

RECEIVED

MAR 09 2006

WATER RESOURCES DEPT
SALEM, OREGON

R-86528