

SECTION 18, T. 39 S., R. 4 W., W. M.

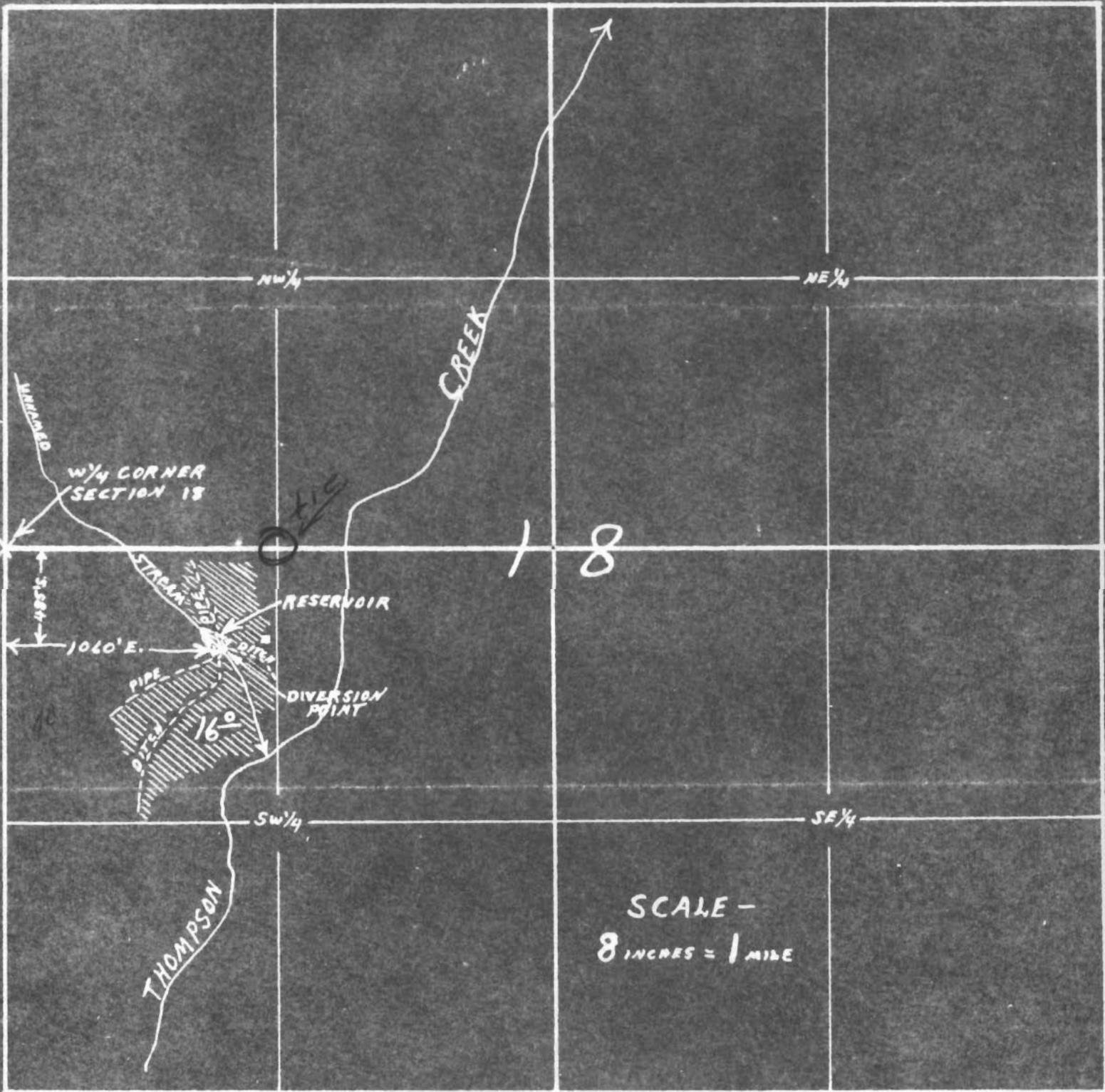

MAP TO ACCOMPANY APPLICATION OF ROSIE GIBSON FOR USE OF WATER FROM UNNAMED STREAM FOR IRRIGATION AND STORAGE PURPOSES.

Application No. R-27630-27631

Permit No. 21764, R1430

RECEIVED
SEP 9 1952

STATE ENGINEER
EAST OREGON

THIS OFFICE 9-7-52

David L. Hendrix, W.M.

R-27630-1