

T. 7S., R. 38E., W.M.

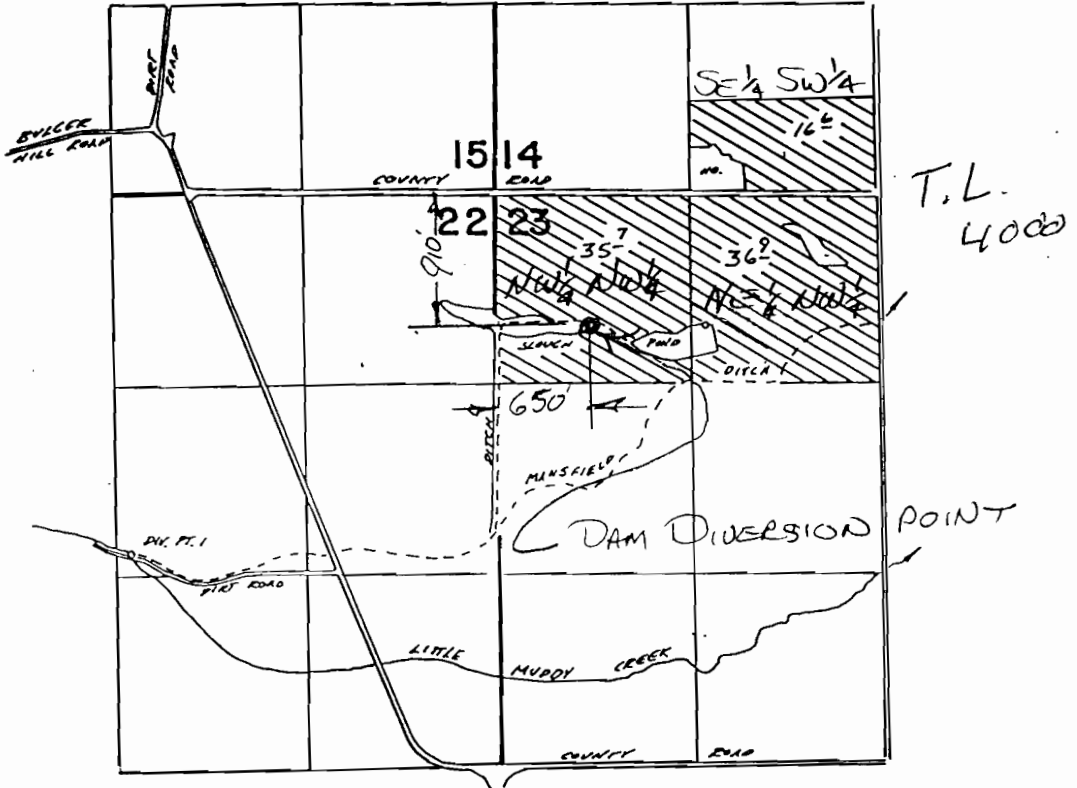

DIV. PT. 1 LOCATED 2470' S. & 2540' W. FROM NE COR. SEC 22

DIV. PT. 2 LOCATED 890' S. & 1400' E. FROM NW COR. SEC 23

SCALE: 4" = 1 MILE

APPLICATION MAP FOR STORAGE IN STEPHENS' FAMILY POND

RICHARD D. STEPHENS
14400 N. ROCK CR ROAD

HAINES, OR 97833

APRIL 4, 2006

RECEIVED
 APR 07 2006
 WATER RESOURCES DEPT.
 SALEM, OREGON

2712

APPNT R 86571