

# Section 27, Township 39 S. Range 8 W. W.M.

## Josephine County

### Alternate Review Reservoir Application for: Little Elm Ranch Corporation

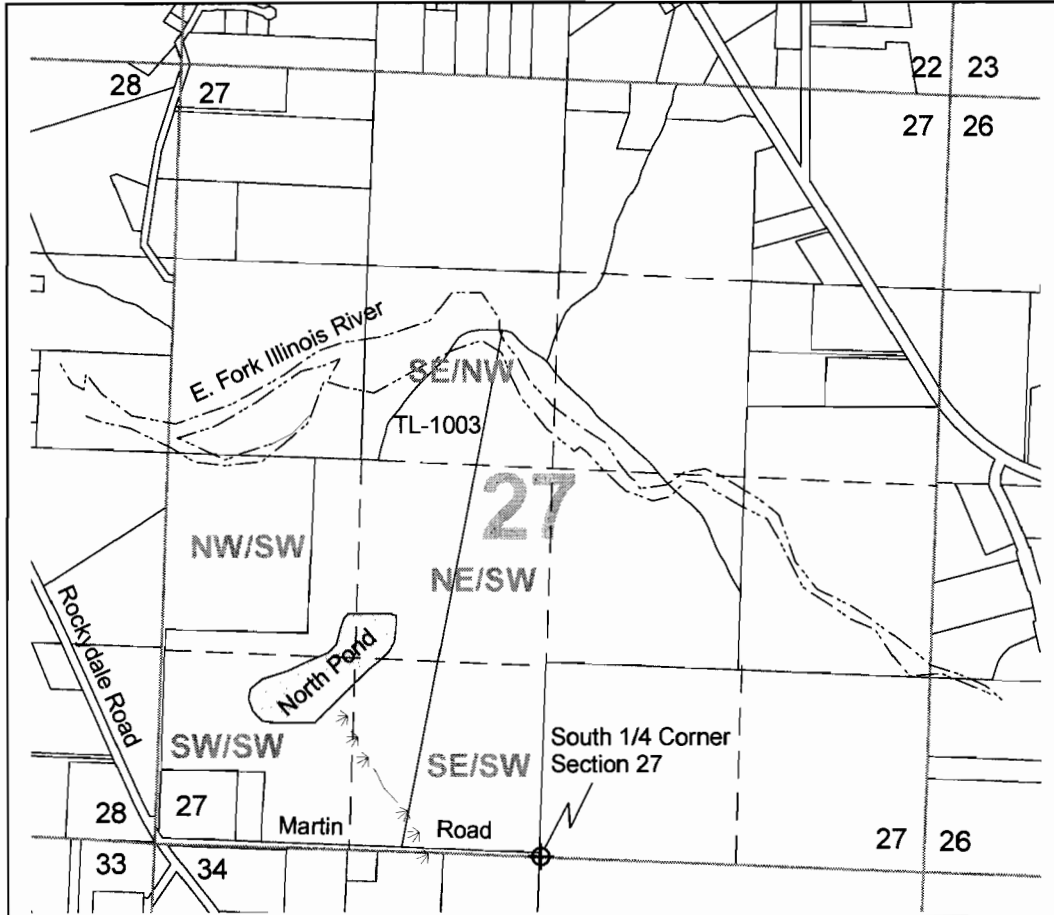

Reservoir Surface Area - 8.31 Acres  
Storage Capacity - 150 Acre Feet  
Reservoir will be filled from runoff and seepage  
No Channel  
Center of North Pond Reservoir is approximately  
1200 feet North & 1500 feet West from the  
South 1/4 Corner Section 27

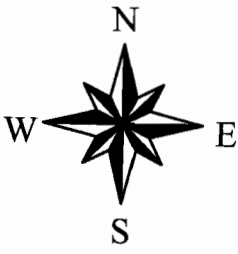

1 inch = 1320 feet

**RECEIVED**  
DEC 26 2006  
WATER RESOURCES DEPT  
SALEM, OREGON

12/11/2006

n.e.d.

app no R-86735