

Section 34 Township 39 S. Range 8 W. W.M. Josephine County

Alternate Review Reservoir Application for:
Little Elm Ranch Corporation

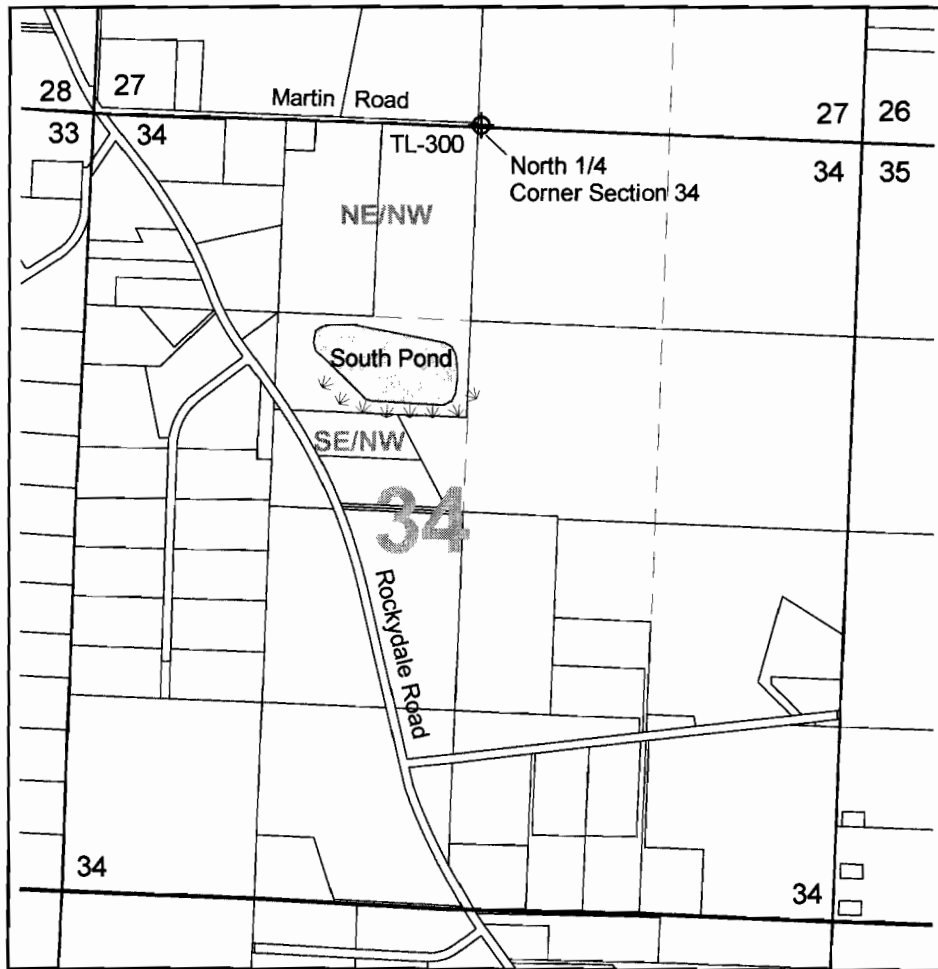

Reservoir Surface Area - 9.0 Acres

Storage Capacity - 160 Acre Feet

Center of South Pond Reservoir approximately
1670 feet south and 540 feet west from the
North 1/4 Corner Section 34

Reservoir will be filled from seepage and runoff
No channel

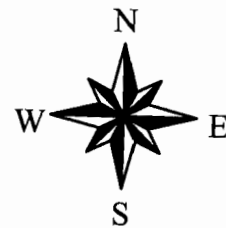

1 inch = 1320 feet

RECEIVED

12/10/2006

DEC 26 2006

n.e.d.

WATER RESOURCES DEPT
SALEM, OREGON

app no R-86734