

Application for a Permit to Store Water in a Reservoir

Application in the Name of: Hot Lake Springs Resort

Tax Lot 04S39E0500901 in Union County

Township 4 South, Range 39 East, Section 5 (W.M.)

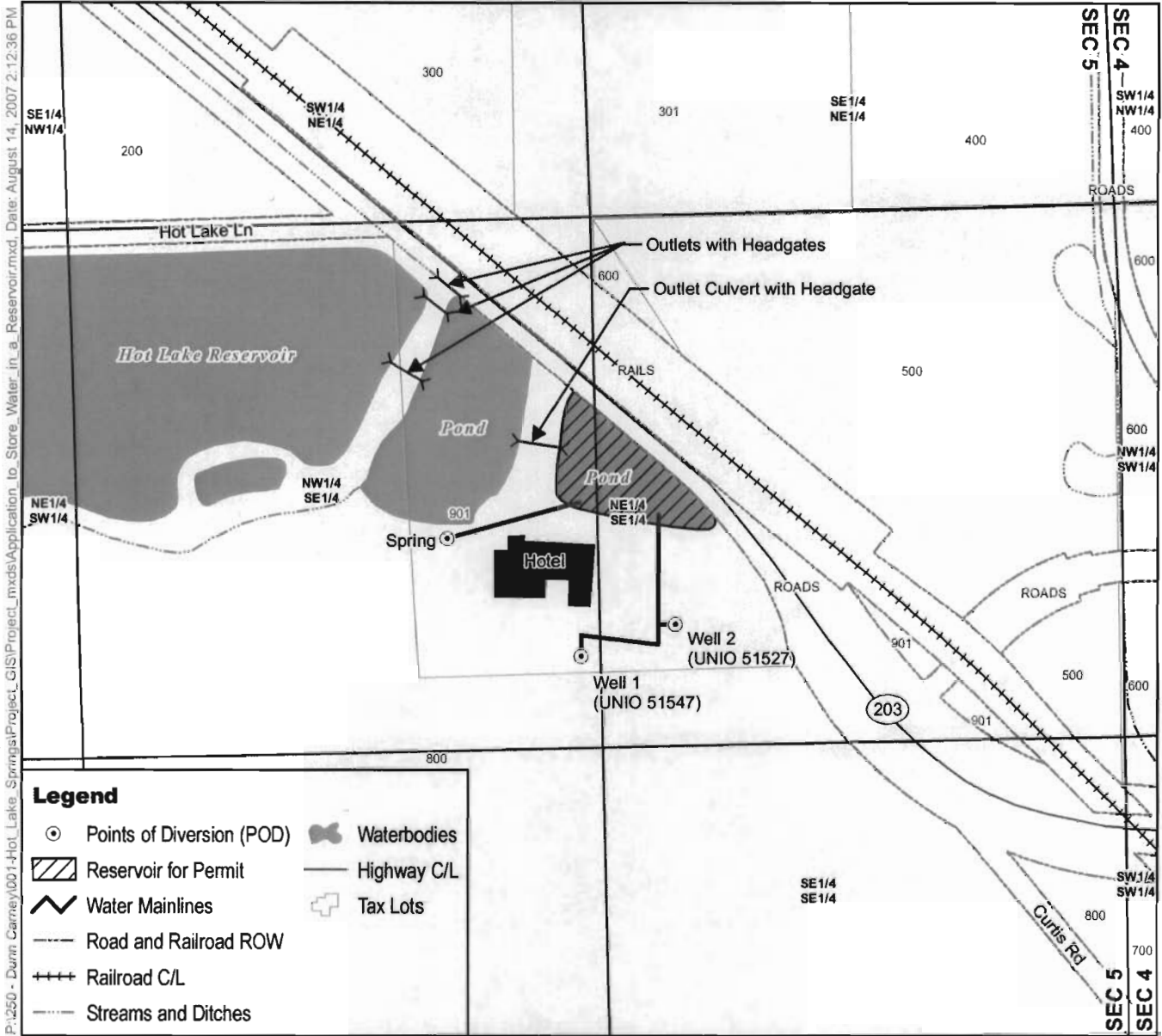

Legal Description

Center of Reservoir
 Located 630 feet South and 1420 feet East from the center of Section 5, Township 4 South, Range 39 East (W.M.)

Spring
 Located 810 feet South and 3550 feet East from the West quarter corner of Section 5, Township 4 South, Range 39 East (W.M.)

Well 1 (UNIO 51547)
 Located 235 feet North and 50 feet West from the center of the SE quarter of Section 5, Township 4 South, Range 39 East (W.M.)

Well 2 (UNIO 51527)
 Located 310 feet North and 195 feet East from the center of the SE quarter of Section 5, Township 4 South, Range 39 East (W.M.)



Scale

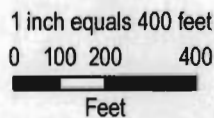

Map Information

Map Projection: Oregon State Plane North Zone
 Map Datum: North American Datum of 1983
 Map Date: August 8, 2007
 Prepared By: GSI Water Solutions, Inc.

Data Sources

Union County Planning Department, Oregon Water Resources Department (OWRD), Oregon Geospatial Enterprise Office (GEO)

Note

This map was prepared for the purpose of identifying the location of a water right only and it is not intended to provide legal dimensions or location of property ownership lines.

RECEIVED

SEP 13 2007

RECEIVED OVER THE COUNTER WATER RESOURCES DEPT SALEM, OREGON



Appno R 86969