

SEC.06 T9S R3W WM, MARION COUNTY

9 3W 0

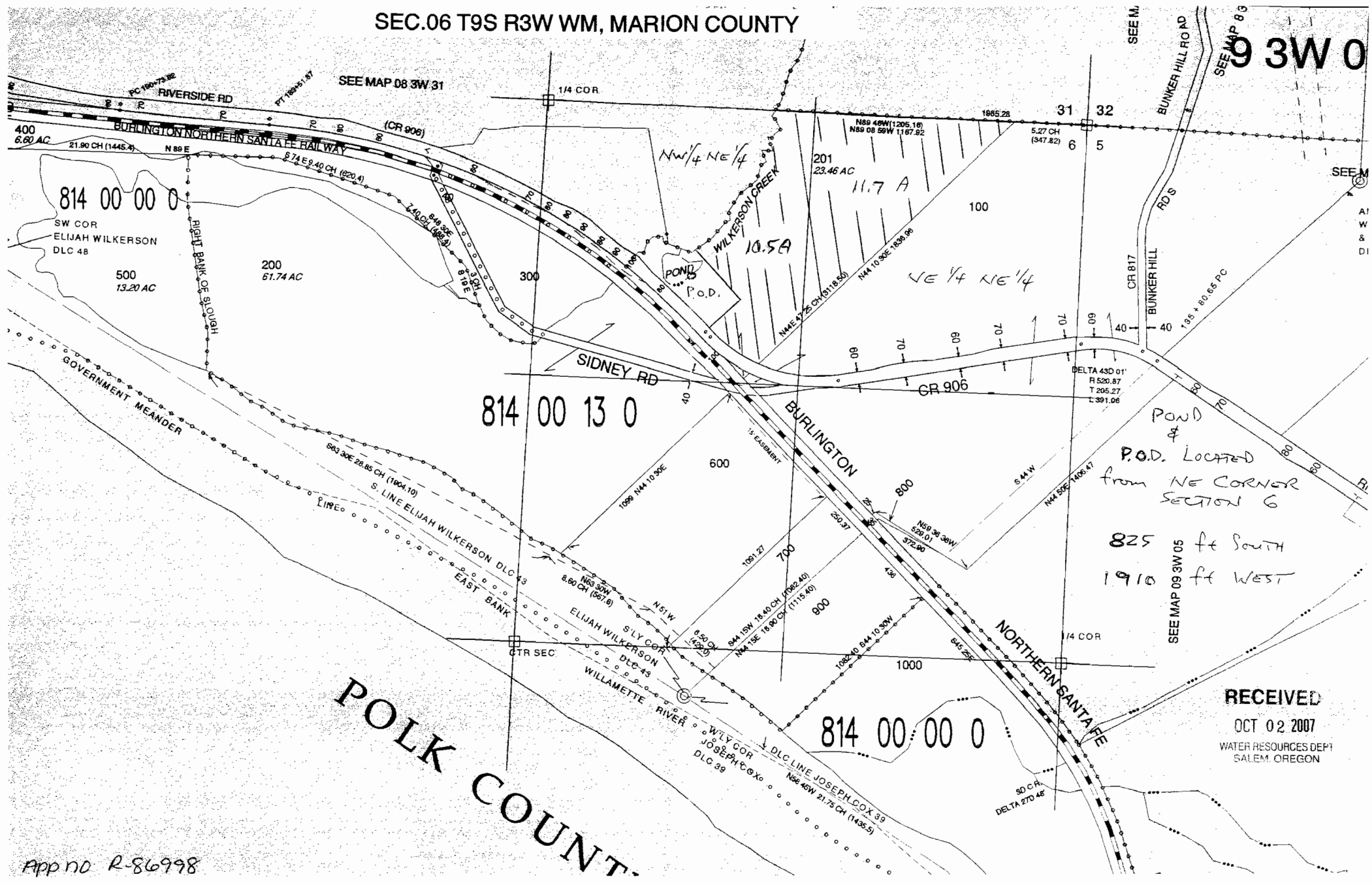

814 00 00 0

814 00 13 0

814 00 00 0

POLK COUNTY

POND & P.O.D. LOCATED from NE CORNER SECTION 6

825 ft SOUTH  
1910 ft WEST

RECEIVED  
OCT 02 2007  
WATER RESOURCES DEPT  
SALEM, OREGON

APP NO R-86998