

SEC. 6 T.26S. R.5 W. W.M.
DOUGLAS COUNTY
Scale: 1" = 1000'

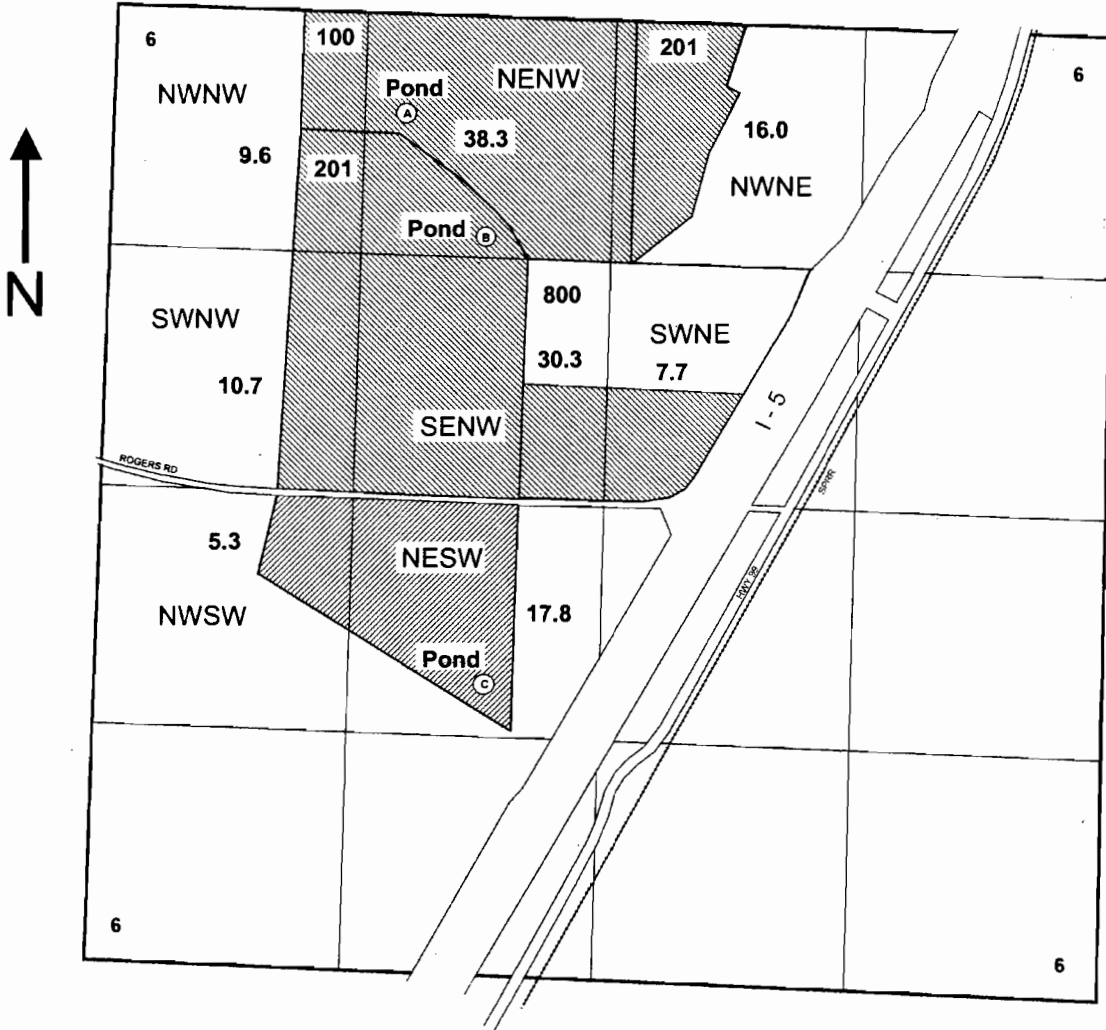

 = IRRIGATED FROM PONDS A AND B  = IRRIGATED FROM POND C

POND / POD A - Located 520 ft. S. and 1540 ft. E. }
 POND / POD B - Located 1150 ft. S. and 1950 ft. E. } from the NW corner of Sec. 6
 POND / POD C - Located 3450 ft. S. and 2020 ft. E. }

RECEIVED

MAR 26 2008

WATER RESOURCES DEPT
SALEM, OREGON

App No R 87134