

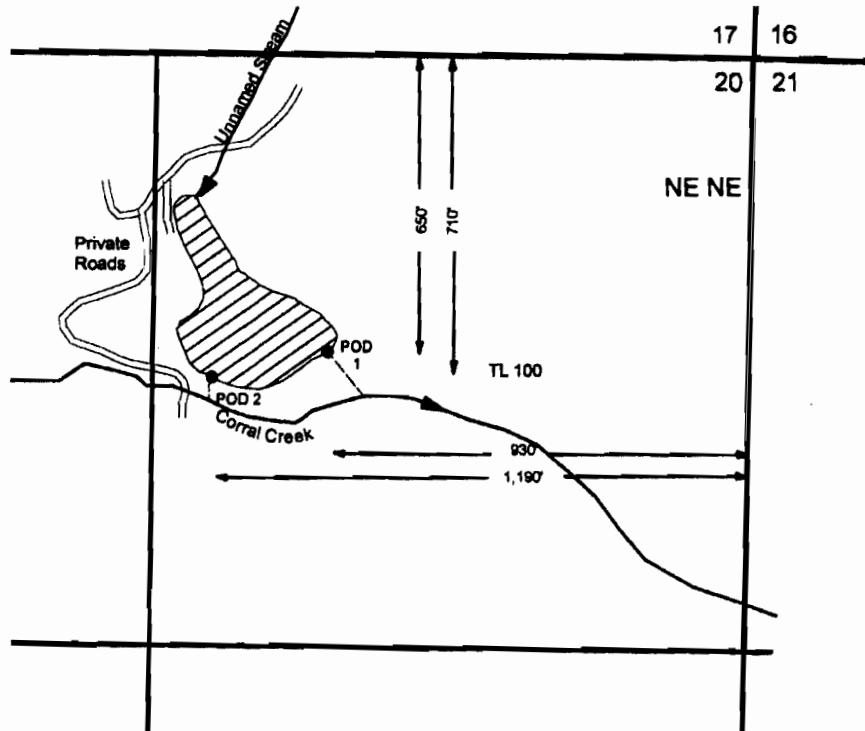

T3S, R1W, Section 20, WM Clackamas County Application Map



- Proposed Point of Diversion (POD)
for Reservoir
-  Proposed Reservoir

THIS MAP IS NOT INTENDED TO
PROVIDE LEGAL DIMENSIONS OR
LOCATIONS OF PROPERTY
OWNERSHIP LINES.

RECEIVED

JUN 23 2008 June 10, 2008

WATER RESOURCES DEPT
SALEM, OREGON **FIGURE 1**

