

# WATER RIGHTS APPLICATION MAP

T5S, R4W, WM  
 S 32, Taxlot 1200, & 1201  
 YAMHILL COUNTY, OREGON  
 WILLAMETTE RIVER BASIN

PREPARED FOR:  
 MCKEE FARMS  
 22450 SW MCKEE RD  
 AMITY, OR 97101



IRRIGATION ACREAGE		
SEC. 31	SE NE	18.1 AC
	NE SE	5.4 AC
	TOTAL - 23.5 AC	
SEC. 32	SW NW	30.5 AC
	SE NW	21.6 AC
	NE NW	0.6 AC
	NW SW	16.6 AC
	NE SW	17.2 AC
TOTAL - 86.5 AC		
TOTAL IRRIGATED AC 110.0		

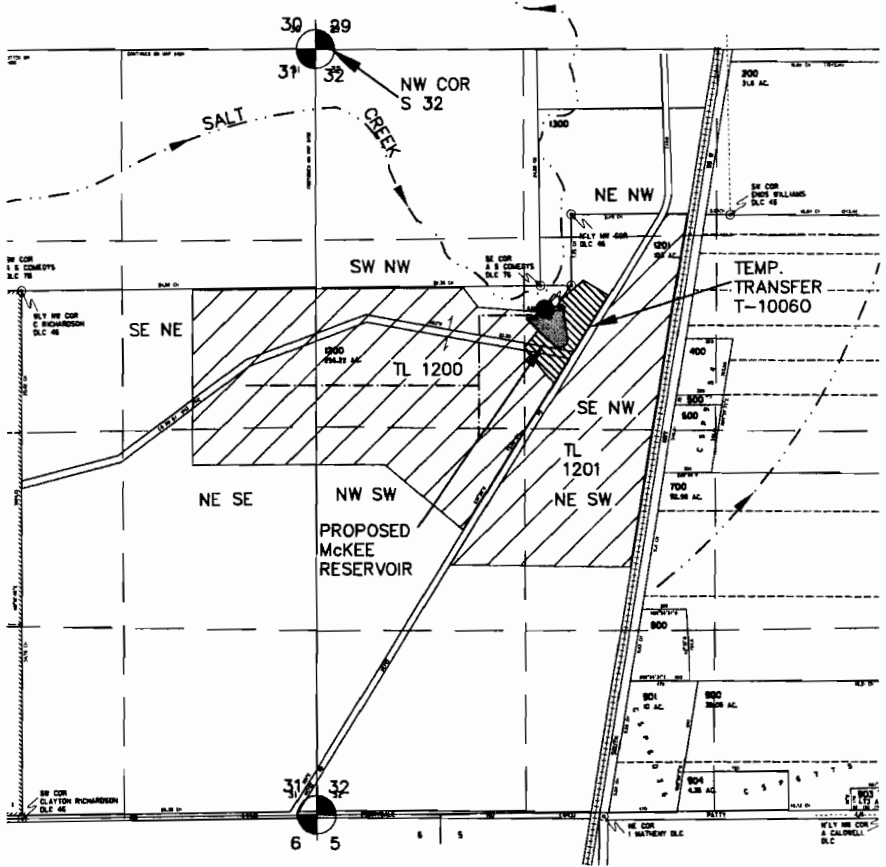

- Irrigation Area for Temporary Transfer T-10060
- Potential Irrigation Area
- Point of Diversion is 1570 ft east and 1000 ft South of NW corner of Section 32.
- Proposed main irrigation pipe (approx. location—system not designed)

**RECEIVED**

APR 24 2008

WATER RESOURCES DEPT  
 SALEM OREGON



THIS MAP WAS PREPARED FOR THE PURPOSE OF IDENTIFYING THE LOCATION OF A WATER RIGHT ONLY AND IS NOT INTENDED TO PROVIDE LEGAL DIMENSIONS OR LOCATION OF PROPERTY OWNERSHIP LINES.



MAP BASE:  
 ASSESSOR MAP 5S 4 32,  
 & 5S 4 31  
 2006 AERIAL PHOTO



Project: 305-2-135  
 Drawing: 3052135BMckee WR.dwg  
 By: CVB/BK  
 Checked by: EAU  
 Date: 4-11-08

App No R 87158